

SITE PLAN GENERAL NOTES:

- A. Contractor shall remove all existing vegetation, site improvements, etc. whether or not specifically indicated on the drawings to facilitate the completion of all required new work. Contractor shall visit the site and verify all quantities and items that are required to be removed prior to submittal of his proposal.
- B. Slope all grades and pavement away from building(s) to provide positive drainage, unless noted otherwise.
- C. Finish grade at sidewalks, buildings, etc., as required to provide smooth transition to grade.
- D. Angles indicated are 45 degrees unless noted otherwise.
- E. Construction debris shall be removed from the site on a continuing basis for the duration of construction.
- F. Concrete walks shall have expansion joints at a maximum spacing of 20 feet OC and control joints at 5 feet OC, unless otherwise noted.
- G. Perform all clearing, grubbing and earthwork in accordance with the Geotechnical report, unless more restrictive requirements exist.
- H. Should slopes of greater than 1:20 (5%) occur at pavement locations, notify architect immediately.
- I. All proposed impaction fill material shall be tested by a qualified testing agency to verify that it meets all specification requirements, prior to placing on site.
- J. Dimensions are to outside face of stem walls/foundations unless noted otherwise.
- K. All areas disturbed by construction, staging, etc. shall be restored to their original condition by the General Contractor. General Contractor is responsible for documenting original condition.
- L. All sidewalks at building entryways shall be "keyed" into building slab to prevent differential movement.
- M. Fire lanes to support 88,000 pounds per City of Scottsdale Design Standards and Policies Manual, Section 2-1.802(3).

SITE PLAN KEYNOTES:

- 1. 6'-0" tall ornamental iron regal style picket fence to match existing.
- 2. Ornamental iron picket man gate with perforated metal panel. See gate schedule and details. Extend perforated metal panel to 2'-0" on either side of gate, typical UNC.
- 3. See enlarged playground plan for extents of post tensioned slab at basketball court. See civil drawings.
- 4. 6'-0" tall swinging manual ornamental iron gate with fire department knock box. See gate schedule and details.
- 5. 6'-0" tall chain link fence to match existing.
- 6. 6'-0" tall swinging manual chain link gate to match existing. See gate schedule and details.
- 7. Fire truck turning radius shown thus.
- 8. Stripe asphalt to indicate loading zone/pedestrian crossing.
- 9. New basketball hoop location. See specifications.
- 10. CIP concrete steps with stainless steel pipe handrail both sides per detail 10/AS-103.
- 11. Temporary fence to be removed in subsequent phase.
- 12. 4'-0" tall ornamental iron heavy regal style fence to match existing.
- 13. Existing chainlink fence.
- 14. Gas meter to be located as close to building inside corner as possible. Coordinate with plumbing plans.
- 15. Play structures, canopy and surface by separate permit.
- 16. Provide new building signage to existing buildings to match new buildings. Provide one sign visible toward public/fire lane side and one visible toward campus side.
- 17. Paint white stripe to designate lanes.
- 18. Provide signage and markings per AHJ (City of Scottsdale Ordinance No. 4283, Section 503.3) at all fire lanes.
- 19. Location of existing fire riser room.
- 20. Location of existing FDC.
- 21. Place signage at existing site wall that reads: "Do not cross parking lot. Access to office through sidewalk located south".
- 22. Pedestrian circulation in this area to be reviewed by Fire Department after south drop-off lane is constructed and functioning.

SITE PLAN LEGEND

- ROOM FINISH CONCRETE
- ROOM FINISH CONCRETE FIRE LANE OVER 8' ABC TYPE W CONTROL/EXPANSION JOINTS.
- ASPHALT CONCRETE PAVING
- PAINTED DIRECTIONAL ARROW ON PAVING.
- PAINTED CURB AND FIRE SIGNAGE PER AHJ (CITY OF SCOTTSDALE ORDINANCE NO. 4283, SECTION 503.3)
- ACCESSIBLE ROUTE TO R.O.W.
- IMAGINARY PROPERTY LINE
- FIRE DEPARTMENT CONNECTION PER AHJ (CITY OF SCOTTSDALE ORDINANCE 4283, SECTION 512)

Scottsdale Unified School District No. 48
SUSD Cheyenne
Traditional School
Gym and Labs Addition
 13636 N 100th St, Scottsdale, Arizona 85260

CLIENT CONTACT
 Dennis J. Roehler 480.484.8503 t
 9288 E. San Salvador Dr. 480.415.8564 m
 Scottsdale, Arizona cdroehler@susd.org
 85258

PROJECT NO.	DATE OF ISSUE
2017_037	07.14.2017
REVISION NO.	DATE
1 quality assurance	08.01.17
2 city comments	08.18.17

PROJECT TEAM **DRAWN BY**
 ed to sb tg al

PROJECT PHASE
 permit set

SHEET CONTENTS
 site plan north

SHEET NO.
 AS-105

2929 n central ave
 eleventh floor
 phoenix az 85012
 bala.o@owp.com
 602.257.1764 t
 602.257.9029 f
 www.owp.com

SITE PLAN NORTH

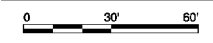

Orcutt Winslow Project 2017_037 SUSD Cheyenne Traditional School Renovations, 100 Site Plans PHB2 Sheet AS-106 site plan south was plotted by Felima Garcia on Tuesday, September 12, 2017 at 5:05 PM. File found at BM Server: edbmsrver - BM Server 2\Education Studio\16_364 SUSD Cheyenne Additions Renovations

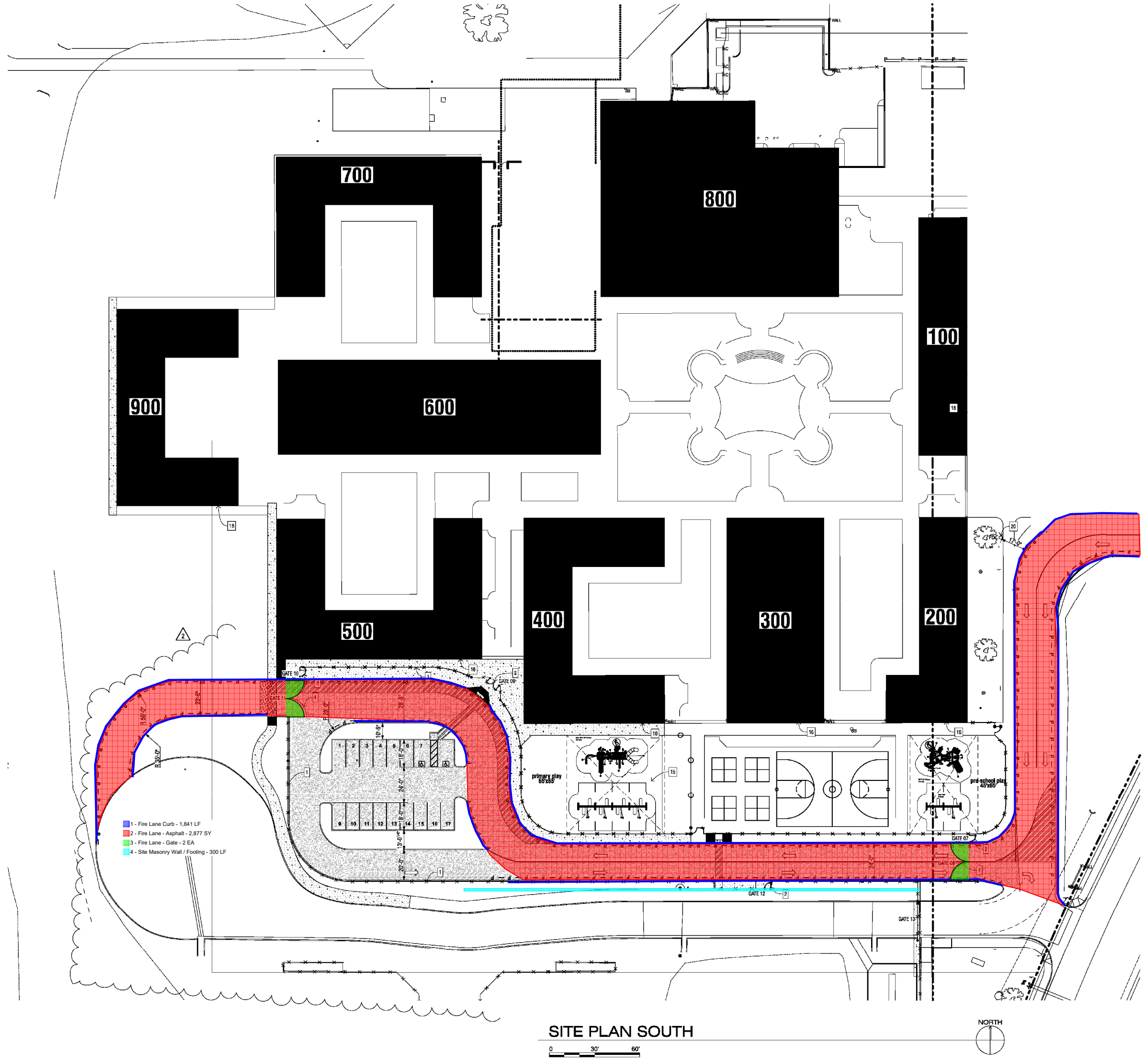

SITE PLAN SOUTH

0 30' 60'

SITE PLAN GENERAL NOTES:

- A. Contractor shall remove all existing vegetation, site improvements, etc. whether or not specifically indicated on the drawings to facilitate the completion of all required new work. Contractor shall visit the site and verify all quantities and items that are required to be removed prior to submittal of his proposal.
- B. Slope all grades and pavement away from building(s) to provide positive drainage, unless noted otherwise.
- C. Finish grade at sidewalks, buildings, etc., as required to provide smooth transition to grade.
- D. Angles indicated are 45 degrees unless noted otherwise.
- E. Construction debris shall be removed from the site on a continuing basis for the duration of construction.
- F. Concrete walks shall have expansion joints at a maximum spacing of 20 feet OC and control joints at 5 feet OC, unless otherwise noted.
- G. Perform all clearing, grubbing and earthwork in accordance with the Geotechnical report, unless more restrictive requirements exist.
- H. Should slopes of greater than 1:20 (5%) occur at pavement locations, notify architect immediately.
- I. All proposed imported fill material shall be tested by a qualified testing agency to verify that it meets all specification requirements, prior to placing on site.
- J. Dimensions are to outside face of stem walls/foundations unless noted otherwise.
- K. All areas disturbed by construction, staging, etc. shall be restored to their original condition by the General Contractor. General Contractor is responsible for documenting original condition.
- L. All sidewalks at building entryways shall be "keyed" into building slab to prevent differential movement.
- M. Fire lanes to support 83,000 pounds per City of Scottsdale Design Standards and Policies Manual, Section 2-1.802(3).

SITE PLAN KEYNOTES:

1. 6'-0" tall ornamental iron regal style picket fence to match existing.
2. Ornamental iron picket man gate with perforated metal panel. See gate schedule and details. Extend perforated metal panel to 2'-0" on either side of gate, typical UNO.
3. See enlarged playground plan for extents of post tensioned slab at basketball court. See civil drawings.
4. 6'-0" tall swinging manual ornamental iron gate with fire department knock box. See gate schedule and details.
5. 6'-0" tall chain link fence to match existing.
6. 6'-0" tall swinging manual chain link gate to match existing. See gate schedule and details.
7. Fire truck turning radius shown thus.
8. Stripe asphalt to indicate loading zone/pedestrian crossing.
9. New basketball hoop location. See specifications.
10. CIP concrete steps with stainless steel pipe handrail both sides per detail 10/AS-103.
11. Temporary fence to be removed in subsequent phase.
12. 4'-0" tall ornamental iron heavy regal style fence to match existing.
13. Existing chainlink fence.
14. Gas meter to be located as close to building inside corner as possible. Coordinate with plumbing plans.
15. Play structures, canopy and surface by separate permit.
16. Provide new building signage to existing buildings to match new buildings. Provide one sign visible toward public/fire lane side and one visible toward campus side.
17. Paint white stripe to designate lanes.
18. Provide signage and markings per AHJ (City of Scottsdale Ordinance No. 4283, Section 503.3) at all fire lanes.
19. Location of existing fire riser room.
20. Location of existing FDC.
21. Place signage at existing site wall that reads: "Do not cross parking lot. Access to office through sidewalk located south".
22. Pedestrian circulation in this area to be reviewed by Fire Department after south drop-off lane is constructed and functioning.

SITE PLAN LEGEND

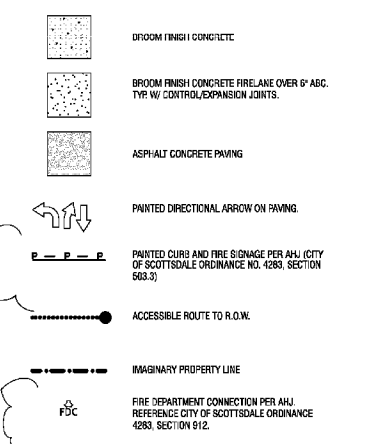

orcutt winslow

2929 n central ave
 eleventh floor
 phoenix az 85012
 bala.s@owp.com

602.257.1764 t
 602.257.9029 f

www.owp.com

THOMAS O'NEIL
 REGISTERED PROFESSIONAL ARCHITECT
 NO. 24232
 STATE OF ARIZONA
 expires 12/31/2018

© 2017 All other uses or electronic copies to be retained of services and the property of the Client. This drawing is the property of the Client. The Client shall be responsible for the accuracy of the information provided. The Client shall be responsible for the accuracy of the information provided. The Client shall be responsible for the accuracy of the information provided. The Client shall be responsible for the accuracy of the information provided.

Scottsdale Unified School District No. 48
SUSD Cheyenne
Traditional School
Gym and Labs Addition
 13636 N 100th St, Scottsdale, Arizona 85260

CLIENT CONTACT

Dennis J. Roehler 480.484.8503
 9288 E. San Salvador Dr. 480.415.8564
 Scottsdale, Arizona 85258
 droehler@susd.org

PROJECT NO. 2017_037
DATE OF ISSUE 07.14.2017

REVISION NO.
 city comments 08.18.17

PROJECT TEAM ed
DRAWN BY to sb tg al

PROJECT PHASE permit set

SHEET CONTENTS site plan south

SHEET NO. AS-106