

PAVEMENT REMOVAL AND REPLACEMENT

FOR

ECHO MOUNTAIN INTERMEDIATE SCHOOL

1871 E. MICHIGAN AVE. SUITE 6
PHOENIX, AZ 85022

FOR

PARADISE VALLEY UNIFIED SCHOOL DISTRICT

15002 N. 32ND STREET
PHOENIX, AZ 85032
PHONE: (602) 449-2000

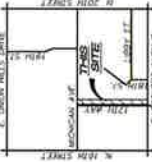

VICINITY MAP
NOT TO SCALE

GRADING AND DRAINAGE CONSTRUCTION NOTES:

1. REMOVE EXISTING ASPHALT AND CONCRETE EXCESS MATERIALS TO PREPARE SUBGRADE CONDITION. COMPACT EXISTING A.B.C. THE A.B.C. SHALL BE PROOF ROLLED TO VERIFY COMPACTION PRIOR TO PAVING. ONCE THE A.B.C. IS PROOF ROLLED, THE CONTRACTOR SHALL PLACE ASPHALTIC CONCRETE (TYPE 3/4.5), RESTRICTION TO MATCH EXISTING STRING.
2. PROTECT EXISTING CURBING.

LEGEND

- 1" = 30' (1) EXISTING ASPHALT
- 1" = 30' (2) EXISTING CONCRETE
- 1" = 30' (3) EXISTING CURB ELEVATION
- 1" = 30' (4) EXISTING OUTLET ELEVATION
- 1" = 30' (5) EXISTING PAVEMENT ELEVATION
- 1" = 30' (6) EXISTING CONCRETE ELEVATION
- 1" = 30' (7) EXISTING SIDEWALK ELEVATION
- 1" = 30' (8) EXISTING GROUND ELEVATION
- 1" = 30' (9) EXISTING SOA
- 1" = 30' (10) EXISTING POST
- 1" = 30' (11) EXISTING GATED INLET
- 1" = 30' (12) EXISTING SANITARY SEWER MANHOLE
- 1" = 30' (13) EXISTING WEL
- 1" = 30' (14) EXISTING WEL

PAVEMENT REMOVAL AND REPLACEMENT
(3-497 SY)

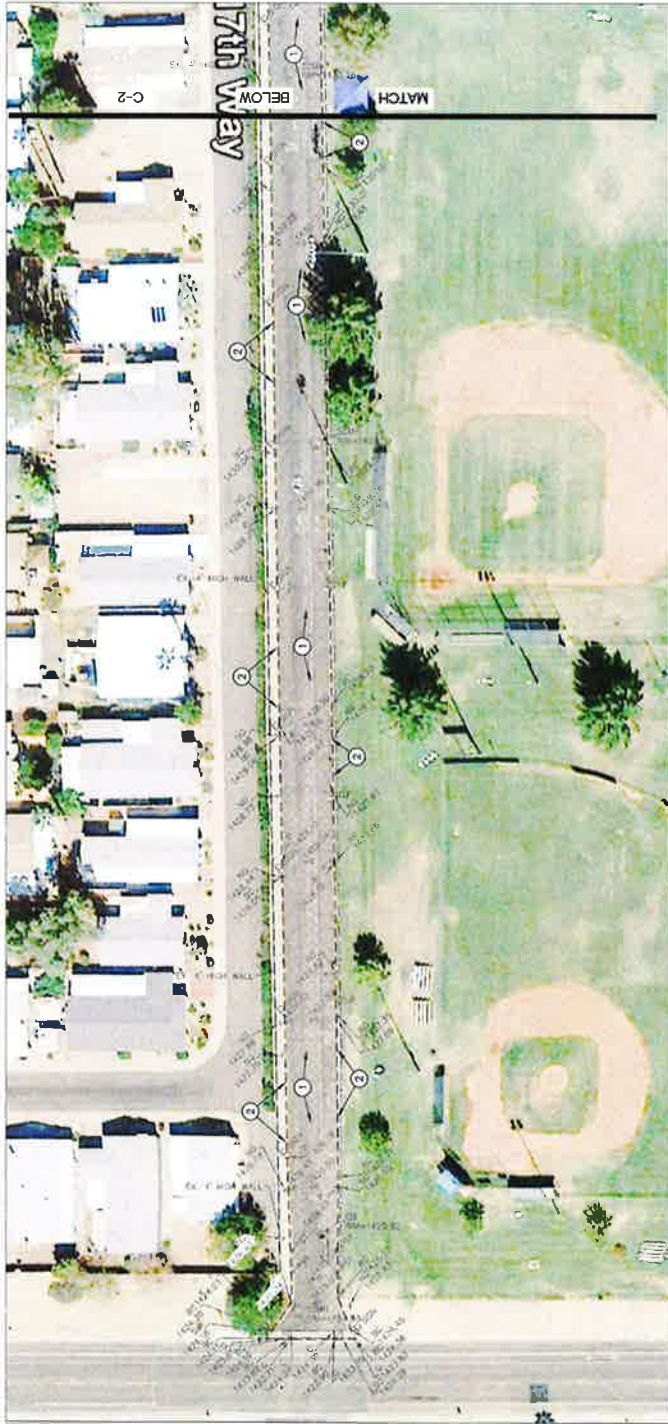

HESS - ROUNTREE, INC.
CONSULTING ENGINEERS & LAND SURVEYORS
PHOENIX, ARIZONA 85044
PHONE: (602) 449-2000

DATE: 01-20-24
DRAWN: JCM
CHECKED: DRO
JOB NO: 1711-15

DESIGN CIVIL ENGINEERS NOTES TO CONTRACTOR

1. NOTHING CONTAINED IN THE CONTRACT DOCUMENTS SHALL BE CONSIDERED TO CREATE, ALTER, AMEND, OR SUPPLEMENT THE CONTRACT. THE CONTRACTOR OR ANY SUBCONTRACTOR, ENGINEER AND THE CONTRACTOR OR ANY SUBCONTRACTOR, DESIGN CIVIL ENGINEER WILL NOT BE RESPONSIBLE FOR CONSTRUCTION MEANS, METHODS, TECHNIQUES, SEQUENCES OR PROCEDURES OR FOR SAFETY PRECAUTIONS OR PROGRAMS UNLESS THEY ARE SPECIFICALLY MENTIONED IN THE CONTRACT DOCUMENTS. THE CONTRACTOR SHALL BE RESPONSIBLE FOR THE CONTRACTOR'S FAILURE TO CARRY OUT THE WORK IN ACCORDANCE WITH THE CONTRACT DOCUMENTS.
2. THE CONTRACTOR SHALL PROVIDE ADEQUATE MEANS OF CLEANING, TRUCKS AND/OR OTHER EQUIPMENT OF MUD PRIOR TO EXCAVATION. THE CONTRACTOR SHALL BE RESPONSIBLE FOR THE RESPONSIBILITY TO CLEAN STREETS, ALLY DUST, AND TO TAKE WHATEVER MEASURES ARE NECESSARY TO INSURE THAT ALL ROADWAYS AND ON SITE PARKING LOTS/PURVE LINES ARE KEPT OPEN IN A CLEAN, MUD AND DUST-FREE CONDITION AT ALL TIMES.
3. IT SHALL BE THE CONTRACTOR'S RESPONSIBILITY TO CONTACT THE BLUE STAKE CENTER TWO WORKING DAYS PRIOR TO ANY EXCAVATION OF THE UNDERGROUND UTILITY LOCATIONS AS SHOWN HEREON ARE BASED ON THE BEST INFORMATION AVAILABLE TO THE DESIGN CIVIL ENGINEER. THERE MAY BE OTHER UNDERGROUND UTILITY LINES, SERVICE LINES AND STRUCTURES PRESENT IN THE PROJECT AREA. THE CONTRACTOR SHALL BE RESPONSIBLE FOR THE PURPOSE OF LOCATING ALL UNDERGROUND UTILITIES. THE CONTRACTOR SHALL BE RESPONSIBLE FOR THE DESIGN AND CONSTRUCTION OF UNDERGROUND UTILITY LINES. UTILITIES ARE TO BE ABANDONED OR PROTECTED FROM DAMAGE.
4. THE DESIGN CIVIL ENGINEER MAKES NO REPRESENTATION OR GUARANTEE REGARDING THE EARTHWORK QUANTITIES OR THAT THE EARTHWORK FOR THIS PROJECT WILL BALANCE DUE TO THE LIMITED INFORMATION AVAILABLE TO THE CONTRACTOR. THE CONTRACTOR SHALL BE RESPONSIBLE FOR VERIFYING CONSTRUCTION TOLERANCES AND CONSTRUCTION METHODS. PRIOR TO BIDDING THE WORK, THE CONTRACTOR SHALL VERIFY THE EARTHWORK QUANTITIES AND REQUIREMENTS OF THE WORK AND EXPRESS OR DEFICIENCY THEREIN, ACTUAL OR RELATIVE.
5. THE CONTRACTOR SHALL ABANDON ALL EXISTING AND NEW CLEANOUTS, WATER VALVE BOXES, MANHOLES, GAS VALVE BOXES, IRRIGATION BOXES, ETC. IN THE CONSTRUCTION AREA TO BE EXCAVATED. ALL EXISTING AND NEW CONCRETE PAVEMENT AREAS SHALL BE ISOLATED FROM THE CONCRETE PAVEMENT WITH EXPANSION JOINTS.
6. ALL NEW UNDERGROUND FACILITIES UTILITIES SHALL BE INSTALLED WITH A DETECTABLE UNDERGROUND LOCATION DEVICE TO EACH UTILITY AT 4'-FEET ON CENTER. 1/2" OF TRACER WIRE SHALL BE ACCESSIBLE ABOVE GRADE AT THE TERMINATION AND THE CONTRACTOR SHALL INCLUDE ALL COSTS ASSOCIATED WITH THIS REQUIREMENT IN THEIR BID.
7. THE CONTRACTOR SHALL MAKE NO CLAIMS AGAINST THE OWNER OR THE DESIGN CIVIL ENGINEER REGARDING ALLEGED INACCURACY OF CONSTRUCTION STAKES SET BY THE DESIGN CIVIL ENGINEER. THE CONTRACTOR SHALL BE RESPONSIBLE FOR VERIFYING THE ACCURACY OF THE STAKES. THE DESIGN CIVIL ENGINEER ARE MAINTAINED INTACT AND CANNOT BE VERIFIED AS TO THEIR ORIGIN. ANY REMEDIAL WORK REQUIRED TO CORRECT ANY ITEM OF IMPROPER CONSTRUCTION SHALL BE THE SOLE RESPONSIBILITY OF THE CONTRACTOR AT THE SOLE EXPENSE OF THE RESPONSIBLE CONTRACTOR OR SUBCONTRACTOR.
8. THE CONTRACTOR SHALL MAKE NO CLAIMS AGAINST THE OWNER OR THE DESIGN CIVIL ENGINEER REGARDING ALLEGED INACCURACY OF CONSTRUCTION STAKES SET BY THE DESIGN CIVIL ENGINEER. THE CONTRACTOR SHALL BE RESPONSIBLE FOR VERIFYING THE ACCURACY OF THE STAKES. THE DESIGN CIVIL ENGINEER ARE MAINTAINED INTACT AND CANNOT BE VERIFIED AS TO THEIR ORIGIN. ANY REMEDIAL WORK REQUIRED TO CORRECT ANY ITEM OF IMPROPER CONSTRUCTION SHALL BE THE SOLE RESPONSIBILITY OF THE CONTRACTOR AT THE SOLE EXPENSE OF THE RESPONSIBLE CONTRACTOR OR SUBCONTRACTOR.
9. ALL NEW PRIVATE UNDERGROUND UTILITIES (WATER LINES 3" AND LARGER, SEWER LINES, FIRE LINES AND STORM DRAIN LINES) SHALL BE BEDDED WITH A.B.C. PER MAG SECTION 702. FROM THE TOP OF THE BEDDING TO THE TOP OF THE PIPE TO 12" (MIN.) ABOVE THE TOP OF THE PIPE.

PARADISE VALLEY UNIFIED SCHOOL DISTRICT	
PAVEMENT REMOVAL AND REPLACEMENT FOR ECHO MOUNTAIN INTERMEDIATE SCHOOL	
DRAWING STATUS	SHEET OF
1	2
DATE: 01-20-24	C-1

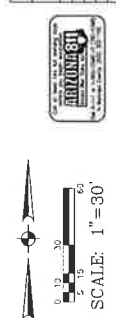



Hess - Rountree, Inc.
 CONSULTING ENGINEERS & LAND SURVEYORS
 1001 N. CENTRAL AVENUE, SUITE 200
 PHOENIX, ARIZONA 85004 (480) 468-1244

DES. DRO DRN JCM CDD DRO JOB NO 1771-15

GRADING AND DRAINAGE CONSTRUCTION NOTES:

- 1 PAVERIZE EXISTING ASPHALT AND HAUL OFF EXCESS ASPHALT. EXISTING ASPHALT SHALL BE PROOF ROLLED TO VERIFY COMPACTION PRIOR TO PAVING. ONCE PAVING IS COMPLETE, APPLY 1/2" THICK ASPHALTIC CONCRETE (TYPE 3/4"). RESTRIPE TO MATCH EXISTING STRIPINGS.
- 2 PROTECT EXISTING CURBING.

LEGEND

- 143.176 EXISTING BACK OF CURB ELEVATION
- 143.150 EXISTING GUTTER ELEVATION
- 143.39 EXISTING PAVEMENT ELEVATION
- 144.26 EXISTING CONCRETE ELEVATION
- 143.377 EXISTING SIDEWALK ELEVATION
- 143.377 EXISTING GROUND ELEVATION
- S/A EXISTING SIGN
- + P+7 EXISTING POST
- 143.112 EXISTING CATCH BASIN
- 143.377 EXISTING SANITARY SEWER MANHOLE
- 143.177 EXISTING TREE
- PAVEMENT REMOVAL AND REPLACEMENT (3,497 SY)

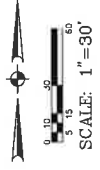

PARADISE VALLEY UNIFIED SCHOOL DISTRICT	
PAVING AND CURBING FOR	
MONTGOMERY MIDDLE SCHOOL	
DRAWING STATUS	SHEET
OF	2
DATE	8-29-17
C-2	