

wickenburg unified school district #9

Wickenburg USD Bond Projects

Vulture Peak Middle School

Paving Project

920 South Vulture Mine Road, Wickenburg, Arizona 85390

CONSULTANT INFO

CIVIL ENGINEER
ATHERTON ENGINEERING, INC.
1203 E. Meadowbrook Avenue
Phoenix, Arizona 85014
t 602-279-7331 f 602-230-1908

VICINITY MAP

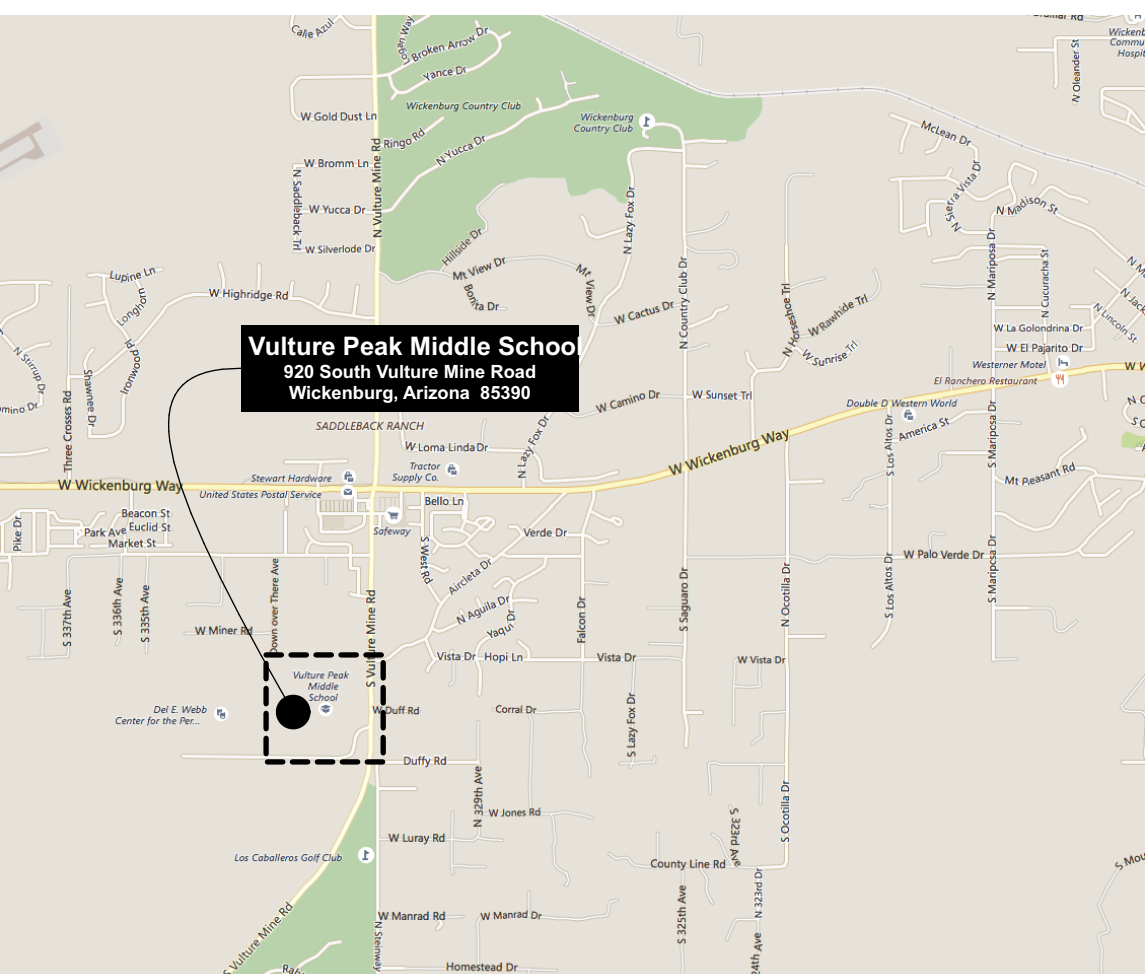

VICINITY MAP

NOT TO SCALE



SHEET INDEX

architectural
G-001 title sheet - V.P.M.S. paving

civil
C1.0 cover sheet
C1.1 paving plan
C1.2 paving plan
C1.3 paving plan
C1.4 paving plan

orcutt | winslow

3003 n central ave
sixteenth floor
phoenix, az 85012
mail@owp.com

602.257.1764 f
602.257.9029 f
www.owp.com



© 2018 this hard copy or electronic drawing is an instrument of service and the property of the Client/Owner. It is to be used only for the project and purpose for which it was prepared and no part of it may be reproduced, stored in a retrieval system, or transmitted in any form or by any means, electronic, mechanical, photocopying, recording, or by any information storage and retrieval system, without the prior written permission of the design professional. The design professional shall not be responsible for any alterations, modifications, or additions made to this drawing by any party other than the design professional. Use of this drawing by any party other than the design professional for any purpose other than that for which it was prepared and published is expressly limited to such use, in whole or in part, as may be permitted in writing by the design professional. No part of this drawing shall be used for any other purpose without the design professional's written consent. Publishing this drawing in whole or in part is prohibited without the written permission of the design professional. Any information contained or omissions omitted from this drawing shall be the user's sole risk.

wickenburg unified school district #9
Wickenburg USD Bond Projects
Vulture Peak Middle School Paving Project
40 West Yavapai Street, Wickenburg, Arizona 85390

CLIENT CONTACT

william moran 928.668.5350 t
40 west yavapai 928.668.5390 f
street wmm@wickenburg.k
wickenburg, arizona 12.az.us
85390

PROJECT NO. DATE OF ISSUE
2016_003-06 06.05.2017

REVISION NO. DATE

PROJECT TEAM DRAWN BY
education ds

PROJECT PHASE
construction documents

SHEET CONTENTS
Title Sheet - V.P.M.S. Paving

SHEET NO.
G-001

PAVING PLAN
FOR
WICKENBURG UNIFIED SCHOOL DISTRICT # 9
VULTURE PEAK MIDDLE SCHOOL

920 SOUTH VULTURE MINE ROAD

LOCATED IN THE NORTHEAST QUARTER OF SECTION 16, TOWNSHIP 7 NORTH, RANGE 5 WEST
OF THE GILA AND SALT RIVER BASE AND MERIDIAN,
MARICOPA COUNTY, ARIZONA

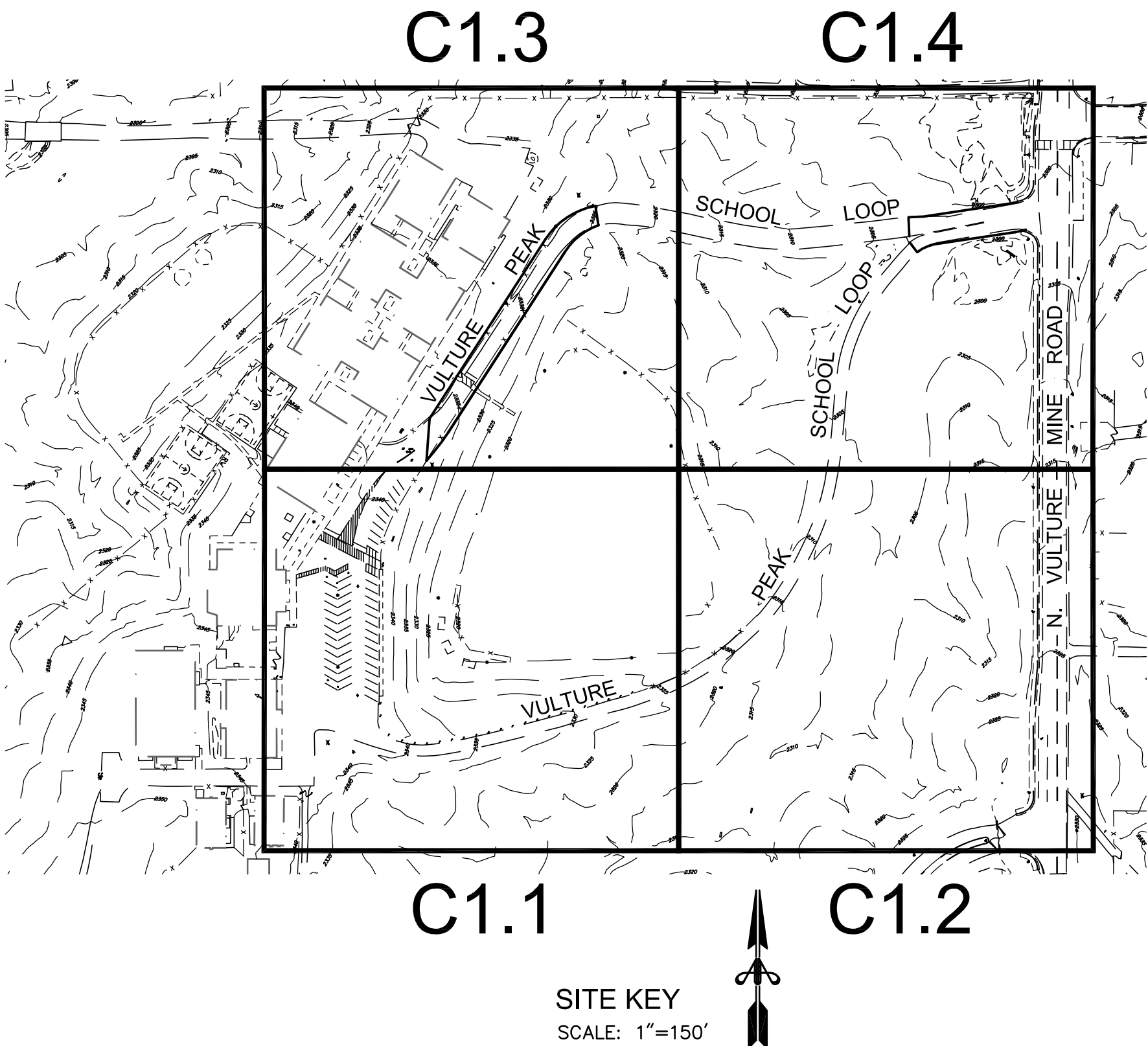

GENERAL NOTES

1. AN APPROVED SET OF PLANS SHALL BE ON THE JOB SITE AT ALL TIMES. DEVIATIONS FROM THE PLANS MUST BE PROCEEDED BY AN APPROVED PLAN REVISION.
2. ALL CONSTRUCTION SHALL CONFORM TO THE LATEST MARICOPA ASSOCIATION OF GOVERNMENTS (MAG) UNIFORM STANDARD SPECIFICATIONS AND DETAILS.
3. THE CONTRACTOR SHALL BE RESPONSIBLE FOR PROTECTION OF THE PROPERTY AND MUST REPAIR OR REPLACE, AT HIS EXPENSE, ANY DAMAGE TO THE FACILITY OR SITE, THAT OCCURS AS A RESULT OF HIS OR ANY OF HIS SUB-CONTRACTOR'S, OR SUPPLIER'S ACTIONS.
4. DAMAGED AND/OR DISPLACED CONCRETE CURB, GUTTER, SIDEWALK, OR DRIVEWAY SLAB SHALL BE REPAIRED OR REPLACED BEFORE FINAL ACCEPTANCE OF THE WORK.
5. ALL FRAMES, COVERS, DRYWELLS, CATCH BASINS, VALVE BOXES AND MANHOLE COVERS SHALL BE ADJUSTED TO FINISHED GRADE PRIOR TO THE COMPLETION OF PAVING OR RELATED CONSTRUCTION.
6. NO JOB WILL BE CONSIDERED COMPLETE UNTIL ALL CURBS, PAVEMENT AND SIDEWALKS HAVE BEEN SWEEP CLEAN AND PRECAST SAFETY CURBS HAVE BEEN RESET.
7. ANY ESTIMATED QUANTITIES SHOWN ARE FOR INFORMATIONAL AND PERMITTING PURPOSES ONLY. CONTRACTOR TO VERIFY QUANTITIES AND BASE THEIR BID SOLELY ON THEIR OWN ESTIMATE.
8. IT IS THE CONTRACTOR'S SOLE RESPONSIBILITY TO VERIFY THE PRESENCE AND LOCATION OF ANY AND ALL EXISTING OVERHEAD AND/OR UNDERGROUND UTILITIES THAT MAY INTERFERE WITH THE CONSTRUCTION, WHETHER OR NOT SAID UTILITIES ARE SHOWN ON THE CONSTRUCTION PLANS FOR THIS PROJECT. CONTRACTOR SHALL ADEQUATELY PROTECT AND MAINTAIN SUCH UTILITIES. THE CONTRACTOR SHALL CONTACT BLUE STAKE AT (602) 263-1100, 48 HOURS PRIOR TO CONSTRUCTION.
9. CONTRACTOR SHALL PROVIDE, WITHIN FIVE (5) DAYS AFTER NOTICE OF ACCEPTANCE OF BID, THE SCHOOL DISTRICT AND ENGINEER A COMPLETE MOBILIZATION SCHEDULE.
10. CONTRACTOR TO CONFORM TO ALL REQUIREMENTS AND RECOMMENDATIONS OF THE GEOTECHNICAL ENGINEERING REPORT PREPARED BY:

RAMM GEOTECHNICAL ENGINEERING
2105 SOUTH HARDY DRIVE, SUITE 13
TEMPE, ARIZONA 85282
PHONE: (480) 921-8100
FAX: (480) 921-4081
RAMM PROJECT No.: G23866
DATED: MAY 12, 2017

LEGEND

- | | |
|--|---------------------------------|
| | CONTROL POINT |
| | EXISTING DRIVE ARROW |
| | EXISTING FIRE HYDRANT |
| | EXISTING VALVE |
| | EXISTING LIGHT |
| | EXISTING MANHOLE |
| | EXISTING BOUNDARY |
| | EXISTING INDEX CONTOUR |
| | EXISTING INTERMEDIATE CONTOUR |
| | EXISTING SPOT ELEVATION |
| | PROPOSED FINISH FLOOR ELEVATION |
| | PROPOSED CONCRETE ELEVATION |
| | PROPOSED TOP OF CURB ELEVATION |
| | PROPOSED PAVEMENT ELEVATION |
| | EXISTING VEGETATION |
| | EXISTING SWING GATE |
| | EXISTING CATCH BASIN |
| | EXISTING CANOPY |
| | CONSTRUCTION NOTE NO. |
| | DRAINAGE FLOW ARROW |

APN

505-44-035A

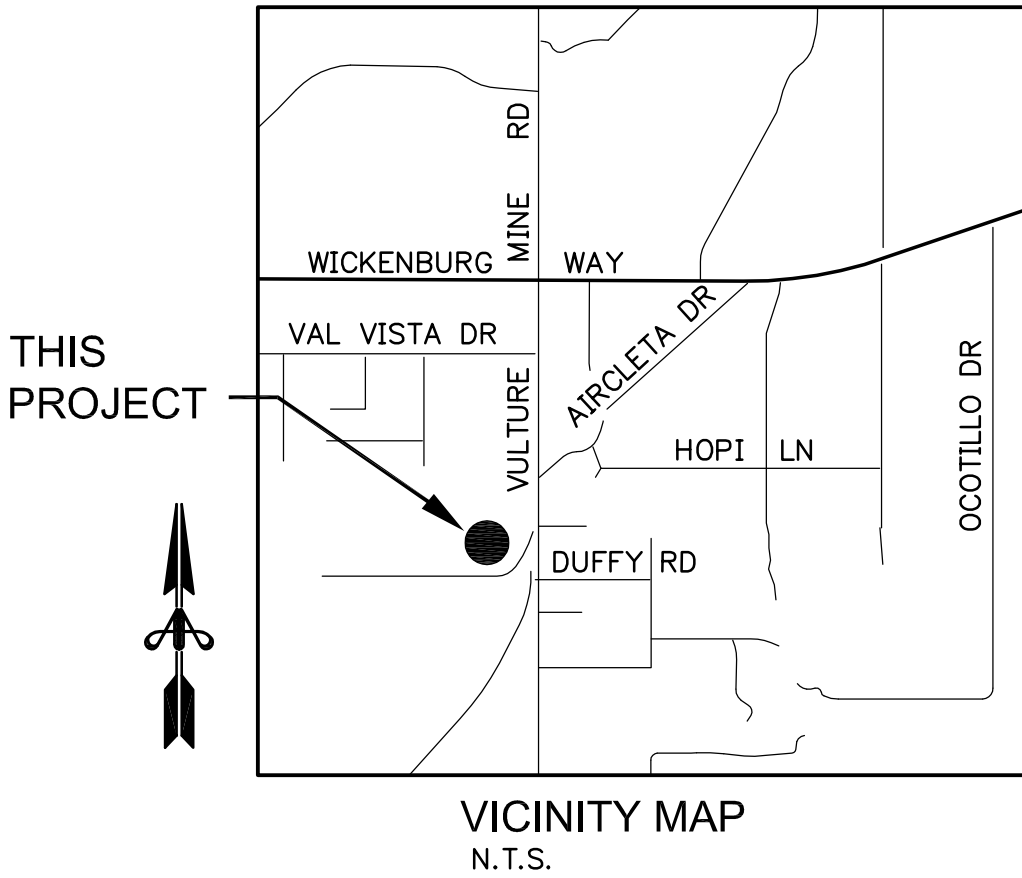

SHEET INDEX

SHEET NO.	SHEET TITLE
C1.0	COVER SHEET
C1.1 - C1.4	PAVING PLAN

OWNER / DEVELOPER

WICKENBURG UNIFIED SCHOOL DISTRICT #9
40 WEST YAVAPAI
WICKENBURG, ARIZONA 85390
TEL No. (928) 668-5350
FAX No. (928) 668-5390
CONTACT: WILLIAM MORAN

ARCHITECT

ORCUTT/WINSLOW PARTNERSHIP
3003 NORTH CENTRAL AVENUE
SIXTEENTH FLOOR
PHOENIX, ARIZONA 85012
TEL NO. (602) 257-1764
FAX NO. (602) 257-9029
CONTACT: DAVID STOVER

ENGINEER

ATHERTON ENGINEERING, INC.
1203 E. MEADOWBROOK AVE.
PHOENIX, ARIZONA 85014
PHONE: (602) 279-7331
FAX: (602) 230-1908
CONTACT: ROBERT ATHERTON, P.E.
EMAIL: RATHERTON@ATHERTONENGINEERING.COM

BENCHMARK

FOUND MARICOPA COUNTY BRASS CAP, STAMPED "T7NR5W S1 S2 S11
S12 2005 37174" DOWN 0.15' BELOW ASPHALT @ GDACS 56044-2M
NAVD 88 DATUM

ELEVATION = 2067.695

orcutt | winslow

3003 n central ave
sixteenth floor
phoenix az 85012
mail@owp.com

602.257.1764 t
602.257.9029 f

www.owp.com

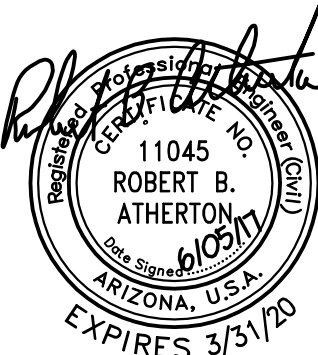

© 2016 RLS. This is a hard copy or electronic drawing is an instrument of service and the property of the ORCUTT/WINSLOW PARTNERSHIP and shall remain their property. The design professional shall not be responsible for any alterations, modifications or additions made to this drawing by any other person than the design professional. The design professional shall be responsible for the design for which it was prepared and publication thereof is expressly limited to such use. No use or reproduction, in whole or in part, of this drawing, or any part thereof, shall be made without the written consent of the design professional. No part of this drawing shall be used for any other purpose without the written consent of the design professional. Any information obtained or conclusions derived from this drawing shall be at the user's sole risk.

wickenburg unified school district #9
Wickenburg USD Bond Projects
Vulture Peak Middle School Paving Plan
40 West Yavapai Street, Wickenburg, Arizona 85390

CLIENT CONTACT

william moran	928.668.5350 t
40 west yavapai street	928.668.5390 f
wickenburg, arizona 85390	wmoran@wickenburg.k12.az.us

PROJECT NO.	DATE OF ISSUE
2016_003-06	06.05.2017

REVISION NO.	DATE
--------------	------

PROJECT TEAM	DRAWN BY
AEI	RLS

PROJECT PHASE

construction documents

SHEET CONTENTS

COVER SHEET

SHEET NO.

C1.0

SHEET 1 OF 5



ATHERTON ENGINEERING, INC.
CIVIL ENGINEERS AND LAND SURVEYORS
1203 E. MEADOWBROOK AVE. PHOENIX, AZ 85014-4028
(602) 279-7331 • FAX (602) 230-1908

JOB No. 17-03

MATCHLINE - SEE SHEET C1.3

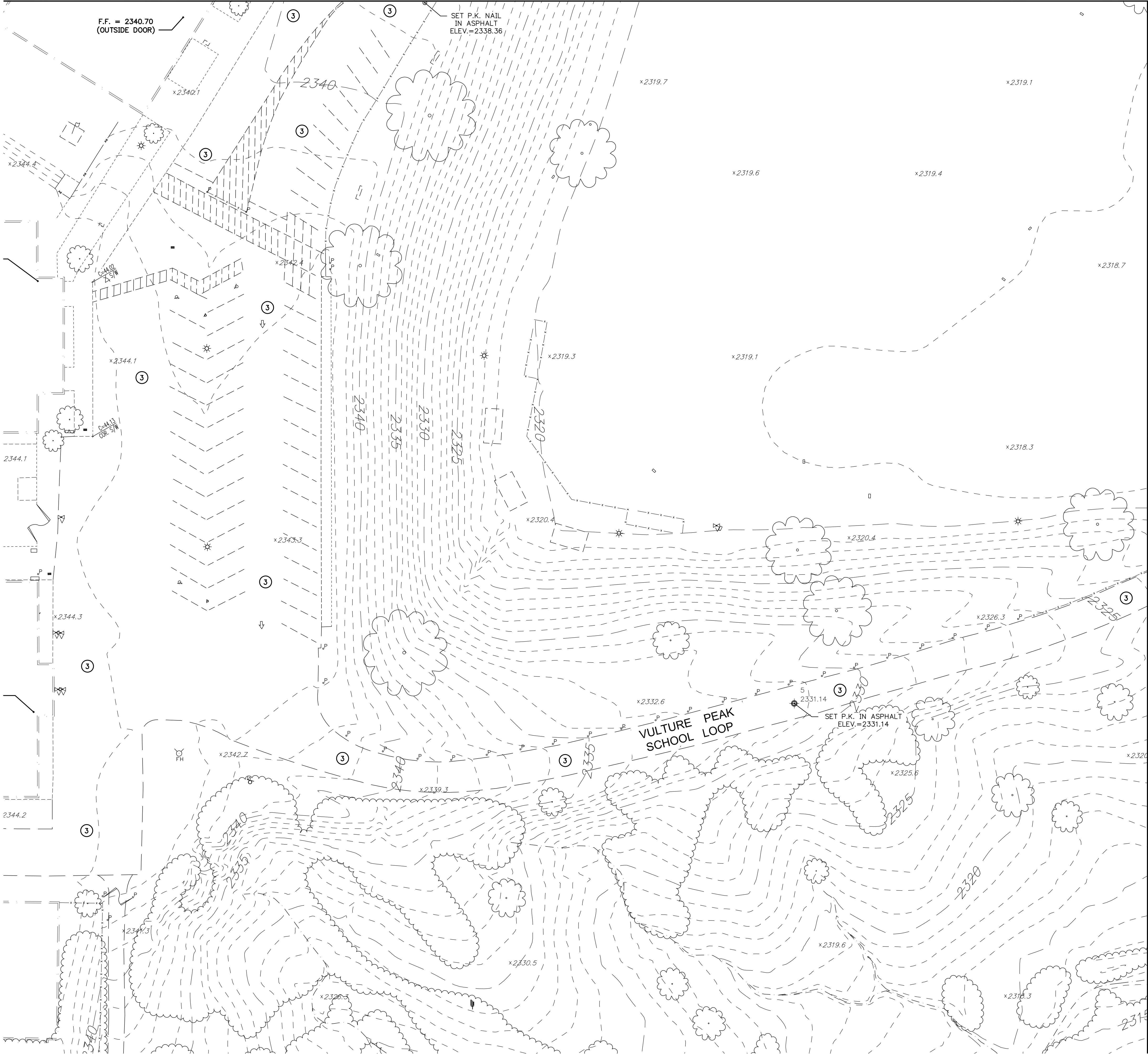

CONSTRUCTION NOTES

- PAVING:
- REMOVE EXISTING ASPHALT WITHIN AREA SHOWN. RECOMPACT EXISTING BASE MATERIAL AND PAVE WITH 2" A.C. (C 3/4).

3003 n central ave
sixteenth floor
phoenix az 85012
mail@owp.com

602.257.1764 t
602.257.9029 f

www.owp.com

orcutt | winslow

11045
ROBERT B. ATHERTON
PHOENIX, ARIZONA
EXPIRES 3/31/20

© 2016 W&A. This drawing is an instrument of service and the property of the design professional and shall remain their property. The design professional shall not be responsible for any alterations, modifications or additions made to this drawing by any other person or entity after the date of the design professional's seal. The design professional shall not be responsible for any alterations, modifications or additions made to this drawing by any other person or entity after the date of the design professional's seal. The design professional shall not be responsible for any alterations, modifications or additions made to this drawing by any other person or entity after the date of the design professional's seal.

wickenburg unified school district #9

Wickenburg USD Bond Projects

Vulture Peak Middle School Paving Plan

40 West Yavapai Street, Wickenburg, Arizona 85390

CLIENT CONTACT	
william moran 40 west yavapai street wickenburg, arizona 85390	928.668.5350 t 928.668.5390 f wmoran@wickenburg.k12.az.us

PROJECT NO.	DATE OF ISSUE
2016_003-06	06.05.2017
REVISION NO.	DATE

PROJECT TEAM	DRAWN BY
AEI	RLS

PROJECT PHASE
construction documents

SHEET CONTENTS

PAVING PLAN

SHEET NO.

C1.1

SHEET 2 OF 5

MATCHLINE - SEE SHEET C1.2

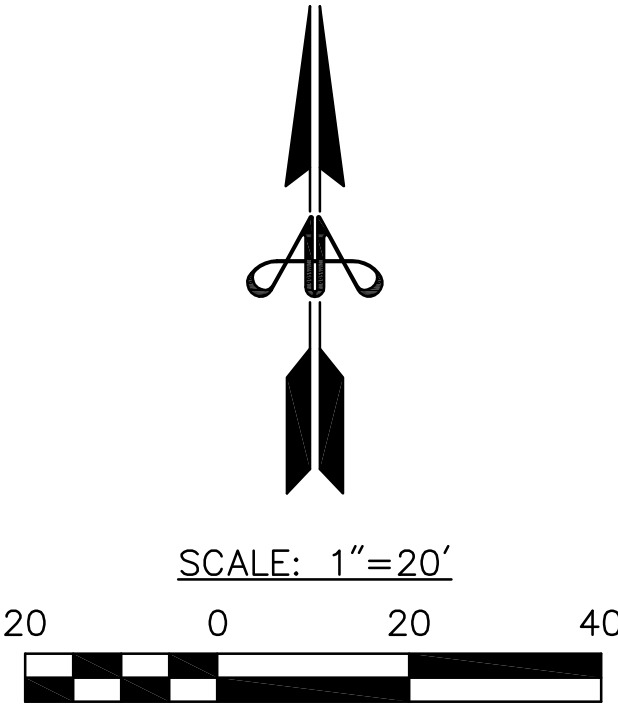

ATHERTON ENGINEERING, INC.
CIVIL ENGINEERS AND LAND SURVEYORS
1203 E. MEADOWBROOK AVE. PHOENIX, AZ 85014-4028
(602) 279-7331 • FAX (602) 230-1908

JOB No. 17-03

3. REMOVE EXISTING ASPHALT WITHIN AREA SHOWN. RECOMPACT EXISTING BASE MATERIAL AND PAVE WITH 2" A.C. (C 3/4).

3003 n central ave
sixteenth floor
phoenix az 85012
mail@owp.com

602.257.1764 t
602.257.9029 f

www.owp.com

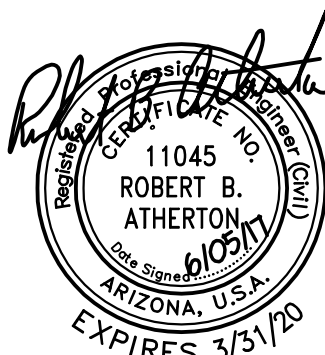

© 2018 BIA (here copyright electronic) drawing is an instrument of service and the property of the Draught/Patnership and shall remain their property. The design professional shall be responsible for any alterations, modifications or additions made to this drawing by any party other than the design professional. Use of this drawing shall be limited to the original set for which it was prepared and publication thereof is expressly limited to such use, no-use or reproduction. Unless otherwise agreed in writing, design professional reserves all copyright or other proprietary interest in this drawing, and it may not be re-used for any other purpose without the design professional's written consent. Publication by any method in whole or part prohibited without the written permission of the design professional. Any information obtained or conclusions derived from this drawing shall be at the user's sole risk.

MATCHLINE - SEE SHEET C1.1

N. VULTURE MINE ROAD

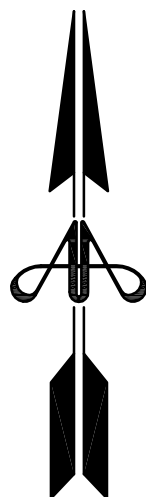

SCALE: 1"=20'



ATHERTON ENGINEERING, INC.
CIVIL ENGINEERS AND LAND SURVEYORS

1203 E. MEADOWBROOK AVE. PHOENIX, AZ 85014-4028
(602) 279-7331 * FAX (602) 230-1908

JOB No. 17-03

wickenburg unified school district #9

Wickenburg USD Bond Projects

Vulture Peak Middle School Paving Plan

40 West Yavapai Street, Wickenburg, Arizona 85390

CLIENT CONTACT

william moran
40 west yavapai street
wickenburg, arizona
85390

928.668.5350 t
928.668.5390 f
wmoran@wickenburg.k12.az.us

PROJECT NO.

2016 003-06

DATE OF ISSUE

06.05.2017

REVISION NO

DATE _____

PROJECT TEAM

AEI

DRAWN BY

RLS

PROJECT PHASE

construction documents

SHEET CONTENTS

PAVING PLAN

SHEET NO.

C1.2

SHEET 3 OF 5

40 West Yavapai Street, Wickenburg, Arizona 85390

928.668.5350 t
928.668.5390 f
wmoran@wickenburg.k12.az.us

REVISION NO. DATE

SHEET 4 OF 5

8. REMOVE EXISTING CHAIN LINK FENCE. RE-INSTALL EXISTING CHAIN LINK FENCE. RE-INSTALL FENCE OUTSIDE OF NEW PAVING LIMITS. COORDINATE REMOVAL AND INSTALLATION WITH DISTRICT.

MATCHLINE - SEE SHEET C1.4

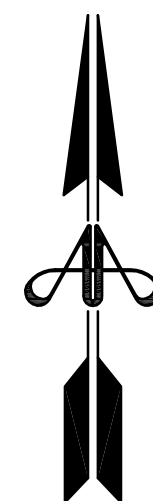

SCALE: 1"=20'



ATHERTON ENGINEERING, INC.
CIVIL ENGINEERS AND LAND SURVEYORS
1203 E. MEADOWBROOK AVE. PHOENIX, AZ 85014-4028
(602) 279-7331 • FAX (602) 230-1908

JOB No. 17-03

MATCHLINE - SEE SHEET C1.1

E:\Dropbox\Office Share\CAD Files\PROJECTS\Orcutt-Winslow\Wickenburg USD\Vulture Peak MS\VPMS Paving Plan.dwg, C1.3, 6/4/2017 12:13:34 PM

E:\Dropbox\Office Share\CAD Files\PROJECTS\Circuit\Winslow\USD\Vulture Peak MS\VPMS Paving Plan.dwg, C1.4, 6/4/2017 12:09:23 PM

MATCHLINE - SEE SHEET C1.3



MATCHLINE - SEE SHEET C1.2

CONSTRUCTION NOTES

- PAVING:
1. REMOVE EXISTING ASPHALT WITHIN AREA SHOWN. RECOMPACT EXISTING BASE MATERIAL AND PAVE WITH 2" A.C. (C 3/4) TO A WIDTH OF 35 FEET TO LINE UP WITH THE EXISTING CURB RETURNS. POSITION NEW PAVEMENT WIDTH OVER THE CENTER OF THE EXISTING PIPE CULVERT.
 2. SAWCUT EXISTING PAVEMENT TO NEAT EDGE.
 3. REMOVE EXISTING ASPHALT WITHIN AREA SHOWN. RECOMPACT EXISTING BASE MATERIAL AND PAVE WITH 2" A.C. (C 3/4).

orcutt | winslow

3003 n central ave
sixteenth floor
phoenix az 85012
mail@owp.com

602.257.1764 t
602.257.9029 f

www.owp.com

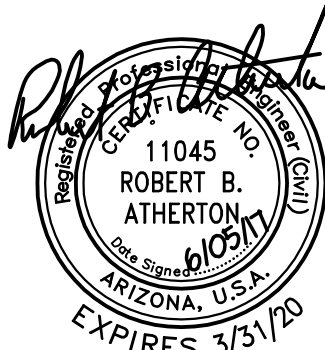

© 2016 file (hard copy or electronic) drawing is an instrument of service and the property of the design professional and shall remain their property. The design professional shall not be responsible for any alterations, modifications or additions made to this drawing by any other person than the design professional. Use of the drawing shall be limited to the project for which it was prepared and publication thereof is expressly limited to such use. Reproduction, modification, or use of the drawing without the written consent of the design professional is prohibited. The design professional shall not be held responsible for any errors or omissions in the drawing, and it may not be used for any other purpose without the design professional's written consent. Publication by any method in whole or part is prohibited without the written permission of the design professional. Any information obtained or conclusions derived from this drawing shall be at the user's sole risk.

wickenburg unified school district #9

Wickenburg USD Bond Projects

Vulture Peak Middle School Paving Plan

40 West Yavapai Street, Wickenburg, Arizona 85390

CLIENT CONTACT

william moran 928.668.5350 t
40 west yavapai street 928.668.5390 f
wickenburg, arizona wkmoran@wickenburg.k12.az.us
85390

PROJECT NO. DATE OF ISSUE
2016_003-06 06.05.2017

REVISION NO. DATE

PROJECT TEAM DRAWN BY

AEI RLS

PROJECT PHASE

construction documents

SHEET CONTENTS

PAVING PLAN

SHEET NO.

C1.4

SHEET 5 OF 5

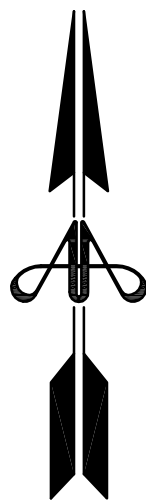

SCALE: 1"=20'



ATHERTON ENGINEERING, INC.
CIVIL ENGINEERS AND LAND SURVEYORS
1203 E. MEADOWBROOK AVE. PHOENIX, AZ 85014-4028
(602) 279-7331 • FAX (602) 230-1908

JOB No. 17-03