

FILE:11/2018/1018110-10-Pueblo_HS_CAD/18110-10-COVER.dwg DATE:8/5/2019 TIME:1:26 PM (by:greg.vega)

LEGEND

EXISTING	NEW
	SURVEY MONUMENT
	SURVEY CONTROL POINT
	FIRE HYDRANT
	FIRE PROTECTION SERVICE
	VALVE
	WATER METER
	SANITARY SEWER MANHOLE
	SANITARY SEWER CLEANOUT
	RIPRAP
	LIMITS OF CONSTRUCTION
	CENTERLINE
	EASEMENT
	DAYLIGHT LINE - CUT
	DAYLIGHT LINE - FILL
	RIGHT-OF-WAY
	CURB & GUTTER
	SINGLE CURB
	EDGE OF PAVEMENT
	SIDEWALK
	FLOWLINE
	MASONRY WALL / RETAINING WALL
	MAJOR CONTOUR
	MINOR CONTOUR
	ASPHALT PAVEMENT (2" AC/4" ABC)
	CONCRETE SIDEWALK

PUEBLO HIGH SCHOOL
DRAINAGE IMPROVEMENTS
FOR
TUCSON UNIFIED SCHOOL DISTRICT
TUCSON, AZ

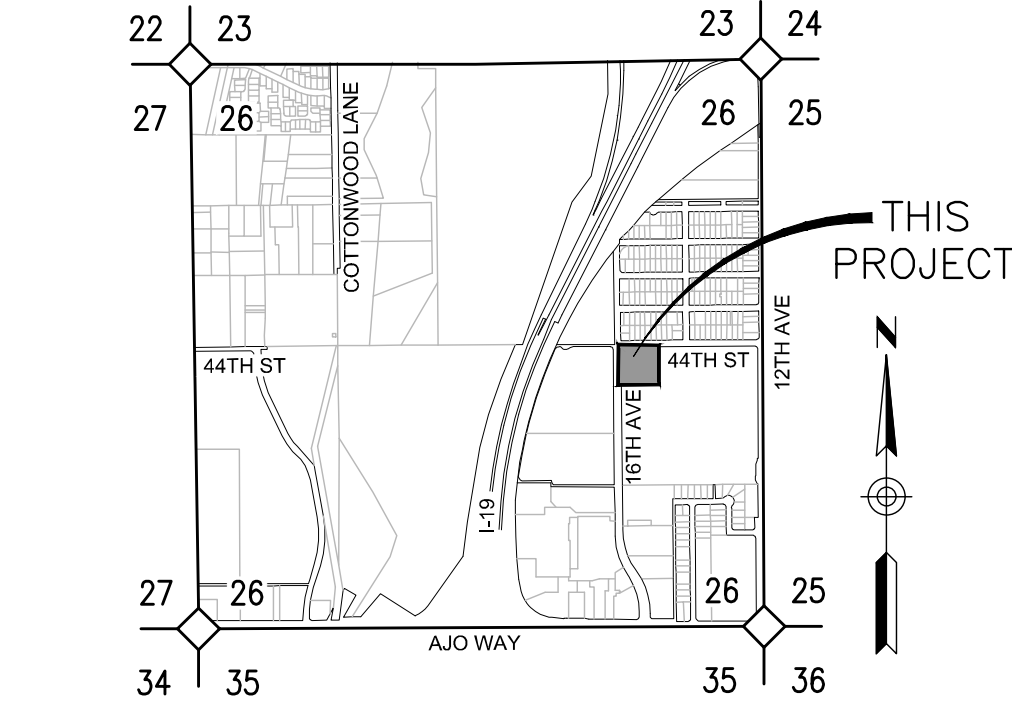

LOCATION MAP

A PORTION OF THE SOUTHEAST 1/4 OF
SECTION 26, TOWNSHIP 14 SOUTH, RANGE 13 EAST,
G&SRM, PIMA COUNTY, ARIZONA
3" = 1 MILE

LAT: 32° 10' 54" N
LONG: -110° 58' 42" W

BASIS OF BEARING

THE BASIS OF BEARING FOR THIS PROJECT
IS THE ARIZONA STATE PLANE COORDINATE
SYSTEM, NORTH AMERICAN DATUM OF 1983
(NAD83)(HARN92).

BASIS OF ELEVATION

THE BASIS OF ELEVATION FOR THIS PROJECT
IS THE NORTH AMERICAN VERTICAL DATUM OF
1988 (NAVD88) FROM CITY OF TUCSON
BENCHMARK POINT #361A (G04, T14S, R14E).
ELEVATION = 2422.78

SHEET INDEX

PAGE	SHEET	DESCRIPTION
1	C1.0	COVER SHEET, LEGEND & ABBREVIATIONS
2	C2.1	DEMOLITION PLAN
3	C3.1	SITE PLAN
4	C4.1	GRADING PLAN

APPROVED BY:

BY: TUSD OPERATIONS DATE

GENERAL NOTES

- ALL MATERIALS, CONSTRUCTION AND WORKMANSHIP SHALL CONFORM TO THE PIMA ASSOCIATION OF GOVERNMENT'S (PAG'S) STANDARD DETAILS AND SPECIFICATIONS, LATEST EDITION.
- UTILITY LOCATIONS ARE NOT INTENDED TO BE EXACT OR COMPLETE. PRIOR TO COMMENCING CONSTRUCTION, THE CONTRACTOR SHALL VERIFY THE LOCATION OF ALL UTILITIES WITH THE APPROPRIATE ORGANIZATIONS. CONTACT "ARIZONA 811," ARIZONA BLUE STAKE, INC. AT 811 OR 1-800-782-5348 AT LEAST TWO FULL WORKING DAYS PRIOR TO BEGINNING CONSTRUCTION. SATURDAYS AND SUNDAYS ARE NOT CONSIDERED WORKING DAYS.
- CONSTRUCTION ZONE TRAFFIC CONTROL SHALL CONFORM TO THE REQUIREMENTS OF THE MANUAL ON UNIFORM TRAFFIC CONTROL DEVICES, LATEST EDITION.
- RIGHT-OF-WAY ENCROACHMENTS SHALL BE REMOVED ONLY BY DIRECTION OF CITY OF TUCSON, UNLESS OTHERWISE NOTED ON THE PROJECT PLANS OR IN THE PROJECT'S CONTRACT DOCUMENTS. IF PROJECT AFFECTS PRIVATE PROPERTY ACCESS, RIGHTS OF ENTRY AND TEMPORARY CONSTRUCTION EASEMENTS ARE REQUIRED PRIOR TO COMMENCEMENT OF CONSTRUCTION.
- REMOVAL OF ALL CACTI AND NATIVE PLANTS SHALL BE IN ACCORDANCE WITH THE PROVISIONS OF THE "ARIZONA NATIVE PLANT LAW," ARS CHAPTER 7 (ARS SECTION 3-901, ET SEQ) AND THE PIMA COUNTY NATIVE PLANT PRESERVATION ORDINANCE.
- THE CONTRACTOR SHALL COMPLY WITH ALL APPLICABLE OCCUPATIONAL SAFETY AND HEALTH ADMINISTRATION (OSHA) REGULATIONS.
- THE CONTRACTOR SHALL ADJUST ALL WATER METERS, VALVE BOXES, STORM DRAIN, SANITARY SEWER MANHOLES AND CLEANOUTS TO FINISHED GRADE. THE COST OF THIS WORK SHALL BE CONSIDERED AS INCIDENTAL TO THE OTHER ITEMS OF THE WORK, EXCEPT WHEN THE PROJECT'S BIDDING SCHEDULE CONTAINS SPECIFIC ITEMS.
- THE CONTRACTOR SHALL OBTAIN ALL PERMITS REQUIRED BY ALL GOVERNMENTAL AGENCIES UNLESS SPECIFIED OTHERWISE IN THE PROJECT'S CONTRACT DOCUMENTS.
- ALL PERMANENT PAVEMENT STRIPING AND MARKINGS SHALL BE APPLIED BY THE CONTRACTOR.
- A CAUTION MUST BE NOTED CONCERNING HUMAN BURIALS. IN ACCORDANCE WITH THE STATE BURIAL PROTECTION LAWS, IN THE EVENT THAT HUMAN REMAINS, INCLUDING HUMAN SKELETAL REMAINS, CREMATIONS, AND/OR CEREMONIAL OBJECTS AND FUNERARY OBJECTS ARE FOUND DURING EXCAVATION OR CONSTRUCTION, GROUND DISTURBING ACTIVITIES MUST CEASE IN THE IMMEDIATE VICINITY OF THE DISCOVERY.
- STATE LAWS ARS 41-865 AND ARS 41-844 REQUIRE THAT THE ARIZONA STATE MUSEUM (520) 621-4795 BE NOTIFIED OF THE DISCOVERY SO THAT CULTURAL GROUPS WHO CLAIM CULTURAL OR RELIGIOUS AFFINITY TO THEM CAN MAKE APPROPRIATE ARRANGEMENTS FOR THE REPATRIATION AND REBURIAL OF THE REMAINS. THE HUMAN REMAINS WILL BE REMOVED FROM THE SITE BY A PROFESSIONAL ARCHAEOLOGIST PENDING CONSULTATION AND REVIEW BY THE ARIZONA STATE MUSEUM AND THE CONCERNED CULTURAL GROUPS.
- NO ON-SITE OR OFF-SITE DRAINAGE ANALYSIS WAS PROVIDED FOR THIS PROJECT. EXISTING ON-SITE DRAINAGE PATTERNS SHALL BE MAINTAINED.
- NO GEOTECHNICAL REPORT HAS BEEN PROVIDED FOR THIS PROJECT. TUSD PROVIDED THE PAVEMENT SECTION AS CALLED OUT ON THESE PLANS.

ABBREVIATIONS

ABC	AGGREGATE BASE COURSE	ELEC	ELECTRIC	PUE	PUBLIC UTILITY EASEMENT
AC	ASPHALTIC CONCRETE	ESMT	EASEMENT	PVC	POLYVINYL CHLORIDE
ADA	AMERICANS WITH DISABILITIES ACT	EXST	EXISTING	PVMT	PAVEMENT
ARS	ARIZONA REVISED STATUTES	F/C	FACE OF CURB	R	RADIUS
AVE	AVENUE	FFE	FINISH FLOOR ELEVATION	R/W	RIGHT-OF-WAY
ACHH	ALUMINUM CAP IN HANDHOLE	FG	FINISH GRADE	REQ	REQUIRED
B&C	BOX AND COVER	FL	FLOWLINE	RT	RIGHT
BCF	BRASS CAP FLUSH	FO	FIBER OPTIC	PCRWRD	PIMA COUNTY REGIONAL WASTEWATER RECLAMATION DEPARTMENT
BCHH	BRASS CAP IN HANDHOLE	FT	FOOT OR FEET	S	SEWER
BCS	BUILDING CONNECTION SEWER	FS	FIRE SERVICE	SD	STORM DRAIN
BFP	BACKFLOW PREVENTOR	G	GAS	SEC	SECTION
BLDG	BUILDING	GB	GRADE BREAK	SHT	SHEET
BM	BENCHMARK	INV	INVERT	SPEC	SPECIFICATIONS
BOT	BOTTOM	IRR	IRRIGATION	STA	STATION
C	CONCRETE ELEVATION	LT	LEFT	STD	STANDARD
CATV	CABLE TELEVISION	M	MONUMENT LINE	T	TOWNSHIP
CL	CENTERLINE	MOD	MODIFIED	TC	TOP OF CURB
COMM	COMMUNICATION	MUTCD	MANUAL ON UNIFORM TRAFFIC CONTROL DEVICES	TDOT	TUCSON DEPARTMENT OF TRANSPORTATION
CONC	CONCRETE	NO	NUMBER	TEL	TELEPHONE
CONST	CONSTRUCTION	NTS	NOT TO SCALE	TEMP	TEMPORARY
COTWD	CITY OF TUCSON WATER DEPARTMENT	OHE	OVERHEAD ELECTRIC	TYP	TYPICAL
DET	DETAIL	OHFO	OVERHEAD FIBER OPTIC	UNK	UNKNOWN
DG	DECOMPOSED GRANITE	P	PAVEMENT ELEVATION	UTIL	UTILITY
DIP	DUCTILE IRON PIPE	PAG	PIMA ASSOCIATION OF GOVERNMENTS	W	WATER
DOT	DEPARTMENT OF TRANSPORTATION	PCDOT	PIMA COUNTY DEPARTMENT OF TRANSPORTATION	WM	WATER METER
E/P	EDGE OF PAVEMENT	PL	PROPERTY LINE	WS	WATER SERVICE
EB	ELECTRIC PULLBOX				
EL	ELEVATION				



SITE ADDRESS:
PUEBLO HIGH SCHOOL
3500 S. 12TH AVE.
TUCSON, AZ 85713
P. 520.225.4302
www.tusd1.org/pueblo

OWNER:
TUCSON UNIFIED SCHOOL DISTRICT
1010 E. TENTH ST.
TUCSON, AZ 85719
P. 520.225.6000
www.tusd1.org

CIVIL ENGINEER:
DIBBLE ENGINEERING
177 N. CHURCH AVENUE
SUITE 711
TUCSON, AZ 85701
P. 520.495.4065
www.dibblecorp.com

DRAINAGE IMPROVEMENTS
TUCSON, AZ

PUEBLO HIGH SCHOOL



Project No.: 1018110.10
Designed: GDV Date: 08/2019
Drawn: GREGORY D. VEGA
Checked: GDV Date: 08/2019



COVER SHEET,
LEGEND &
ABBREVIATIONS

SHEET: C1.0

SCALE: N/A

PAGE 1 OF 4



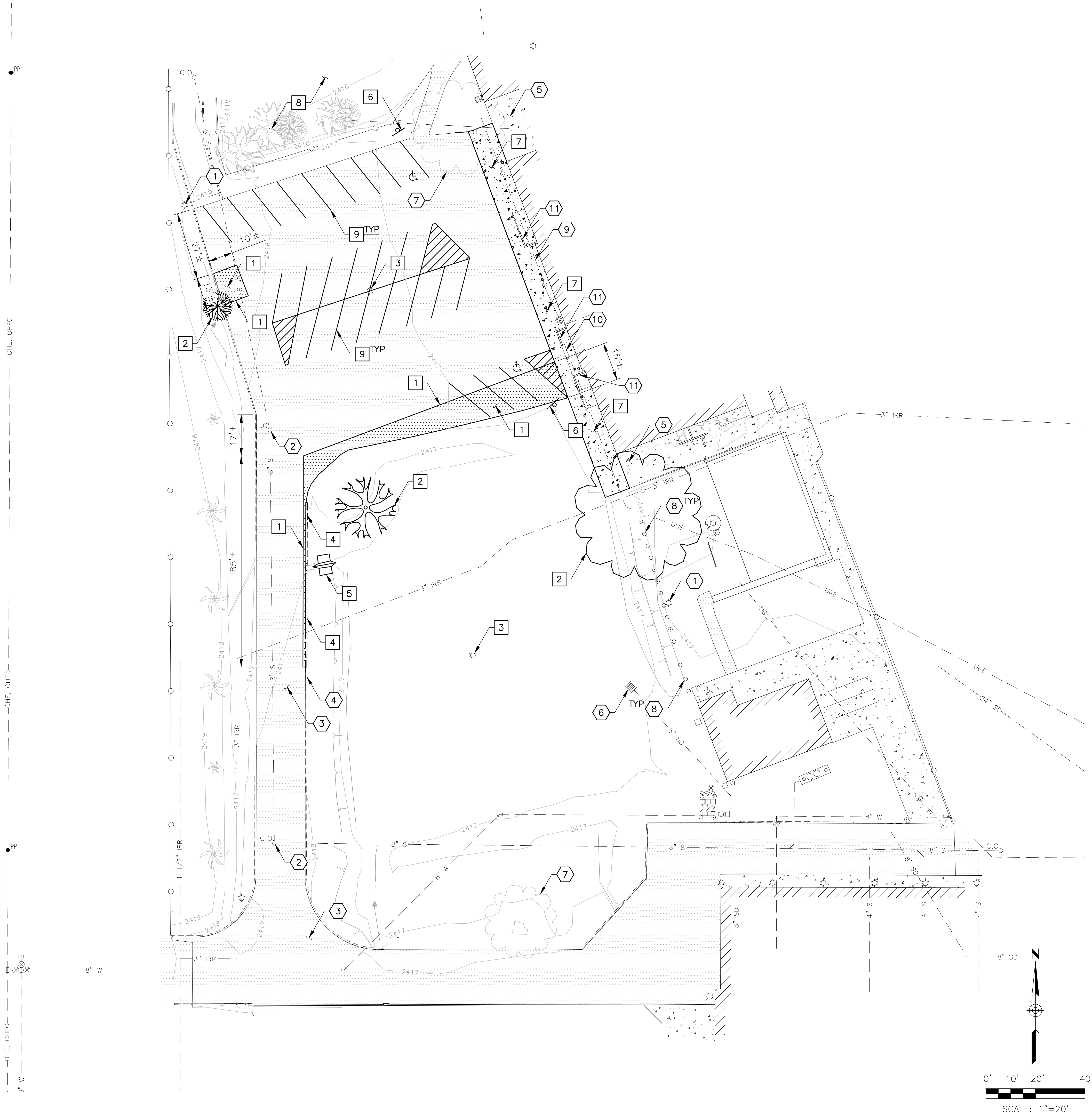

- REMOVAL NOTES**
- 1 SAW CUT EXST PVMT, FULL DEPTH & REMOVE
PROVIDE STRAIGHT, CLEAN LINE
CLEAN & TACK EXST PVMT
 - 2 REMOVE EXST TREE
 - 3 REMOVE & RELOCATE EXST LIGHT POLE
REFER TO SITE PLAN
 - 4 REMOVE EXST CONC CURB
 - 5 REMOVE EXST CONC DRAINAGE STRUCTURE
 - 6 REMOVE EXST SIGN & POST
 - 7 REMOVE EXST CONC SWLK
 - 8 CLEAN & REMOVE ALL DEBRIS WITHIN GARDEN
AREA, AS IDENTIFIED BY TUSD PERSONNEL
 - 9 OBLITERATE EXST PVMT MARKING

- REFERENCE NOTES**
- 1 EXST LIGHT POLE
PROTECT IN PLACE
 - 2 EXST SANITARY SEWER CLEAN OUT
PROTECT IN PLACE
 - 3 EXST ASPHALT PVMT
PROTECT IN PLACE
 - 4 EXST CONC CURB
PROTECT IN PLACE
 - 5 EXST CONC SIDEWALK
PROTECT IN PLACE
 - 6 EXST DRAINAGE INLET
PROTECT IN PLACE
 - 7 EXST TREE
PROTECT IN PLACE
 - 8 EXST BOLLARD
PROTECT IN PLACE
 - 9 EXST GAS LINE
PROTECT IN PLACE
 - 10 EXST UNDERGROUND ELEC
PROTECT IN PLACE
 - 11 EXST BLOCK WALL
PROTECT IN PLACE

GENERAL NOTES

CONTRACTOR SHALL LOCATE, CLEAN & JET-WASH
ALL INLET STORM DRAINS & PIPES WITHIN THE
PROJECT LIMITS. REPAIR ALL DAMAGED STORM
DRAINS OR PIPES. COORD EXACT LOCATIONS W/
TUSD PROJECT MANAGER

TUSD
Tucson Unified School District
Building for Children

SITE ADDRESS:
PUEBLO HIGH SCHOOL
3500 S. 12TH AVE.
TUCSON, AZ 85713
P. 520.225.4302
www.tusd1.org/pueblo

OWNER:
TUCSON UNIFIED SCHOOL DISTRICT
1010 E. TENTH ST.
TUCSON, AZ 85719
P. 520.225.6000
www.tusd1.org

CIVIL ENGINEER:
DIBBLE ENGINEERING
177 N. CHURCH AVENUE
SUITE 711
TUCSON, AZ 85701
P. 520.495.4065
www.dibblecorp.com

DRAINAGE IMPROVEMENTS
TUCSON, AZ
PUEBLO HIGH SCHOOL



Project No.: **1018110.10**
Designed: GDV Date: 08/2019
Drawn: DGV Date: 08/2019
Checked: GDV Date: 08/2019



**DEMOLITION
PLAN**

SHEET: **C2.1**

SCALE: **1"=20'**

PAGE **2** OF **4**

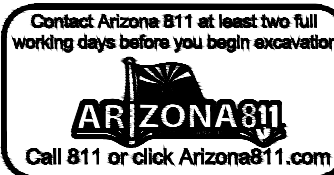

FILE:IT\2018\101811010-Pueblo_HS\CAD\18110_10-SITE.dwg DATE:8/5/2019 TIME:1:26 PM (b:greg.vega)

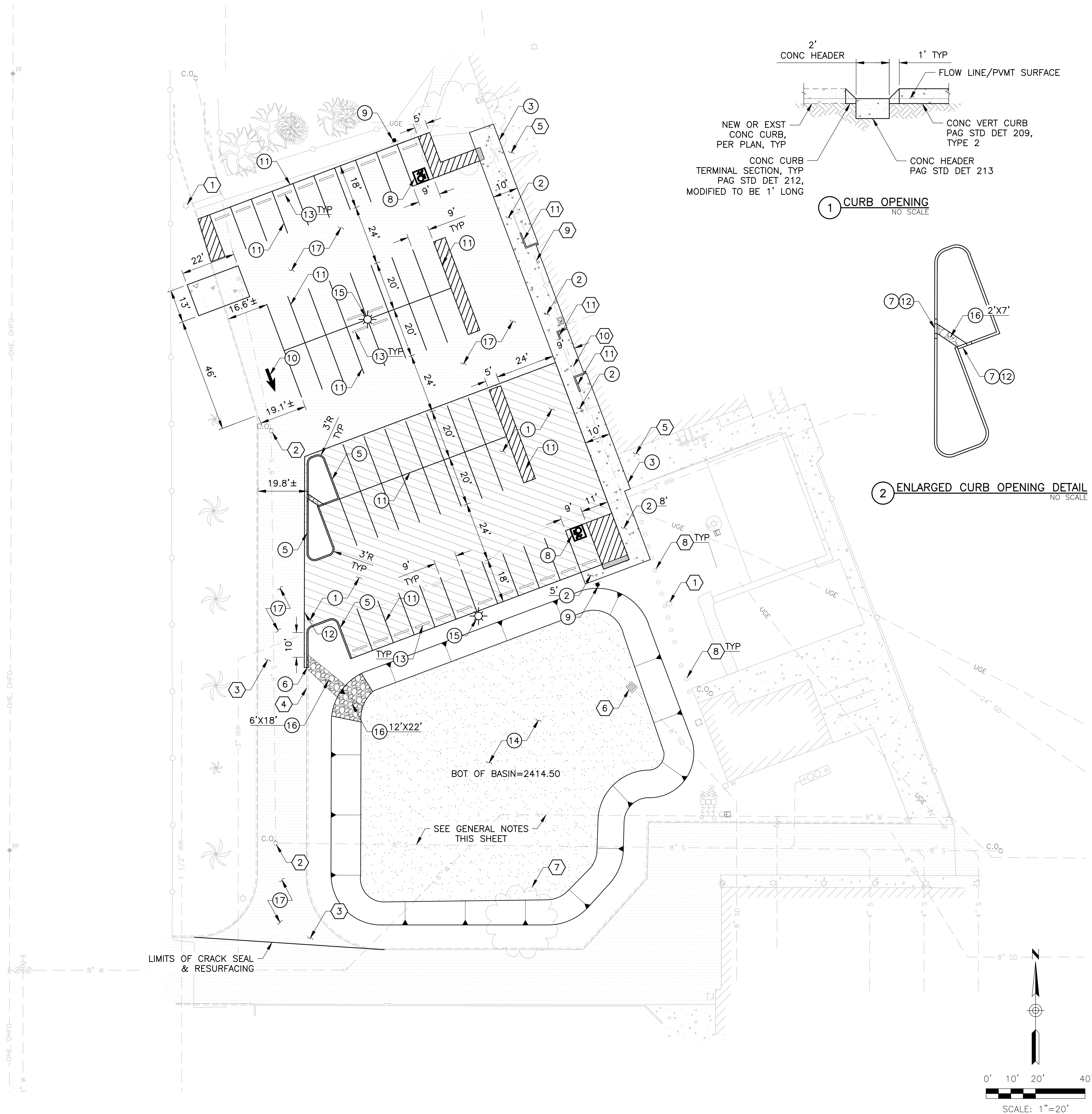

- CONSTRUCTION NOTES**
- ASPHALT PVMT, 2" AC OVER 4" ABC
AC PER PAG SPEC SECT #406, MIX #2
ABC PER PAG SPEC SECT #303
 - CONC SWLK, WIDTH PER PLAN
PAG STD DET 200
 - CONC SWLK, NEW TO EXST CONNECTION
PAG STD DET 203
 - CONC VERT CURB, TYPE 2
PAG STD DET 209
 - CONC CURB, NEW TO EXST CONNECTION
PAG STD DET 211
 - CONC HEADER
PAG STD DET 213
 - ADA PARKING STALL, SYMBOL & STRIPING
PER ADA GUIDELINES, LATEST EDITION
 - ADA PARKING SIGN & POST
PER ADA GUIDELINES, LATEST EDITION
 - PVMT MARKING, WHITE ARROW
PER PCDOT & TDOT TRAFFIC ENGINEERING
DIVISION PAVEMENT MARKING DESIGN MANUAL
 - PVMT MARKING, 4" WHITE STRIPE
 - PROVIDE 2' WIDE CURB OPENING
TO ALLOW FOR SURFACE DRAINAGE
DETS 1&2, THIS SHT
 - 6' LONG CONC WHEEL STOP
LOCATION PER PLAN
 - DETENTION BASIN
4:1 (H:V) SIDE SLOPES
6" THICK PEA GRAVEL ON BOTTOM
TOP OF PEA GRAVEL=2414.50
 - RELOCATED LIGHT POLE
COORDINATE LOCATION WITH OWNER
 - DUMPED RIPRAP, D50=6"
DEPRESS 6" TO ALLOW FOR OVERFLOW
DRAINAGE
 - EXST ASPHALT PVMT TO BE CRACK SEALED
& RESURFACED

- REFERENCE NOTES**
- EXST LIGHT POLE
PROTECT IN PLACE
 - EXST SANITARY SEWER CLEAN OUT
PROTECT IN PLACE
 - EXST ASPHALT PVMT
PROTECT IN PLACE
 - EXST CONC CURB
PROTECT IN PLACE
 - EXST CONC SIDEWALK
PROTECT IN PLACE
 - EXST DRAINAGE INLET
PROTECT IN PLACE
 - EXST TREE
PROTECT IN PLACE
 - EXST BOLLARD
PROTECT IN PLACE
 - EXST GAS LINE
PROTECT IN PLACE
 - EXST UNDERGROUND ELEC
PROTECT IN PLACE
 - EXST BLOCK WALL
PROTECT IN PLACE

GENERAL NOTES

CONTRACTOR SHALL POTHOLE EXISTING WATER AND
SEWER LINES WITHIN BASIN LIMITS TO VERIFY
EXISTING DEPTHS OF COVER. MAINTAIN 3- FEET
MINIMUM COVER FOR BOTH UTILITY MAINS, MODIFY
LIMITS OF NEW BASIN AS REQUIRED.

TUSD
Tucson Unified School District
Building for Children

SITE ADDRESS:
PUEBLO HIGH SCHOOL
3500 S. 12TH AVE.
TUCSON, AZ 85713
P. 520.225.4302
www.tusd1.org/pueblo

OWNER:
TUCSON UNIFIED SCHOOL DISTRICT
1010 E. TENTH ST.
TUCSON, AZ 85719
P. 520.225.6000
www.tusd1.org

CIVIL ENGINEER:
DIBBLE ENGINEERING
177 N. CHURCH AVENUE
SUITE 711
TUCSON, AZ 85701
P. 520.495.4065
www.dibblecorp.com

DRAINAGE IMPROVEMENTS
TUCSON, AZ
PUEBLO HIGH SCHOOL

Dibble Engineering

Project No.: 1018110.10
Date: 08/2019
Designed: GDV
Drawn: DGV
Checked: GDV

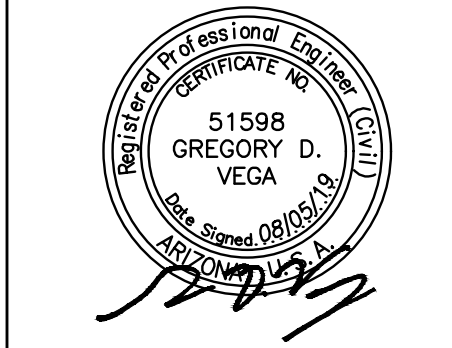

SITE PLAN

SHEET: C3.1
SCALE: 1"=20'
PAGE 3 OF 4

FILE:IT\2018\1018110.10_Pueblo_HS\CAD\18110_10-GRAD.dwg DATE:8/5/2019 TIME:1:26 PM (by:greg.vega)

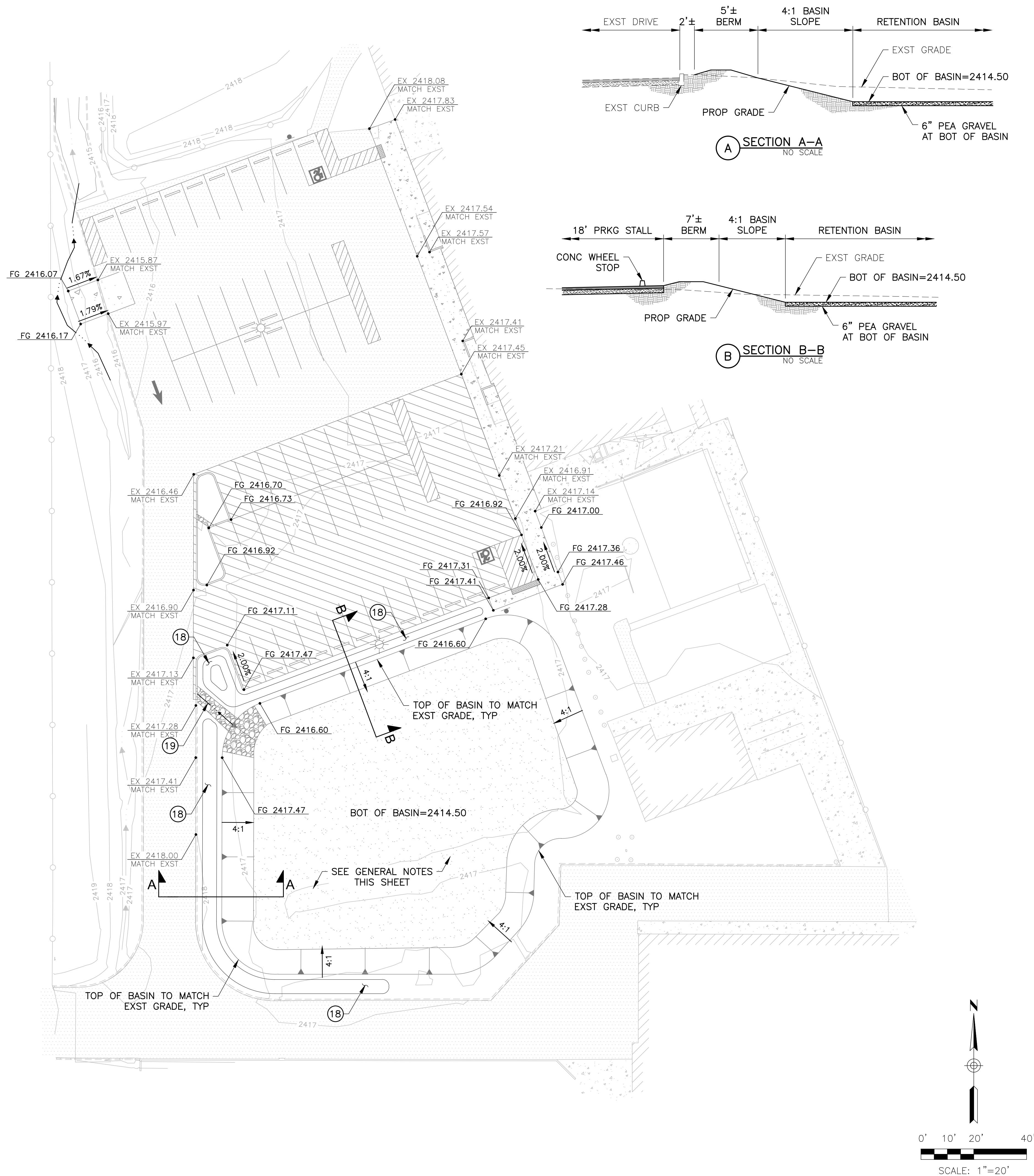

CONSTRUCTION NOTES

- FREE-FORM BERM USING EXCESS BASIN FILL MATERIAL. COORD W/ TUSD PROJECT MANAGER
- CREATE FLOWLINE & GRADE THIS AREA TO DRAIN TO NEW CURB OPENING

GENERAL NOTES

- CONTRACTOR SHALL NOT EXCEED ADA SLOPES (2% CROSS SLOPE, 5% LONGITUDINAL SLOPE) IN ALL SIDEWALK AREAS.
- ALL TOP OF CURB ELEVATIONS ARE EQUAL TO PAVEMENT GRADES PLUS 6", UNLESS NOTED OTHERWISE.
- ALL ELEVATIONS ARE TO FINISH GRADE OF MATERIALS (ASPHALT, CONCRETE, RIPRAP, DG, ETC.) CONTRACTOR SHALL OVER EXCAVATE AS REQUIRED TO MEET ELEVATIONS PER PLAN.
- ALL VALVE BOXES, ELECTRICAL BOXES, MANHOLES, CLEANOUTS, VAULTS AND OTHER UTILITY SURFACE FEATURES SHALL BE ADJUSTED TO FINISH GRADE.
- CONTRACTOR SHALL MATCH EXISTING ELEVATIONS AT ALL SAWCUT LINES AND AT ALL SIDEWALK, CURB, AND CURB & GUTTER TIE-IN LOCATIONS.
- CONTRACTOR SHALL VERIFY ALL EXISTING UTILITY LOCATIONS PRIOR TO CONSTRUCTION.

GENERAL NOTES

CONTRACTOR SHALL POTHOLE EXISTING WATER AND SEWER LINES WITHIN BASIN LIMITS TO VERIFY EXISTING DEPTHS OF COVER. MAINTAIN 3-FOOT MINIMUM COVER FOR BOTH UTILITY MAINS, MODIFY LIMITS OF NEW BASIN AS REQUIRED.



SITE ADDRESS:
PUEBLO HIGH SCHOOL
3500 S. 12TH AVE.
TUCSON, AZ 85713
P. 520.225.4302
www.tusd1.org/pueblo

OWNER:
TUCSON UNIFIED SCHOOL DISTRICT
1010 E. TENTH ST.
TUCSON, AZ 85719
P. 520.225.6000
www.tusd1.org

CIVIL ENGINEER:
DIBBLE ENGINEERING
177 N. CHURCH AVENUE
SUITE 711
TUCSON, AZ 85701
P. 520.495.4065
www.dibblecorp.com

DRAINAGE IMPROVEMENTS TUCSON, AZ PUEBLO HIGH SCHOOL

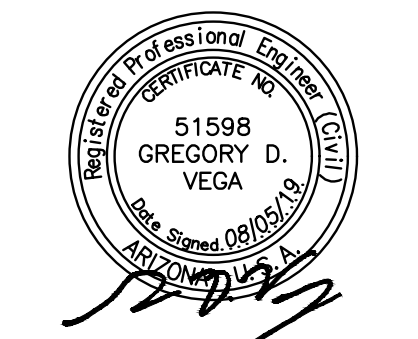

GRADING PLAN

SHEET: C4.1

SCALE: 1"=20'

PAGE 4 OF 4

