

SCHEDULE OF VALUES
EXHIBIT 'X'



ESTIMATE DATE: July 23, 2018

PROJECT: **Litchfield School 16 - Adjacent Ways**

DIV	DESCRIPTION	ONSITE ADJ WAYS	OFFSITE ADJ WAYS	DISTRICT
1A	Survey and Layout	1,982	892	0
3A	Concrete	224,231	67,223	0
26A	Electrical	0	0	X
31A	Earthwork	260,594	50,782	0
32B	Stabilized DG	0	8,904	0
33A	Site Utilities	0	18,730	0
	Project Requirements	2,495	832	0
	General Conditions	31,299	10,433	0
	Material and Labor Escalation Contingency (1.5%)	7,809	2,367	0
	City/Design Contingency	0	0	0
	Construction Contingency (2.5%)	13,015	3,945	0
	Testing & Special Inspections	<i>by owner</i>	<i>by owner</i>	<i>by owner</i>
	Architectural & Engineering Fees	<i>by owner</i>	<i>by owner</i>	<i>by owner</i>
	Utilities (Design, Construction, & Usage Fees)	<i>by owner</i>	<i>by owner</i>	<i>by owner</i>
	Permits & Development Impact Fees	<i>by owner</i>	<i>by owner</i>	<i>by owner</i>
	G/L Insurance	5,591	1,695	0
	Builders Risk Insurance	1,243	377	0
	Performance & Payment Bond	6,213	1,883	0
	Contractors Fee	29,584	8,967	0
	Gross Receipts Tax	37,204	11,277	0

TOTAL ADJACENT WAYS COSTS: 621,259 188,305

TOTAL COMBINED ADJACENT WAYS COSTS: 809,564

- 12 - Concrete - OFFSITE - VALLEY GUTTER, ADJ WAYS - 2,302 SF
- 13 - Concrete - OFFSITE - RAMP, ADJ WAYS - 1,328 SF
- 14 - Concrete - OFFSITE - CURB, HEADER @ RAMP, ADJ WAYS - 116 LF
- 15 - Concrete - OFFSITE - SIDEWALK, 8W, ADJ WAYS - 1,689 SF
- 16 - Concrete - ONSITE - CURB, VERT CURB & GUTTER, ADJ WAYS - 1,476 LF
- 17 - Concrete - ONSITE - CURB, SINGLE CURB, ADJ WAYS - 1,529 LF
- 18 - Concrete - ONSITE - CURB, MOUNTABLE CURB, ADJ WAYS - 382 LF
- 19 - Concrete - ONSITE - PAVE, 7" FIRE LANE, ADJ WAYS - 22,520 SF
- 21 - Concrete - OFFSITE - SIDEWALK, 5W, ADJ WAYS - 211 SF
- 23 - Concrete - OFFSITE - CURB, VERT CURB, ADJ WAYS - 249 LF
- 29 - Concrete - OFFSITE - CURB, VERT CURB & GUTTER, ADJ WAYS - 295 LF
- 31 - Concrete - OFFSITE - SIDEWALK @ MEDIAN, ADJ WAYS - 498 SF
- 35 - Dry Utilities - SW Gas - 30 LF
- 2 - Earthwork - OVERALL OFFSITE AREA, ADJ WAYS - 9,001 SY
- 8 - Earthwork - OFFSITE - PAVE, RIR 6"X12", ADJ WAYS - 80 SY
- 10 - Earthwork - OFFSITE - DEMO EXISTING CURB, ADJ WAYS - 648 LF
- 11 - Earthwork - OFFSITE - DEMO CONCRETE SIDEWALK, ADJ WAYS - 3,704 SF
- 20 - Earthwork - ONSITE - PAVE, 3"X7" AC, ADJ WAYS - 5,511 SY
- 24 - Earthwork - ONSITE - PAVE, SPEED TABLE, 3"X7" AC, ADJ WAYS - 126 SY
- 28 - Earthwork - OFFSITE - DEMO PAVEMENT, ADJ WAYS - 109 SY
- 30 - Earthwork - OFFSITE - PAVE, 4.5"X9" RUBBERIZED, ADJ WAYS - 387 SY
- 22 - Fence - ONSITE - GATE, 20' FIRE ACCESS, ADJ WAYS - 4 EA
- 26 - Wet Utilities - OFFSITE - STABILIZED DG FIRE LANE, ADJ WAYS - 1,729 SF
- 1 - Wet Utilities - OFFSITE - SEWER - CTE, ADJ WAYS - 1 EA
- 28 - Wet Utilities - OFFSITE - RELOCATE EXISTING UTILITY, ADJ WAYS - 2 EA
- 27 - Wet Utilities - OFFSITE - SEWER - 8" PVC SDR35, ADJ WAYS - 40 LF
- 32 - Wet Utilities - OFFSITE - WATER - 8" X8" TSVBC, ADJ WAYS - 1 EA
- 33 - Wet Utilities - OFFSITE - WATER - 8" PVC CLASS 200 (C900), ADJ WAYS - 20 LF

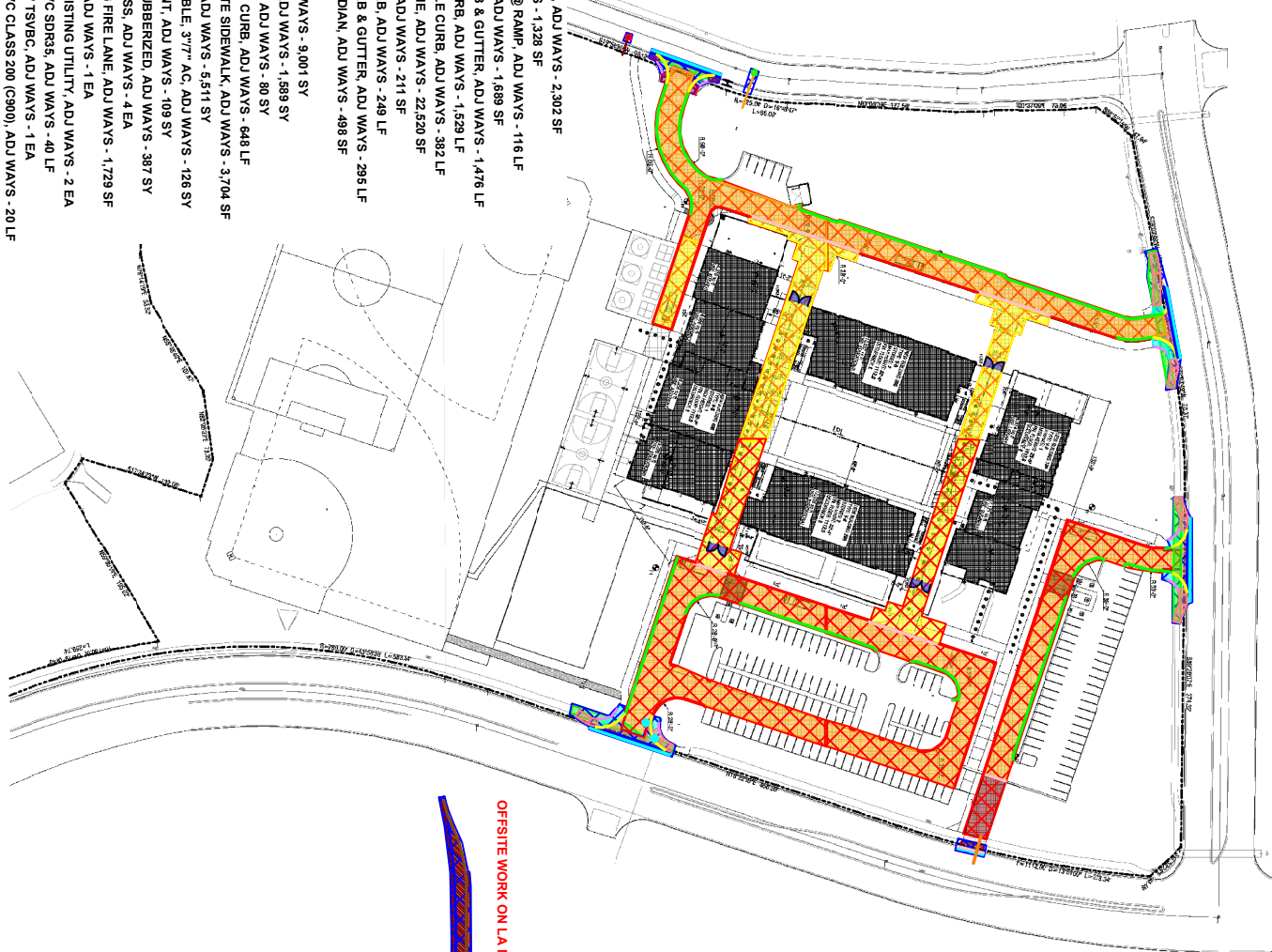

OFFSITE WORK ON LA MARIONA DRIVE



OFFSITE LEGEND

- 9 - LAIR TRUCK CURB
- 10 - LAIR TRUCK CONC
- 11 - LAIR TRUCK CONC
- 12 - LAIR TRUCK CONC
- 13 - LAIR TRUCK CONC
- 14 - LAIR TRUCK CONC
- 15 - LAIR TRUCK CONC
- 16 - LAIR TRUCK CONC
- 17 - LAIR TRUCK CONC
- 18 - LAIR TRUCK CONC
- 19 - LAIR TRUCK CONC
- 20 - LAIR TRUCK CONC
- 21 - LAIR TRUCK CONC
- 22 - LAIR TRUCK CONC
- 23 - LAIR TRUCK CONC
- 24 - LAIR TRUCK CONC
- 25 - LAIR TRUCK CONC
- 26 - LAIR TRUCK CONC
- 27 - LAIR TRUCK CONC
- 28 - LAIR TRUCK CONC
- 29 - LAIR TRUCK CONC
- 30 - LAIR TRUCK CONC
- 31 - LAIR TRUCK CONC
- 32 - LAIR TRUCK CONC
- 33 - LAIR TRUCK CONC

PROJECT GENERAL NOTES

1. CONTRACTOR SHALL VERIFY ALL EXISTING UTILITIES BEFORE ANY CONSTRUCTION BEGINS.
2. THE CONTRACTOR SHALL MAINTAIN ALL EXISTING UTILITIES AT ALL TIMES.
3. ALL UTILITIES SHALL BE DEEPLY REPAIRED AND RESTORED TO ORIGINAL CONDITION.
4. THE CONTRACTOR SHALL MAINTAIN ACCESS TO ALL UTILITIES AT ALL TIMES.
5. ALL UTILITIES SHALL BE PROTECTED AND SUPPORTED AT ALL TIMES.
6. THE CONTRACTOR SHALL MAINTAIN ALL EXISTING UTILITIES AT ALL TIMES.
7. ALL UTILITIES SHALL BE DEEPLY REPAIRED AND RESTORED TO ORIGINAL CONDITION.
8. THE CONTRACTOR SHALL MAINTAIN ACCESS TO ALL UTILITIES AT ALL TIMES.
9. ALL UTILITIES SHALL BE PROTECTED AND SUPPORTED AT ALL TIMES.
10. THE CONTRACTOR SHALL MAINTAIN ALL EXISTING UTILITIES AT ALL TIMES.
11. ALL UTILITIES SHALL BE DEEPLY REPAIRED AND RESTORED TO ORIGINAL CONDITION.
12. THE CONTRACTOR SHALL MAINTAIN ACCESS TO ALL UTILITIES AT ALL TIMES.
13. ALL UTILITIES SHALL BE PROTECTED AND SUPPORTED AT ALL TIMES.
14. THE CONTRACTOR SHALL MAINTAIN ALL EXISTING UTILITIES AT ALL TIMES.
15. ALL UTILITIES SHALL BE DEEPLY REPAIRED AND RESTORED TO ORIGINAL CONDITION.
16. THE CONTRACTOR SHALL MAINTAIN ACCESS TO ALL UTILITIES AT ALL TIMES.
17. ALL UTILITIES SHALL BE PROTECTED AND SUPPORTED AT ALL TIMES.
18. THE CONTRACTOR SHALL MAINTAIN ALL EXISTING UTILITIES AT ALL TIMES.
19. ALL UTILITIES SHALL BE DEEPLY REPAIRED AND RESTORED TO ORIGINAL CONDITION.
20. THE CONTRACTOR SHALL MAINTAIN ACCESS TO ALL UTILITIES AT ALL TIMES.
21. ALL UTILITIES SHALL BE PROTECTED AND SUPPORTED AT ALL TIMES.
22. THE CONTRACTOR SHALL MAINTAIN ALL EXISTING UTILITIES AT ALL TIMES.
23. ALL UTILITIES SHALL BE DEEPLY REPAIRED AND RESTORED TO ORIGINAL CONDITION.
24. THE CONTRACTOR SHALL MAINTAIN ACCESS TO ALL UTILITIES AT ALL TIMES.
25. ALL UTILITIES SHALL BE PROTECTED AND SUPPORTED AT ALL TIMES.
26. THE CONTRACTOR SHALL MAINTAIN ALL EXISTING UTILITIES AT ALL TIMES.
27. ALL UTILITIES SHALL BE DEEPLY REPAIRED AND RESTORED TO ORIGINAL CONDITION.
28. THE CONTRACTOR SHALL MAINTAIN ACCESS TO ALL UTILITIES AT ALL TIMES.
29. ALL UTILITIES SHALL BE PROTECTED AND SUPPORTED AT ALL TIMES.
30. THE CONTRACTOR SHALL MAINTAIN ALL EXISTING UTILITIES AT ALL TIMES.
31. ALL UTILITIES SHALL BE DEEPLY REPAIRED AND RESTORED TO ORIGINAL CONDITION.
32. THE CONTRACTOR SHALL MAINTAIN ACCESS TO ALL UTILITIES AT ALL TIMES.
33. ALL UTILITIES SHALL BE PROTECTED AND SUPPORTED AT ALL TIMES.

TYPICAL SWANSON LEGEND

- 1 - SWANSON LEGEND
- 2 - SWANSON LEGEND
- 3 - SWANSON LEGEND
- 4 - SWANSON LEGEND
- 5 - SWANSON LEGEND
- 6 - SWANSON LEGEND
- 7 - SWANSON LEGEND
- 8 - SWANSON LEGEND
- 9 - SWANSON LEGEND
- 10 - SWANSON LEGEND
- 11 - SWANSON LEGEND
- 12 - SWANSON LEGEND
- 13 - SWANSON LEGEND
- 14 - SWANSON LEGEND
- 15 - SWANSON LEGEND
- 16 - SWANSON LEGEND
- 17 - SWANSON LEGEND
- 18 - SWANSON LEGEND
- 19 - SWANSON LEGEND
- 20 - SWANSON LEGEND
- 21 - SWANSON LEGEND
- 22 - SWANSON LEGEND
- 23 - SWANSON LEGEND
- 24 - SWANSON LEGEND
- 25 - SWANSON LEGEND
- 26 - SWANSON LEGEND
- 27 - SWANSON LEGEND
- 28 - SWANSON LEGEND
- 29 - SWANSON LEGEND
- 30 - SWANSON LEGEND
- 31 - SWANSON LEGEND
- 32 - SWANSON LEGEND
- 33 - SWANSON LEGEND

DEFERRED SUBMITTALS

1. ALL DEFERRED SUBMITTALS SHALL BE SUBMITTED BY THE CONTRACTOR.
2. ALL DEFERRED SUBMITTALS SHALL BE REVIEWED BY THE ARCHITECT.
3. ALL DEFERRED SUBMITTALS SHALL BE APPROVED BY THE ARCHITECT.
4. ALL DEFERRED SUBMITTALS SHALL BE SUBMITTED TO THE ARCHITECT.
5. ALL DEFERRED SUBMITTALS SHALL BE REVIEWED BY THE ARCHITECT.
6. ALL DEFERRED SUBMITTALS SHALL BE APPROVED BY THE ARCHITECT.
7. ALL DEFERRED SUBMITTALS SHALL BE SUBMITTED TO THE ARCHITECT.
8. ALL DEFERRED SUBMITTALS SHALL BE REVIEWED BY THE ARCHITECT.
9. ALL DEFERRED SUBMITTALS SHALL BE APPROVED BY THE ARCHITECT.
10. ALL DEFERRED SUBMITTALS SHALL BE SUBMITTED TO THE ARCHITECT.
11. ALL DEFERRED SUBMITTALS SHALL BE REVIEWED BY THE ARCHITECT.
12. ALL DEFERRED SUBMITTALS SHALL BE APPROVED BY THE ARCHITECT.
13. ALL DEFERRED SUBMITTALS SHALL BE SUBMITTED TO THE ARCHITECT.
14. ALL DEFERRED SUBMITTALS SHALL BE REVIEWED BY THE ARCHITECT.
15. ALL DEFERRED SUBMITTALS SHALL BE APPROVED BY THE ARCHITECT.
16. ALL DEFERRED SUBMITTALS SHALL BE SUBMITTED TO THE ARCHITECT.
17. ALL DEFERRED SUBMITTALS SHALL BE REVIEWED BY THE ARCHITECT.
18. ALL DEFERRED SUBMITTALS SHALL BE APPROVED BY THE ARCHITECT.
19. ALL DEFERRED SUBMITTALS SHALL BE SUBMITTED TO THE ARCHITECT.
20. ALL DEFERRED SUBMITTALS SHALL BE REVIEWED BY THE ARCHITECT.
21. ALL DEFERRED SUBMITTALS SHALL BE APPROVED BY THE ARCHITECT.
22. ALL DEFERRED SUBMITTALS SHALL BE SUBMITTED TO THE ARCHITECT.
23. ALL DEFERRED SUBMITTALS SHALL BE REVIEWED BY THE ARCHITECT.
24. ALL DEFERRED SUBMITTALS SHALL BE APPROVED BY THE ARCHITECT.
25. ALL DEFERRED SUBMITTALS SHALL BE SUBMITTED TO THE ARCHITECT.
26. ALL DEFERRED SUBMITTALS SHALL BE REVIEWED BY THE ARCHITECT.
27. ALL DEFERRED SUBMITTALS SHALL BE APPROVED BY THE ARCHITECT.
28. ALL DEFERRED SUBMITTALS SHALL BE SUBMITTED TO THE ARCHITECT.
29. ALL DEFERRED SUBMITTALS SHALL BE REVIEWED BY THE ARCHITECT.
30. ALL DEFERRED SUBMITTALS SHALL BE APPROVED BY THE ARCHITECT.
31. ALL DEFERRED SUBMITTALS SHALL BE SUBMITTED TO THE ARCHITECT.
32. ALL DEFERRED SUBMITTALS SHALL BE REVIEWED BY THE ARCHITECT.
33. ALL DEFERRED SUBMITTALS SHALL BE APPROVED BY THE ARCHITECT.

SPECIAL INSPECTIONS

1. ALL SPECIAL INSPECTIONS SHALL BE CONDUCTED BY THE CONTRACTOR.
2. ALL SPECIAL INSPECTIONS SHALL BE REVIEWED BY THE ARCHITECT.
3. ALL SPECIAL INSPECTIONS SHALL BE APPROVED BY THE ARCHITECT.
4. ALL SPECIAL INSPECTIONS SHALL BE CONDUCTED BY THE CONTRACTOR.
5. ALL SPECIAL INSPECTIONS SHALL BE REVIEWED BY THE ARCHITECT.
6. ALL SPECIAL INSPECTIONS SHALL BE APPROVED BY THE ARCHITECT.
7. ALL SPECIAL INSPECTIONS SHALL BE CONDUCTED BY THE CONTRACTOR.
8. ALL SPECIAL INSPECTIONS SHALL BE REVIEWED BY THE ARCHITECT.
9. ALL SPECIAL INSPECTIONS SHALL BE APPROVED BY THE ARCHITECT.
10. ALL SPECIAL INSPECTIONS SHALL BE CONDUCTED BY THE CONTRACTOR.
11. ALL SPECIAL INSPECTIONS SHALL BE REVIEWED BY THE ARCHITECT.
12. ALL SPECIAL INSPECTIONS SHALL BE APPROVED BY THE ARCHITECT.
13. ALL SPECIAL INSPECTIONS SHALL BE CONDUCTED BY THE CONTRACTOR.
14. ALL SPECIAL INSPECTIONS SHALL BE REVIEWED BY THE ARCHITECT.
15. ALL SPECIAL INSPECTIONS SHALL BE APPROVED BY THE ARCHITECT.
16. ALL SPECIAL INSPECTIONS SHALL BE CONDUCTED BY THE CONTRACTOR.
17. ALL SPECIAL INSPECTIONS SHALL BE REVIEWED BY THE ARCHITECT.
18. ALL SPECIAL INSPECTIONS SHALL BE APPROVED BY THE ARCHITECT.
19. ALL SPECIAL INSPECTIONS SHALL BE CONDUCTED BY THE CONTRACTOR.
20. ALL SPECIAL INSPECTIONS SHALL BE REVIEWED BY THE ARCHITECT.
21. ALL SPECIAL INSPECTIONS SHALL BE APPROVED BY THE ARCHITECT.
22. ALL SPECIAL INSPECTIONS SHALL BE CONDUCTED BY THE CONTRACTOR.
23. ALL SPECIAL INSPECTIONS SHALL BE REVIEWED BY THE ARCHITECT.
24. ALL SPECIAL INSPECTIONS SHALL BE APPROVED BY THE ARCHITECT.
25. ALL SPECIAL INSPECTIONS SHALL BE CONDUCTED BY THE CONTRACTOR.
26. ALL SPECIAL INSPECTIONS SHALL BE REVIEWED BY THE ARCHITECT.
27. ALL SPECIAL INSPECTIONS SHALL BE APPROVED BY THE ARCHITECT.
28. ALL SPECIAL INSPECTIONS SHALL BE CONDUCTED BY THE CONTRACTOR.
29. ALL SPECIAL INSPECTIONS SHALL BE REVIEWED BY THE ARCHITECT.
30. ALL SPECIAL INSPECTIONS SHALL BE APPROVED BY THE ARCHITECT.
31. ALL SPECIAL INSPECTIONS SHALL BE CONDUCTED BY THE CONTRACTOR.
32. ALL SPECIAL INSPECTIONS SHALL BE REVIEWED BY THE ARCHITECT.
33. ALL SPECIAL INSPECTIONS SHALL BE APPROVED BY THE ARCHITECT.

ABBREVIATIONS LIST:

NO.	ABBREVIATION	MEANING
1	AC	ASPH/CON
2	AD	ADJUSTED
3	AS	ASPH/CON
4	BR	BROOK
5	CA	CONCRETE
6	CG	CONCRETE
7	CH	CONCRETE
8	CL	CONCRETE
9	CM	CONCRETE
10	CO	CONCRETE
11	CP	CONCRETE
12	CQ	CONCRETE
13	CS	CONCRETE
14	CT	CONCRETE
15	CV	CONCRETE
16	CW	CONCRETE
17	CX	CONCRETE
18	CY	CONCRETE
19	CZ	CONCRETE
20	DA	CONCRETE
21	DB	CONCRETE
22	DC	CONCRETE
23	DD	CONCRETE
24	DE	CONCRETE
25	DF	CONCRETE
26	DG	CONCRETE
27	DH	CONCRETE
28	DI	CONCRETE
29	DJ	CONCRETE
30	DK	CONCRETE
31	DL	CONCRETE
32	DM	CONCRETE
33	DN	CONCRETE

LITCHFIELD ELEMENTARY SCHOOL DISTRICT
Litchfield School 16
 1801 W CAMPBELL AVE., GOODYEAR, AZ 85396

orcutt | winslow
 ARCHITECTS
 1801 W CAMPBELL AVE., SUITE 200
 GOODYEAR, AZ 85396
 PH: 928.289.9200
 WWW.OWA.COM

PROJECT NO. 2016_277
 SHEET NO. G-002

DATE OF ISSUE 04.02.2018

PROJECT TITLE LITCHFIELD ELEMENTARY SCHOOL 16

PROJECT LOCATION 1801 W CAMPBELL AVE., GOODYEAR, AZ 85396

ARCHITECT ORCUTT | WINSLLOW

PROJECT MANAGER BILL GOWEN

GENERAL REQUIREMENTS - SITE CODE PLAN