

© Copyright, 2019, HILGARTWILSON, LLC. - This plan government seal is the sole property of HILGARTWILSON, LLC. No alterations to these plans, other than those indicated, shall be made without the written approval of HILGARTWILSON, LLC employees.

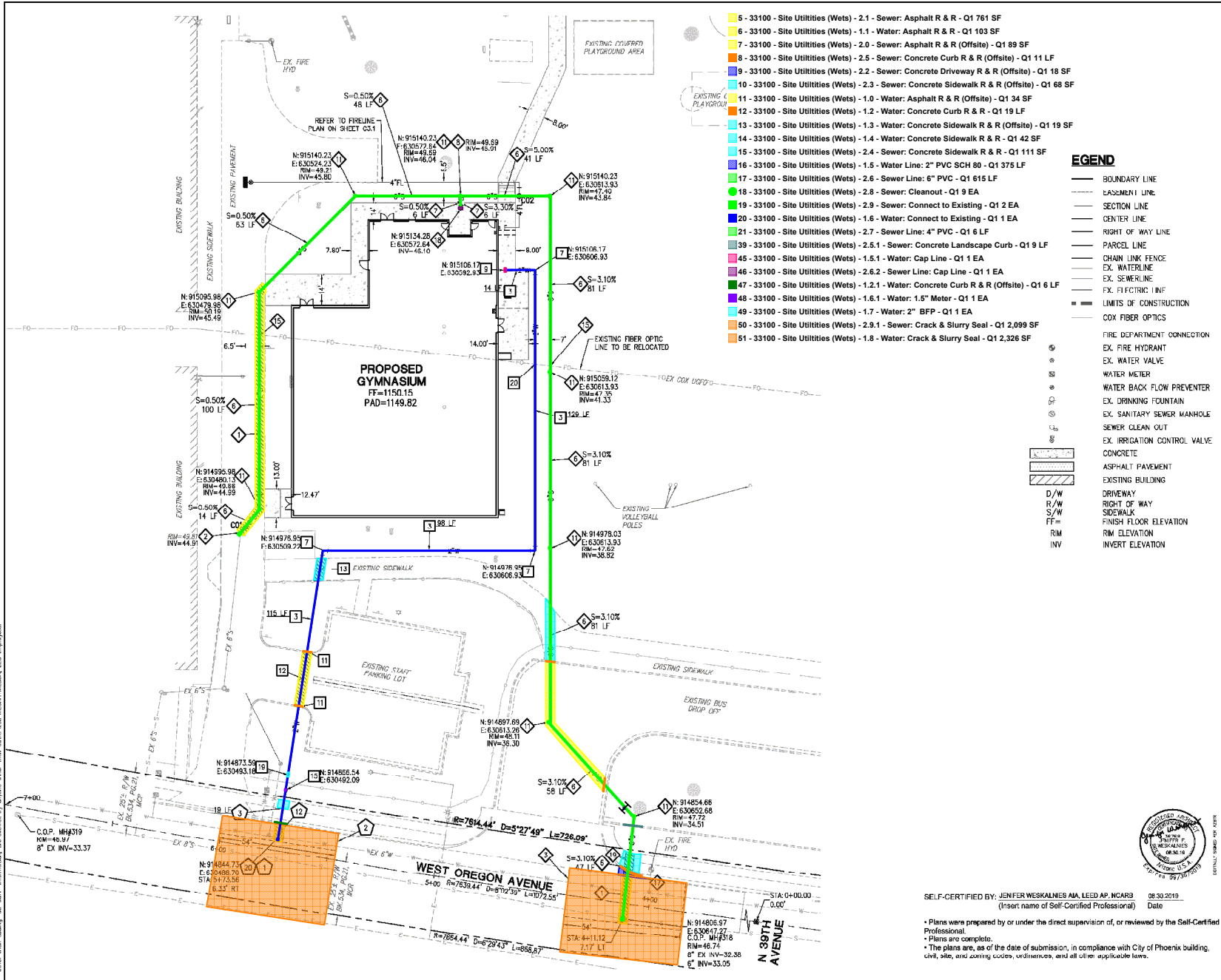

- 5 - 33100 - Site Utilities (Wets) - 2.1 - Sewer: Asphalt R & R - Q1 761 SF
- 6 - 33100 - Site Utilities (Wets) - 1.1 - Water: Asphalt R & R - Q1 103 SF
- 7 - 33100 - Site Utilities (Wets) - 2.0 - Sewer: Asphalt R & R (Offsite) - Q1 89 SF
- 8 - 33100 - Site Utilities (Wets) - 2.5 - Sewer: Concrete Curb R & R (Offsite) - Q1 11 LF
- 9 - 33100 - Site Utilities (Wets) - 2.2 - Sewer: Concrete Driveway R & R (Offsite) - Q1 18 SF
- 10 - 33100 - Site Utilities (Wets) - 2.3 - Sewer: Concrete Sidewalk R & R (Offsite) - Q1 68 SF
- 11 - 33100 - Site Utilities (Wets) - 1.0 - Water: Asphalt R & R (Offsite) - Q1 34 SF
- 12 - 33100 - Site Utilities (Wets) - 1.2 - Water: Concrete Curb R & R - Q1 34 SF
- 13 - 33100 - Site Utilities (Wets) - 1.3 - Water: Concrete Sidewalk R & R (Offsite) - Q1 19 LF
- 14 - 33100 - Site Utilities (Wets) - 1.4 - Water: Concrete Sidewalk R & R - Q1 42 SF
- 15 - 33100 - Site Utilities (Wets) - 2.4 - Sewer: Concrete Sidewalk R & R - Q1 111 SF
- 16 - 33100 - Site Utilities (Wets) - 1.5 - Water Line: 2" PVC SCH 80 - Q1 375 LF
- 17 - 33100 - Site Utilities (Wets) - 2.6 - Sewer Line: 6" PVC - Q1 615 LF
- 18 - 33100 - Site Utilities (Wets) - 2.8 - Sewer: Cleanout - Q1 9 EA
- 19 - 33100 - Site Utilities (Wets) - 2.9 - Sewer: Connect to Existing - Q1 2 EA
- 20 - 33100 - Site Utilities (Wets) - 1.6 - Water: Connect to Existing - Q1 1 EA
- 21 - 33100 - Site Utilities (Wets) - 2.7 - Sewer Line: 4" PVC - Q1 6 LF
- 29 - 33100 - Site Utilities (Wets) - 2.5.1 - Sewer: Concrete Landscape Curb - Q1 9 LF
- 45 - 33100 - Site Utilities (Wets) - 1.5.1 - Water: Cap Line - Q1 1 EA
- 46 - 33100 - Site Utilities (Wets) - 2.6.2 - Sewer Line: Cap Line - Q1 1 EA
- 47 - 33100 - Site Utilities (Wets) - 1.2.1 - Water: Concrete Curb R & R (Offsite) - Q1 6 LF
- 48 - 33100 - Site Utilities (Wets) - 1.6.1 - Water: 1.5" Meter - Q1 1 EA
- 49 - 33100 - Site Utilities (Wets) - 1.7 - Water: 2" BFP - Q1 1 EA
- 50 - 33100 - Site Utilities (Wets) - 2.9.1 - Sewer: Crack & Slurry Seal - Q1 2,099 SF
- 51 - 33100 - Site Utilities (Wets) - 1.8 - Water: Crack & Slurry Seal - Q1 2,326 SF

LEGEND

- BOUNDARY LINE
- EASEMENT LINE
- - - SECTION LINE
- CENTER LINE
- RIGHT OF WAY LINE
- PARCEL LINE
- CHAIN LINK FENCE
- EX. WATERLINE
- EX. SEWERLINE
- EX. FIRE HYDRANT
- EX. WATER VALVE
- EX. WATER METER
- EX. WATER BACK FLOW PREVENTER
- EX. DRINKING FOUNTAIN
- EX. SANITARY SEWER MANHOLE
- EX. SEWER CLEAN OUT
- EX. IRRIGATION CONTROL VALVE
- CONCRETE
- ASPHALT PAVEMENT
- EXISTING BUILDING
- EXISTING WATER CONSTRUCTION NOTES
- 1 — CONNECT TO EXISTING WATERLINE. CONTRACTOR TO VERIFY LOCATION PRIOR TO CONSTRUCTION AND NOTIFY ENGINEER OF ANY DISCREPANCIES.
- 2 — CRACK ON SLURRY SEAL 25 FEET BEFORE AND AFTER EDGE OF TRENCH.
- 3 — INSTALL 2" PVC SCH 80 WATER LINE PER 2012 IPC.
- 4 — SAWCUT, REMOVE AND REPLACE EXISTING PARALLEL EX. MAG SPEC 336 AND C.O.P. DTL P-1200 TYPE B OR REPLACE IN KIND, WHICHEVER IS GREATER.
- 5 — CRACK ON SLURRY SEAL 25 FEET BEFORE AND AFTER EDGE OF TRENCH.
- 6 — INSTALL 6" PVC (SDR 35) SEWER PIPE PER 2012 IPC. (LENGTH AND SLOPE AS SHOWN).
- 7 — INSTALL 4" PVC (SDR 35) SEWER PIPE PER 2012 IPC. (LENGTH AND SLOPE AS SHOWN).
- 8 — INSTALL 6" X 4" BUILDING CONNECTION PER MAG STD DTL 440-1, TYPE A.
- 9 — INSTALL CLEANOUT PER 2012 IPC.
- 10 — CAUTION: EX. UNDERGROUND UTILITY. CONTRACTOR TO VERIFY LOCATION AND DEPTH PRIOR TO TRENCHING.
- 11 — SAWCUT, REMOVE AND REPLACE EXISTING CONCRETE CURB.
- 12 — INSTALL SEWER CAP.
- 13 — OFFSITE WATER CONSTRUCTION NOTES
- 14 — CONNECT TO EXISTING WATERLINE. CONTRACTOR TO VERIFY LOCATION PRIOR TO CONSTRUCTION AND NOTIFY ENGINEER OF ANY DISCREPANCIES.
- 15 — CRACK ON SLURRY SEAL 25 FEET BEFORE AND AFTER EDGE OF TRENCH.
- 16 — INSTALL 2" PVC SCH 80 WATER LINE PER 2012 IPC.
- 17 — SAWCUT, REMOVE AND REPLACE EXISTING PARALLEL EX. MAG SPEC 336 AND C.O.P. DTL P-1200 TYPE B OR REPLACE IN KIND, WHICHEVER IS GREATER.
- 18 — INSTALL WATER SERVICE CONNECTIONS PER C.O.P. DTL 913-2.

WATER CONSTRUCTION NOTES

5	INSTALL 2" PVC SCH 80 WATER LINE PER 2012 IPC.	356 LF
7	INSTALL 2" X 90 BEND	3 EA
8	INSTALL 2" WATER LINE CAP. SEE PLUMBING PLANS FOR CONNECTIONS.	1 EA
11	SAWCUT, REMOVE AND REPLACE EXISTING CURB	8 LF
12	SAWCUT, REMOVE AND REPLACE EXISTING PARALLEL EX. MAG SPEC 336 AND C.O.P. DTL P-1200 TYPE B OR REPLACE IN KIND, WHICHEVER IS GREATER.	11 SY
13	SAWCUT, REMOVE AND REPLACE EXISTING SIDEWALK PER MAG SPEC 336 AND C.O.P. DTL P-1200 TYPE C OR REPLACE IN KIND, WHICHEVER IS GREATER.	5 LF
15	INSTALL 1.5" WATER METER PER C.O.P. DTL P-1315 & P-1363 CONNECT 2" WATER SERVICE PER C.O.P. DTL-1342 & MAG SPEC 831.	1 EA
19	INSTALL 2" BACKFLOW PREVENTION ASSEMBLY	1 EA
20	CAUTION: EX. UNDERGROUND UTILITY. CONTRACTOR TO VERIFY LOCATION AND DEPTH PRIOR TO TRENCHING.	1 EA

SEWER CONSTRUCTION NOTES

1	CONNECT TO EXISTING SEWER LINE PER MAG STD DTL 440-1. CONTRACTOR TO VERIFY INVERT AND LOCATION PRIOR TO CONSTRUCTION AND NOTIFY ENGINEER OF ANY DISCREPANCIES.	1 EA
2	CRACK ON SLURRY SEAL 25 FEET BEFORE AND AFTER EDGE OF TRENCH.	1 EA
3	INSTALL 2" PVC SCH 80 WATER LINE PER 2012 IPC.	19 LF
4	SAWCUT, REMOVE AND REPLACE EXISTING PARALLEL EX. MAG SPEC 336 AND C.O.P. DTL P-1200 TYPE B OR REPLACE IN KIND, WHICHEVER IS GREATER.	4 SY
5	CRACK ON SLURRY SEAL 25 FEET BEFORE AND AFTER EDGE OF TRENCH.	1 EA
6	INSTALL 6" PVC (SDR 35) SEWER PIPE PER 2012 IPC. (LENGTH AND SLOPE AS SHOWN).	614 LF
7	INSTALL 4" PVC (SDR 35) SEWER PIPE PER 2012 IPC. (LENGTH AND SLOPE AS SHOWN).	12 LF
8	INSTALL 6" X 4" BUILDING CONNECTION PER MAG STD DTL 440-1, TYPE A.	1 EA
9	INSTALL CLEANOUT PER 2012 IPC.	9 EA
10	CAUTION: EX. UNDERGROUND UTILITY. CONTRACTOR TO VERIFY LOCATION AND DEPTH PRIOR TO TRENCHING.	2 EA
11	SAWCUT, REMOVE AND REPLACE EXISTING CONCRETE CURB.	4 LF
12	INSTALL SEWER CAP.	1 EA

Professional Engineer Seal for Jenifer Weskalmes, No. 61773, State of Arizona, dated 09/30/2019.

SCALE: 1" = 20'

DATE: SEP 2019

NEW SEVILLA WEST ELEMENTARY SCHOOL GYMNASIUM ADDITION
 3851 W. MISSOURI AVENUE PHOENIX, ARIZONA

UTILITY PLAN

PROJ. NO.	2128
DATE	SEP 2019
SCALE	1" = 20'
DESIGNED BY	MH
DRAWN BY	RC
APPROVED BY	SO
REV.	

DWG. NO. **C2.1**

SHT. 2 OF 2

SELF-CERTIFIED BY: JENIFER WESKALMES, No. 61773, State of Arizona, dated 09/30/2019.
 (Insert name of Self-Certified Professional) Date

Plans were prepared by or under the direct supervision of, or reviewed by the Self-Certified Professional.
 Plans are complete.
 The plans are, as of the date of submission, in compliance with City of Phoenix building, civil, site, and zoning codes, ordinances, and all other applicable laws.