



A Division of The Hiller Companies, Inc.

3107 West Virginia Avenue, Phoenix, Arizona 85009-1870
(888) 222-0532 (O) | (602) 433-9626 (F) | americanfire.com
CR67#312768 | CR16#312769

March 28, 2018

Casa Grande Elementary School District

Mr. Dennis York Purchasing Director

Project: Cholla Elementary School Fire Alarm Replacement
1180 E Kortsen Rd.
Casa Grande, Arizona 85122

American Fire's Quote: \$85,565.00 (includes Tax and Shipping)

Inclusions:

Complete fire alarm system Design and Permit (State Fire Marshal)
Provide all Notifier fire alarm equipment to provide Full Coverage Smoke Detection
Provide Campus Wide Voice Communications including WP Outside Speaker Devices
Provide Fire Alarm wire, boxes, J-Hooks as needed.
Provide all fire alarm terminations
Provide all fire alarm system programming
Provide final test with AHJ
Provide 2 Year Warranty
Provide Demo of existing Fire Alarm system and provide Blank Covers as needed.

Exclusions:

Performance Bond
Lift Rental

We assume **that all existing underground conduits** shall be utilized to perform our scope of work and be to be reused to pull new underground rated cable.



A Division of The Hiller Companies, Inc.

3107 West Virginia Avenue, Phoenix, Arizona 85009-1870
(888) 222-0532 (O) | (602) 433-9626 (F) | americanfire.com
CR67#312768 | CR16#312769

Notifier Fire Alarm Addressable system with Voice Communications

CPU2-640 Panel (1) Loop and NFC-50100 Voice Panel

| | | |
|-----|-------------|---|
| 1 | CPU2-640 | NFS2-640 Central Processing Unit with Chassis |
| 1 | KDM-R2 | NFS2-640 Primary Display--80 Character |
| 1 | DR-C4 | Door, Lock, & keys--3 chassis-black |
| 1 | SBB-C4 | Backbox 3 chassis black |
| 1 | CHS-4L | Chassis low profile |
| 6 | PC-1270 | 12 Volt 7.0 AH Battery |
| 6 | PC-12180F | 12 Volt 18.0 AH Battery |
| 1 | DP-1B | Blank Plate |
| 1 | FDU-80 | 80 Character LCD annunciator "Security Keypad" |
| 1 | UDACT-2 | Universal Digital Communicator Transmitter-2 |
| 2 | MO-SETULR2 | RJ-31X Jack and cord for dialer |
| 110 | FSP-851 | Addressable Photo detector |
| 2 | FSB-200 | Addressable Beam Detector |
| 10 | FST-851R | Addressable Rate-of-Rise Thermal detector |
| 1 | NBG-12LX | Addressable pull station |
| 8 | FDM-1 | Addressable dual Monitor Module |
| 4 | FCM-1 | Addressable Control Module (NAC circuits) |
| 4 | FRM-1 | Addressable relay module |
| 110 | B210LP | Detector base w/ flange |
| 1 | NFC-50/100 | Main Unit, 50 watts (25v), 1 Class A/B speaker circuit, 120VAC Black |
| 1 | NFC-BDA-25V | Amplifier for a second speaker circuit, or backup, 50 watts (25V) |
| 1 | TR-CE-B | Trim Ring used with NFC-50/100, NFC-LOC and NFC-FFT, Black |
| 1 | NFC-50DA | Distributed Amplifier, 50 Watts (25v or 70V), 4 Class A/B speaker circuits, 120VAC, Black |
| 16 | SPCWL | SPEAKER WHITE CEILING |
| 76 | SPSCWL | SPEAKER STROBE WHITE CEILING |
| 40 | SWL | STROBE WHITE WALL |
| 12 | SPRK | Wall, Outdoor, Red, Speaker only |
| 3 | FCPS-24S6 | 6 AMP Power Supply |
| 3 | ZNAC-4 | Class A NAC module for FCPS-24 & 2408 |
| 2 | E120V-GT | 120 VAC Surge Suppressor for primary power (Space Age) |
| 2 | SLCP-30 | SLC Loop Surge Suppressor (need to add PCB1B-WKEY) |



A Division of The Hiller Companies, Inc.

3107 West Virginia Avenue, Phoenix, Arizona 85009-1870
(888) 222-0532 (O) | (602) 433-9626 (F) | americanfire.com
CR67#312768 | CR16#312769

TERMS AND CONDITIONS: From American Fire Equipment, A Division of the Hiller Companies,

1. Acceptance. These terms and conditions shall become a binding contract between the Buyer and Hiller upon authorization of work by the Buyer.

2. Limitation of Liability; Insurance & Indemnity; Limited Warranty. It is understood and agreed by Customer that Hiller is not an insurer, and that insurance coverage shall specifically be the obligation of Customer to purchase and amounts payable to Hiller hereunder are based upon the value of services and scope of liability as herein set forth and are unrelated to the value of the Customer's property and the property of others located on the premises. Customer agrees to look exclusively to Customer's insurer to recover from loss, damage or injury due directly or indirectly to occurrences or consequences therefrom, which the service or system is designed to detect, avert or prevent.

The Customer agrees that Hiller shall be exempt from any liability for loss, damage or injury due directly or indirectly to occurrences, or consequences therefrom which the service or system is designed to detect, avert or prevent. That if Hiller should be found liable for loss, damage or injury due to a failure of service or equipment in any respect, its liability shall be limited to a sum equal to the service price (as increased by the price for any additional work) or where the service for time and material, Customer's time and material payments to Hiller, as the agreed upon maximum damages. Where the inspection herein covers multiple sites, liability shall be limited to the amount of payments allocable to the site where the incident occurred. Such sum shall be complete and exclusive. If Customer desires Hiller to assume greater liability, the parties shall amend this agreement herein by attaching a rider setting forth the amount of additional liability and the additional amount payable by the Customer for the assumption by Hiller of such greater liability provided.

In the event any person not a party to this agreement, shall make any claim or file any lawsuit against Hiller for failure of its equipment or service in any respect, Customer agrees to indemnify and hold Hiller harmless from any and all such claims and lawsuits including the payment of all damages, expenses, costs and attorneys' fees.

So far as it is permitted by Customer's property insurance coverage, Customer hereby releases, discharges and agrees to hold Hiller harmless from any and all claims, liabilities, damages, losses or expenses, arising from or caused by any hazard covered by insurance in or on the Customer's premises whether said claims are made by Customer, Customer's agents or Customer's insurance company or other parties claiming under or through Customer. Customer agrees to indemnify Hiller against and defend and hold Hiller harmless from any action from subrogation which may be brought against Hiller



A Division of The Hiller Companies, Inc.

3107 West Virginia Avenue, Phoenix, Arizona 85009-1870
(888) 222-0532 (O) | (602) 433-9626 (F) | americanfire.com
CR67#312768 | CR16#312769

by any insurer or insurance company or its agents, including the payment of all damages, expenses, costs and attorneys' fees. It is further agreed that the Limitation on Liability and the obligations of the Customer, set forth herein, shall inure to the benefit of and apply to all parent, subsidiary and affiliates of Hiller, whether direct or indirect, Hiller's employees, officers and directors.

1. No Guarantee. Fire Suppression and Detection, Extinguisher and Sprinkler Systems, hereinafter "Fire Systems" are a significant help in reducing property loss and injury. However, Customer acknowledges no matter how good any Fire System is, nothing works perfectly under every circumstance and The Hiller Companies, Inc. must warn Customer that Customer cannot expect a Fire System to insure that Customer will never suffer any damage or injury. Hiller makes no Guarantee of the work of any parties outside of Hiller.

2. Customer Responsibilities.

Customer agrees that Customer will instruct all persons who may use the Fire System on its proper use. If Customer finds problems then it is their responsibility to notify Hiller and schedule a service call for which there will be a charge. Any changes to the layout of equipment may affect the operation of the Fire System, and Customer agrees to notify The Hiller Companies, Inc. immediately of any aforementioned changes to schedule a service call for which there will be a charge. 1. General. Unless otherwise specified, work shall be done between the hours of 8:00 AM and 5:00 PM, exclusive of Saturdays, Sundays and Hiller Holidays. Hiller shall not be responsible for failure to render services due to causes beyond its control, including but not limited to material shortages, work stoppages, fires, civil disobediences or unrest, severe weather or any other cause beyond the control of Hiller. Proposal valid for 60 Days.

TERMS are COD or Net 30 upon approved credit by the Hiller credit department. A finance charge of 1.5% will be applied to invoices that are not paid within 31-45 days of receipt and 3% will be applied four unpaid invoices received greater than 45 days without being paid. All lifting equipment (including man lift and cranes) is the responsibility of the Customer unless otherwise stated. Customer agrees that any representation, promise, condition, inducement or warranty, Express or Implied, not included in writing herein shall not be binding upon any party, and that the Terms and Conditions hereof apply as printed without alteration or qualification, except as specifically modified in writing. The Terms and Conditions herein shall govern notwithstanding any inconsistent or additional terms and conditions or any purchase order or other document submitted by the customer. Customer agrees this Agreement and the Terms and Conditions herein shall be governed by the Laws of the State of Arizona, United States of America.



A Division of The Hiller Companies, Inc.

3107 West Virginia Avenue, Phoenix, Arizona 85009-1870
(888) 222-0532 (O) | (602) 433-9626 (F) | americanfire.com
CR67#312768 | CR16#312769

We appreciate your interest in American Fire Equipment and look forward to working with you on this project.

Please do not hesitate to contact me with any questions regarding this proposal.

Best Regards:

Mitch Dubin
American Fire Equipment

Proposal Accepted By: _____

Date: _____

NFS2-640(E)

Intelligent Addressable Fire Alarm System



Intelligent Fire Alarm Control Panels

General

The NFS2-640 intelligent Fire Alarm Control Panel is part of the ONYX® Series of Fire Alarm Controls from NOTIFIER.

In stand-alone or network configurations, ONYX Series products meet virtually every application requirement.

The NFS2-640's modular design makes system planning easier. The panel can be configured with just a few devices for small building applications, or networked with many devices to protect a large campus or a high-rise office block. Simply add additional peripheral equipment to suit the application.

A host of other options are available, including single- or multi-channel voice; firefighter's telephone; LED, LCD, or PC-based graphic annunciators; networking; advanced detection products for challenging environments; wireless fire protection; and many additional options.

NOTE: Unless called out with a version-specific "E" at the end of the part number, "NFS2-640" refers to models NFS2-640 and NFS2-640E; similarly, "CPU2-640" refers to models CPU2-640 and CPU2-640E.

Features

- Certified for seismic applications when used with the appropriate seismic mounting kit.
- Approved for Marine applications when used with listed compatible equipment. See DN-60688.
- One, expandable to two, isolated intelligent Signaling Line Circuit (SLC) Style 4, 6 or 7.
- Wireless fire protection using SWIFT Smart Wireless Integrated Fire Technology. See DN-60820.
- Up to 159 detectors and 159 modules per SLC; 318 devices per loop/636 per FACP or network node.
 - Detectors can be any mix of ion, photo, thermal, or multi-sensor; wireless detectors are available for use with the FWSG.
 - Modules include addressable pull stations, normally open contact devices, two-wire smoke detectors, notification, or relay; wireless modules are available for use with the FWSG.
- Standard 80-character display, 640-character large display (NCA-2), or display-less (a node on a network).
- Network options:
 - High-speed network for up to 200 nodes (NFS2-3030, NFS2-640, NFS-320(C), NFS-320SYS, NCA-2, DVC-EM, ONYX-Works, NFS-3030, NFS-640, and NCA).
 - Standard network for up to 103 nodes (NFS2-3030, NFS2-640, NFS-320(C), NFS-320SYS, NCA-2, DVC-EM, ONYX-Works, NCS, NFS-3030, NFS-640, NCA, AFP-200, AFP-300/400, AFP-1010, and AM2020). Up to 54 nodes when DVC-EM is used in network paging.
- 6.0 A switch mode power supply with four Class A/B built-in Notification Appliance Circuits (NAC). Selectable System Sensor, Wheelock, or Gentex strobe synchronization.
- Built-in Alarm, Trouble, Security, and Supervisory relays.
- VeriFire® Tools online or offline programming utility. Upload/Download, save, store, check, compare, and simulate panel databases. Upgrade panel firmware.
- Autoprogramming and Walk Test reports.
- Multiple central station communication options:
 - Standard UDACT
 - Internet
 - Internet/GSM
- 80-character remote annunciators (up to 32).

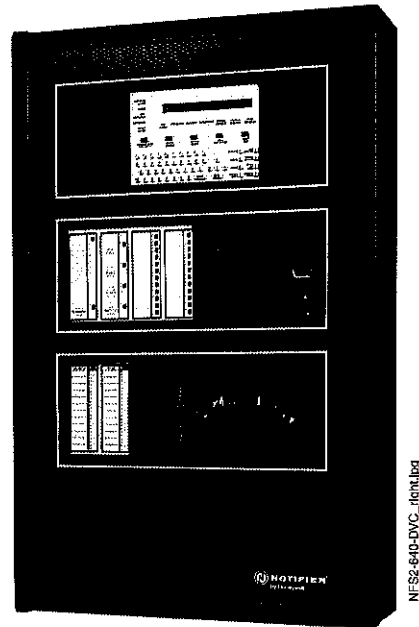

NFS2-640

- EIA-485 annunciators, including custom graphics.
- Printer interface (80-column and 40-column printers).
- History file with 800-event capacity in nonvolatile memory, plus separate 200-event alarm-only file.
- Alarm Verification selection per point, with automatic counter.
- Presignal/Positive Alarm Sequence (PAS).
- Silence inhibit and Auto Silence timer options.
- March time/temporal/California two-stage coding/strobe synchronization.
- Field-programmable on panel or on PC, with VeriFire Tools program check, compare, simulate.
- Full QWERTY keypad.
- Battery charger supports 18 – 200 AH batteries.
- Non-alarm points for lower priority functions.
- Remote ACK/Signal Silence/System Reset/Drill via monitor modules.
- Automatic time control functions, with holiday exceptions.
- Surface Mount Technology (SMT) electronics.
- Extensive, built-in transient protection.
- Powerful Boolean logic equations.
- Support for SCS Series smoke control system in HVAC mode.

NCA-2 AS PRIMARY DISPLAY

- Backlit, 640-character display.
- Supports SCS Series smoke control system in FSCS mode when SCS is connected to the NCA-2 used as primary display.
- Supports DVC digital audio loop.
- Printer and CRT EIA-232 ports.
- EIA-485 annunciator and terminal mode ports.
- Alarm, Trouble, Supervisory, and Security relays.

FLASHSCAN® INTELLIGENT FEATURES

- Polls up to 318 devices in less than two seconds.
- Activates up to 159 outputs in less than five seconds.
- Multicolor LEDs blink device address during Walk Test.
- Fully digital, high-precision protocol (U.S. Patent 5,539,389).
- Manual sensitivity adjustment — up to nine levels.
- Pre-alarm ONYX intelligent sensing — up to nine levels.
- Day/Night automatic sensitivity adjustment.
- Sensitivity windows:
 - Ion – 0.5 to 2.5%/foot obscuration.
 - Photo – 0.5 to 2.35%/foot obscuration.
 - Laser (VIEW®) – 0.02 to 2.0%/foot obscuration.
 - Acclimate Plus™ – 0.5 to 4.0%/foot obscuration.
 - IntelliQuad™ – 1.0 to 4.0%/foot obscuration.
 - IntelliQuad™ PLUS – 1.0 to 4.0%/foot obscuration
- Drift compensation (U.S. Patent 5,764,142).
- Degraded mode — in the unlikely event that the CPU2-640 microprocessor fails, FlashScan detectors revert to degraded operation and can activate the CPU2-640 NAC circuits and alarm relay. Each of the four built-in panel circuits includes a Disable/Enable switch for this feature.
- Multi-detector algorithm involves nearby detectors in alarm decision (U.S. Patent 5,627,515).
- Automatic detector sensitivity testing (NFPA-72 compliant).
- Maintenance alert (two levels).
- Self-optimizing pre-alarm.

FSL-751 (VERY INTELLIGENT EARLY WARNING)

SMOKE DETECTION TECHNOLOGY

- Advanced ONYX intelligent sensing algorithms differentiate between smoke and non-smoke signals (U.S. Patent 5,831,524).
- Addressable operation pinpoints the fire location.

- Early warning performance comparable to the best aspiration systems at a fraction of the lifetime cost.

FAPT-851 ACCLIMATE PLUS

LOW-PROFILE INTELLIGENT MULTI-SENSOR

- Detector automatically adjusts sensitivity levels without operator intervention or programming. Sensitivity increases with heat.
- Microprocessor-based technology; combination photo and thermal technology.
- Low-temperature warning signal at 40°F ± 5°F (4.44°C ± 2.77°C).

FSC-851 INTELLIQUAD

ADVANCED MULTI-CRITERIA DETECTOR

- Detects all four major elements of a fire (smoke, heat, CO, and flame).
- Automatic drift compensation of smoke sensor and CO cell.
- High nuisance-alarm immunity.

INTELLIGENT FAAST® DETECTORS FSA-5000, FSA-8000, FSA-20000 AND FSA-20000P

- Connects directly to the SLC loop of compatible ONYX series panels.
- Provides five event thresholds that can be individually programmed with descriptive labels for control-by-event programming; uses five detector addresses.
- Uses patented particle separator and field-replaceable filter to remove contaminants.
- Advanced algorithms reject common nuisance conditions
- FSA-5000 covers 5,000 square feet through one pipe.
- FSA-8000 covers 8,000 square feet through one pipe.
- FSA-20000 covers 28,800 square feet through one to four pipes.

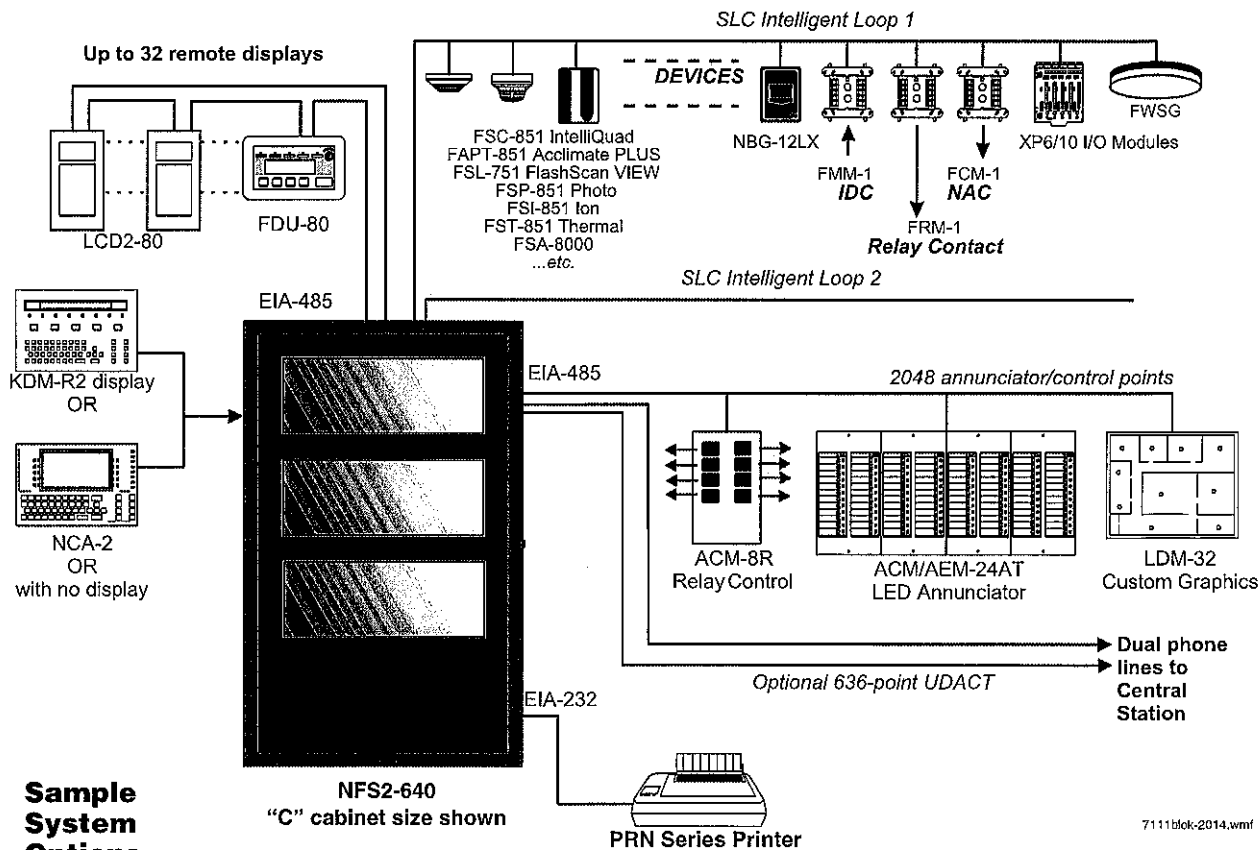

7111blok-2014.wmf

- FSA-20000P covers 28,800 square feet through one to four pipes. Supports addressable pipes to pinpoint location of alarm events

FCO-851 INTELLIQUAD™ PLUS

ADVANCED MULTI-CRITERIA FIRE/CO DETECTOR

- Detects all four major elements of a fire.
- Separate signal for life-safety CO detection.
- Optional addressable sounder base for Temp-3 (fire) or Temp-4 (CO) tone.
- Automatic drift compensation of smoke sensor and CO cell.
- High nuisance-alarm immunity.

SWIFT WIRELESS

- Self-healing mesh wireless protocol.
- Each SWIFT Gateway supports up to 50 devices: 1 wireless gateway and up to 49 SWIFT devices.
- Up to 4 wireless gateways can be installed with overlapping network coverage.

RELEASING FEATURES

- Ten independent hazards.
- Sophisticated cross-zone (three options).
- Delay timer and Discharge timers (adjustable).
- Abort (four options).
- Low-pressure CO2 listed.

DIGITAL VOICE AND TELEPHONE FEATURES

- Up to eight channels of digital audio.
- 35, 50, 75, and 100/125 watt digital amplifiers (DAA2/DAX series and DS series; NCA-2 required as primary display).
- Solid-state digital message generation.
- Firefighter telephone option.
- 30- to 120-watt high-efficiency amplifiers (AA Series).
- Backup tone generator and amplifier option.
- NFS2-640 can also integrate with the FirstCommand Emergency Communications System. See DN-60772.

HIGH-EFFICIENCY OFFLINE SWITCHING

3.0 A POWER SUPPLY (6.0 A IN ALARM)

- 120 VAC (NFS2-640); 240 VAC (NFS2-640E).
- Displays battery current/voltage on panel (with display).

FlashScan, Exclusive World-Leading Detector Protocol

At the heart of the NFS2-640 is a set of detection devices and device protocol — FlashScan (U.S. Patent 5,539,389). FlashScan is an all-digital protocol that gives superior precision and high noise immunity.

In addition to providing quick identification of an active input device, this protocol can also activate many output devices in a fraction of the time required by competitive protocols. This high speed also allows the NFS2-640 to have the largest device per loop capacity in the industry — 318 points — yet every input and output device is sampled in less than two seconds. The microprocessor-based FlashScan detectors have bicolor LEDs that can be coded to provide diagnostic information, such as device address during Walk Test.

ONYX Intelligent Sensing

Intelligent sensing is a set of software algorithms that provides the NFS2-640 with industry-leading smoke detection capability. These complex algorithms require many calculations on each reading of each detector, and are made possible by the high-speed micro-computer used by the NFS2-640.

Drift Compensation and Smoothing: Drift compensation allows the detector to retain its original ability to detect actual smoke, and resist false alarms, even as dirt accumulates. It reduces maintenance requirements by allowing the system to automatically perform the periodic sensitivity measurements required by NFPA 72. Smoothing filters are also provided by software to remove tran-

sient noise signals, such as those caused by electrical interference.

Maintenance Warnings: When the drift compensation performed for a detector reaches a certain level, the performance of the detector may be compromised, and special warnings are given. There are three warning levels: (1) Low Chamber value; (2) Maintenance Alert, indicative of dust accumulation that is near but below the allowed limit; (3) Maintenance Urgent, indicative of dust accumulation above the allowed limit.

Sensitivity Adjust: Nine sensitivity levels are provided for alarm detection. These levels can be set manually, or can change automatically between day and night. Nine levels of pre-alarm sensitivity can also be selected, based on predetermined levels of alarm. Pre-alarm operation can be latching or self-restoring, and can be used to activate special control functions.

Self-Optimizing Pre-Alarm: Each detector may be set for "Self-Optimizing" pre-alarm. In this special mode, the detector "learns" its normal environment, measuring the peak analog readings over a long period of time, and setting the pre-alarm level just above these normal peaks.

Cooperating Multi-Detector Sensing: A patented feature of ONYX intelligent sensing is the ability of a smoke sensor to consider readings from nearby sensors in making alarm or pre-alarm decisions. Without statistical sacrifice in the ability to resist false alarms, it allows a sensor to increase its sensitivity to actual smoke by a factor of almost two to one.

Field Programming Options

Autoprogram is a timesaving feature. The FACP "learns" what devices are physically connected and automatically loads them in the program with default values for all parameters. Requiring less than one minute to run, this routine allows the user to have almost immediate fire protection in a new installation, even if only a portion of the detectors are installed.

Keypad Program Edit (with KDM-R2) The NFS2-640, like all NOTIFIER intelligent panels, has the exclusive feature of program creation and editing capability from the front panel keypad, while continuing to provide fire protection. The architecture of the NFS2-640 software is such that each point entry carries its own program, including control-by-event links to other points. This allows the program to be entered with independent per-point segments, while the NFS2-640 simultaneously monitors other (already installed) points for alarm conditions.

VeriFire® Tools is an offline programming and test utility that can greatly reduce installation programming time, and increase confidence in the site-specific software. It is Windows®-based and provides technologically advanced capabilities to aid the installer. The installer may create the entire program for the NFS2-640 in the comfort of the office, test it, store a backup file, then bring it to the site and download from a laptop into the panel.

Placement of Equipment in Chassis and Cabinet

The following guidelines outline the NFS2-640's flexible system design.

Rows: The first row of equipment in the cabinet mounts in the chassis shipped with the FACP. Mount the second, third, or fourth rows of equipment in a CHS-4 series chassis or, for Digital Voice Command products, in CA-1 or CA-2. (For DVC-EM and DAA2/DAX components see *DVC Manual*; for DS series components see *DS-AMP Manual*; for DVC-AO applications, see *AA Series Installation Manual*). Other options are available; see your panel's installation manual.

Wiring: When designing the cabinet layout, consider separation of power-limited and non-power-limited wiring as discussed in the *NFS2-640 Installation Manual*.

Positions: A chassis offers four basic side-by-side positions for components; the number of modules that can be mounted in each position depends on the chassis model and the size of the individual module. There are a variety of standoff and hardware items available for different combinations and configurations of components.

It is critical that all mounting holes of the NFS2-640 are secured with a screw or standoff to ensure continuity of Earth Ground.

Layers: The control panel's chassis accepts four layers of equipment, including the control panel. The CPU2-640 fills three positions (left to right) in the first-installed layer (the back of the chassis); its integral power supply occupies the center two positions in the next two layers; the optional display occupies (the left) two positions at the front, flush with the door. Some equipment, such as the NCA-2, may be mounted in the dress panel directly in front of the control panel. The NCA-2 can be used as a primary display for the NFS2-640 (use NCA/640-2-KIT) by directly connecting their network ports (required in Canadian stand-alone applications); see NCA-2 data sheet for mounting options (DN-7047).

Expansion: Installing an LEM-320 Loop Expander Module adds a second SLC loop to the control panel. The LEM-320 is mounted onto the CPU2-640, occupying the middle-right, second (back) slot on the chassis.

Networking: If networking two or more control panels, each unit requires a Network Communication Module or High-Speed Network Communication Module. (HS-NCM can support two nodes; see "Networking Options" on page 4). These modules can be installed in any option board position (see manual), and additional option boards can be mounted in front of the network communication modules.

KDM-R2 Controls and Indicators

Program Keypad: QWERTY type (keyboard layout, see figure).

12 LED indicators: Power; Fire Alarm; Pre-Alarm; Security; Supervisory; System Trouble; Signals Silenced; Points Disabled; Control Active; Abort; Pre-Discharge; Discharge.

Keypad Switch Controls: Acknowledge/Scroll Display; Signal Silence; Drill; System Reset; Lamp Test.

LCD Display: 80 characters (2 x 40) with long-life LED backlight.

Product Line Information

- "Configuration Guidelines" on page 4
- "Networking Options" on page 4
- "Auxiliary Power Supplies and Batteries" on page 4
- "Audio Options" on page 5
- "Compatible Devices, EIA-232 Ports" on page 5
- "Compatible Devices, EIA-485 Ports" on page 5
- "Compatible Intelligent Devices" on page 5
- "Enclosures, Chassis, and Dress Plates" on page 6
- "Other Options" on page 7

CONFIGURATION GUIDELINES

Stand-alone and network systems require a main display. On systems with one FACP (one CPU2-640/-640E), display options are the KDM-R2 or the NCA-2. On network systems (two or more networked fire panel nodes), at least one NCA-2, NCS, or ONYX-Works annunciation device is required. Other options listed as follows;

KDM-R2: 80-character backlit LCD display with QWERTY programming and control keypad. Order two BMP-1 blank modules and DP-DISP2 mounting plate separately. Requires top row of a cabinet. Required for each stand-alone 80-character display system. The KDM-R2 may mount in network nodes to display "local" node information as long as at least one NCA-2 or NCS/ONYX-Works network display is on the system to display network information. (Non-English versions also available: KDM-R2C for ULC application, KDM-R2-FR, KDM-R2-PO, KDM-R2-SP.)

NCA-2: Network Control Annunciator, 640 characters. On single CPU2-640/-640E systems, the optional NCA-2 can be used as the Primary Display for the panel and connects directly to the CPU2-640/-640E. On network systems (two or more networked fire panel nodes), one network display (either NCA-2 or NCS/ONYX-Works) is required for every system. On network systems, the NCA-2 connects to (and requires) a standard Network Communication Module or High-Speed Network Communication Module. Mounts in a row of FACP node or in two annunciator positions. Mounting

options include the DP-DISP2, ADP-4B, or in an annunciator box, such as the ABS-2D. In CAB-4 top-row applications, a DP-DISP2 and two BMP-1 blank modules are required for mounting. Required for NFS2-640 applications employing the DVC-EM with DAL devices. Non-English versions are available. NCA-2 are available for ULC applications. For marine applications, order NCA-2-M; for non-English Marine applications, order NCA-2-M and the appropriate KP-KIT-XX. See DN-7047.

CPU2-640: Central processing unit (CPU) with integral 3.0 A (6.0 A in alarm) power supply for an NFS2-640 system. Includes control panel factory-mounted on a chassis; one Signaling Line Circuit expandable to two; documentation kit. Order one per system or as necessary (up to 103 network nodes) on a network system. (Non-English versions also available: CPU2-640-FR, CPU2-640-PO, CPU2-640-SP)

CPU2-640E: Same as CPU2-640 but requires 240 VAC, 1.5 A, (3.0 A in alarm). (Non-English versions also available: CPU2-640E-PO, CPU2-640E-SP)

NCA/640-2-KIT: Bracket installation kit required to mount NCA-2 to the CPU2-640/-640E's standard chassis.

DP-DISP2: Dress panel for top row in cabinet with CPU2-640/640E installed.

ADP2-640: Dress panel for middle rows with CPU2-640/640E.

BMP-1: Blank module for unused module positions.

BP2-4: Battery plate, required.

LEM-320: Loop Expander Module. Expands each NFS2-640 to two Signaling Line Circuits. See DN-6881.

NETWORKING OPTIONS

NCM-W, NCM-F: Standard Network Communications Modules. Wire and multi-mode fiber versions available. See DN-6861.

HS-NCM-W/MF/SF/WMF/WSF/MFSF: High-speed Network Communications Modules that can connect to two nodes. Wire, single-mode fiber, multi-mode fiber, and media conversion models are available. See DN-60454.

RPT-W, RPT-F, RPT-WF: Standard-network repeater board with wire connection (RPT-W), multi-mode fiber connection (RPT-F), or allowing a change in media type between wire and fiber (RPT-WF). Not used with high-speed networks. See DN-6971.

ONYXWorks: UL-listed graphics PC workstation, software, and computer hardware. See DN-7048 for specific part numbers.

NFN-GW-EM-3: NFN Gateway, embedded. (Replaces NFN-GW-EM.) See DN-60499.

NWS-3: NOTI•FIRE•NET™ Web Server. See DN-6928.

CAP-GW: Common Alerting Protocol Gateway. See DN-60756.

VESDA-HLI-GW: VESDAnet high-level interface gateway. See DN-60753.

LEDSIGN-GW: UL-listed sign gateway. Interfaces with classic and high-speed NOTI•FIRE•NET networks through the NFN Gateway. See DN-60679.

OAX2-24V: UL-listed LED sign, used with LEDSIGN-GW. See DN-60679.

AUXILIARY POWER SUPPLIES AND BATTERIES

ACPS-610: 6.0 A or 10.0 A addressable charging power supply. See DN-60244.

APS2-6R: Auxiliary Power Supply. Provides up to 6.0 amperes of power for peripheral devices. Includes battery input and transfer relay, and overcurrent protection. Mounts on two of four positions on a CHS-4L or CHS-4 chassis. See DN-5952.

FCPS-24S6/S8: Remote 6 A and 8 A power supplies with battery charger. See DN-6927.

BAT Series: Batteries. NFS2-640 uses two 12 volt, 18 to 200 AH batteries. See DN-6933.

AUDIO OPTIONS

NOTE: For mounting hardware, see "Enclosures, Chassis, and Dress Plates" on page 6 and peripheral data sheets.

DVC-EM: Digital Voice Command, digital audio processor with message storage for up to 32 minutes of standard quality (4 minutes at high quality) digital audio. Capable of playing up to eight simultaneous messages when used with Digital Audio Loop (DAL) devices. See DN-7045.

DVC-RPU: Digital Voice Command Remote Paging Unit for use with DVC-EM. Includes the keypad/display. See DN-60726.

DS-DB: Digital Series Distribution Board, provides bulk amplification capabilities to the DVC-EM while retaining digital audio distribution capabilities. Can be configured with up to four DS-AMPs, supplying high-level risers spread throughout an installation. See DN-60565.

DVC-KD: DVC-EM keypad for local annunciation and controls; status LEDs and 24 user-programmable buttons. See DN-7045.

DS-AMP/E: 125W, 25 VRMS, or 100W, 70VRMS. 70VRMS requires DS-XF70V step-up transformer. Digital Series Amplifier, part of the DS-DB system. See DN-60663.

DS-RFM, DS-FM, DS-SFM: Fiber conversion modules for DVC-EM, DS-DB distribution board, and DAX and DAA2 Series amplifiers. See DN-60633.

DVC-AO: DVC Analog Output board provides four analog output circuits for use with AA Series amplifiers. Four-channel operation supported. See DN-7045.

DAA2-5025(E): 50W, 25 Vrms Digital Audio Amplifier assembly with power supply; includes chassis. See DN-60556.

DAA2-5070(E): 50W, 70.7 Vrms Digital Audio Amplifier assembly with power supply; includes chassis. See DN-60556.

DAA2-7525(E): 75W, 25 Vrms digital audio amplifier assembly with power supply; includes chassis. See DN-60556.

DAX-3525(E): 35W, 25 Vrms Digital Audio Amplifier assembly with power supply, includes chassis. See DN-60561.

DAX-3570(E): 35W, 70.7 Vrms Digital Audio Amplifier assembly with power supply, includes chassis. See DN-60561.

DAX-5025(E): 50W, 25 Vrms Digital Audio Amplifier assembly with power supply, includes chassis. See DN-60561.

DAX-5070(E): 50W, 70.7 Vrms Digital Audio Amplifier assembly with power supply, includes chassis. See DN-60561.

TELH-1: Firefighter's Telephone Handset for use with the DVC-EM when mounted in the CA-2 chassis. See DN-7045.

CMIC-1: Optional microphone and microphone well assembly used with the CA-1 chassis.

RM-1/RM-1SA: Remote microphone assemblies, mount on ADP-4 (RM-1) dress panel or CAB-RM/RMR (RM-1SA) stand-alone cabinets. See DN-6728.

AA-30: Audio Amplifier, 30 watts, 25 Vrms. Includes amplifier and audio input supervision, backup input, and automatic switchover, power supply, cables. See DN-3224.

AA-120/AA-100: Audio Amplifier provides up to 120 watts of 25 VRMS audio power for the NFS-640. The amplifier contains an integral chassis for mounting to a CAB-B4, -C4, or -D4 backbox (consumes one row). Switch-mode power. Includes audio input and amplified output supervision, backup input, and automatic switchover to backup tone. Order the AA-100 for 70.7 VRMS systems and 100 watts of power. See DN-3224.

DAA Series Digital Audio Amplifiers: Legacy DAA Series amplifiers are compatible with DVC-EM systems running SR4.0. For specific information on DAA-50 series amplifiers, refer to DN-7046. For information on DAA-7525 Series, refer to DN-60257.

NFC-25/50: 25 watt, 25 VRMS, emergency Voice Evacuation Control Panel (VECP) with integral commercial microphone, digital message generator, and single-/dual-channel Class A or Class B speaker circuits. See DN-60772.

COMPATIBLE DEVICES, EIA-232 PORTS

PRN-7: 80-column printer. See DN-60897.

VS4095/5: Printer, 40-column, 24V. Mounted in external backbox. See DN-3260.

DPI-232: Direct Panel Interface, specialized modem for extending serial data links to remotely located FACP's and/or peripherals. See DN-6870.

COMPATIBLE DEVICES, EIA-485 PORTS

ACM-24AT: ONYX Series ACS annunciator – up to 96 points of annunciation with Alarm or Active LED, Trouble LED, and switch per circuit. Active/Alarm LEDs can be programmed (by powered-up switch selection) by point to be red, green, or yellow; the Trouble LED is always yellow. See DN-6862.

AEM-24AT: Same LED and switch capabilities as ACM-24AT, expands the ACM-24AT to 48, 72, or 96 points. See DN-6862.

ACM-48A: ONYX Series ACS annunciator – up to 96 points of annunciation with Alarm or Active LED per circuit. Active/Alarm LEDs can be programmed (by powered-up switch selection) in groups of 24 to be red, green, or yellow. Expandable to 96 points with one AEM-48A. See DN-6862.

AEM-48A: Same LED capabilities as ACM-48A, expands the ACM-48A to 96 points. See DN-6862.

ACM-8R: Remote Relay Module with eight Form-C contacts. Can be located up to 6,000 ft. (1828.8 m) from panel on four wires. See DN-3558.

FDU-80: Terminal mode. 80-character, backlit LCD display. Mounts up to 6,000 ft. (1828.8 m) from panel. Up to 32 per FACP. See DN-6820.

LCD2-80: Terminal and ACS mode. 80-character, backlit LCD display. Mounts up to 6,000 ft. (1828.8 m) from panel. Up to 32 per FACP. See DN-60548.

LDM: Lamp Driver Modules LDM-32, LDM-E32, and LDM-R32; remote custom graphic driver modules. See DN-0551.

SCS: Smoke control stations SCS-8, SCE-8, with lamp drivers SCS-8L, SCE-8L; eight (expandable to 16) circuits (HVAC only). See DN-4818.

TM-4: Transmitter Module. Includes three reverse-polarity circuits and one municipal box circuit. Mounts in panel module position (single-address-style) or in CHS2-M2 position. See DN-6860.

UDACT-2: Universal Digital Alarm Communicator Transmitter, 636 channel. See DN-60686.

UZC-256: Programmable Universal Zone Coder provides positive non-interfering successive zone coding. Microprocessor-controlled, field-programmable from IBM®-compatible PCs (requires optional programming kit). Up to 256 programmable codes. Mounts in BB-UZC or other compatible chassis (purchased separately). See DN-3404.

COMPATIBLE INTELLIGENT DEVICES

NOTE: "A" suffix indicates ULC-Listed model.

FWSG Wireless SWIFT Gateway: Addressable gateway supports wireless SLC devices. Not appropriate for ULC applications. See DN-60820.

FSA-5000: Intelligent FFAST® XS Fire Alarm Aspiration Sensing Technology. Intelligent aspirating smoke detector for applications up to 5,000 sq.ft. For Canadian applications, order FSA-5000A.

FSA-8000: Intelligent FFAST® XM Fire Alarm Aspiration Sensing Technology. Intelligent aspirating smoke detector for applications up to 8,000 sq.ft. For Canadian applications, order FSA-8000A. See DN-60792.

FSA-20000: Intelligent FFAST® XT Fire Alarm Aspiration Sensing Technology. Intelligent aspirating smoke detector for applications up to 28,800 sq.ft. For Canadian applications, order FSA-20000A. See DN-60849.

FSA-20000P FFAST® XT PRO Intelligent Aspiration Detector For applications up to 28,800 sq. ft. (2601 sq. m.) through one to four addressable pipes. See DN-60792

FSB-200(A): Intelligent beam smoke detector. See DN-6985.

FSB-200S(A): Intelligent beam smoke detector with integral sensitivity test. See DN-6985.

FSC-851(A): FlashScan IntelliQuad Advanced Multi-Criteria Detector. *See DN-60412.*

FCO-851(A): FlashScan IntelliQuad PLUS Advanced Multi-Criteria Fire/CO Detector. *See DN-60689.*

FSI-851(A): Low-profile FlashScan ionization detector. *See DN-6934.*

FSP-851(A): Low-profile FlashScan photoelectric detector. *See DN-6935.*

FSP-851T(A): FSP-851 plus dual electronic thermistors that add 135°F (57°C) fixed-temperature thermal sensing. *See DN-6935.*

FSP-851R(A): FSP-851, remote-test capable. For use with DNR(W). *See DN-6935.*

FST-851(A): FlashScan thermal detector 135°F (57°C). *See DN-6936.*

FST-851R(A): FlashScan thermal detector 135°F (57°C) with rate-of-rise. *See DN-6936.*

FST-851H(A): FlashScan 190°F (88°C) high-temperature thermal detector. *See DN-6936.*

FAPT-851(A): FlashScan Acclimate Plus low-profile multi-sensor detector. *See DN-6937.*

FSL-751(A): FlashScan VIEW laser photo detector. *See DN-6886.*

DNR(A): InnovairFlex low-flow non-relay duct-detector housing (order FSP-851R separately). Replaces FSD-751PL/FSD-751RPL. *See DN-60429.*

DNRW(A): Same as above with NEMA-4 rating, watertight. *See DN-60429.*

B224RB: Low-profile relay base. *See DN-60054.*

B224BI: Isolator base for low-profile detectors. *See DN-60054.*

B210LP: Low-profile base. Standard U.S. style. Replaces B710LP. *See DN-60054.*

B501(A): European-style, 4" (10.16 cm) base. *See DN-60054.*

B200S: Intelligent programmable sounder base, capable of producing a variety of tone patterns including ANSI Temporal 3. Compatible with synchronization protocol. *See DN-60054.*

B200S-LF: Low-frequency version of B200S. *See DN-60054.*

B200SCOA: Based on B200SA, with added CO detector markings in English/French. For Canadian applications only.

B200SR: Sounder base, Temporal 3 or Continuous tone. *See DN-60054.*

B200SR-LF: Low-frequency version of B200SR. *See DN-60054.*

FMM-1(A): FlashScan monitor module. *See DN-6720.*

FDM-1(A): FlashScan dual monitor module. *See DN-6720.*

FZM-1(A): FlashScan two-wire detector monitor module. *See DN-6720.*

FMM-101(A): FlashScan miniature monitor module. *See DN-6720.*

FTM-1(A): Firephone Telephone Module connects a remote firefighter telephone to a centralized telephone console. Reports status to panel. Wiring to jacks and handsets is supervised. *See DN-6989.*

FCM-1(A): FlashScan control module. *See DN-6720.*

FCM-1-REL(A): FlashScan releasing control module. *See DN-60390.*

FRM-1(A): FlashScan relay module. *See DN-6720.*

FDRM-1(A): FlashScan dual monitor/dual relay module. *See DN-60709.*

NBG-12LX: Manual pull station, addressable. *See DN-6726.*

ISO-X: Isolator module. *See DN-2243.*

ISO-6: Six Fault isolator module. For Canadian applications order ISO-6A. *See DN-60844.*

XP6-C(A): FlashScan six-circuit supervised control module. *See DN-6924.*

XP6-MA(A): FlashScan six-zone interface module; connects intelligent alarm system to two-wire conventional detection zone. *See DN-6925.*

XP6-R(A): FlashScan six-relay (Form-C) control module. *See DN-6926.*

XP10-M(A): FlashScan ten-input monitor module. *See DN-6923.*

SLC-IM: SLC integration module, for VESDAnet detectors. *See DN-60755.*

ENCLOSURES, CHASSIS, AND DRESS PLATES

CAB-4 Series Enclosure: NFS2-640 mounts in a standard CAB-4 Series enclosure (available in four sizes, "A" through "D"). Backbox and door ordered separately; requires BP2-4 battery plate. A trim ring option is available for semi-flush mounting. *See DN-6857.*

EQ Series Cabinets: EQ series cabinets will house amplifiers, power supplies, battery chargers and control modules. EQ cabinets are available in three sizes, "B" through "D". *See DN-60229.*

CAB-BM Marine System: Protects equipment in shipboard and waterfront applications. Also order **BB-MB** for systems using 100 AH batteries. For a full list of required and optional equipment, see *DN-60688.*

CHS-4: Chassis for mounting up to four APS-6Rs.

CHS-4L: Low-profile four-position Chassis. Mounts two AA-30 amplifiers or one AMG-E and one AA-30.

DP-1B: Blank dress panel. Provides dead-front panel for unused tiers; covers DAA2/DAX series or AA-series amplifier.

NFS-LBB: Battery Box (required for batteries larger than 26 AH).

NFS-LBBR: Same as above but red.

CHS-BH1: Battery chassis; holds two 12.0 AH batteries. Mounts one the left side of DAA2 chassis. *See DN-7046.*

CA-1: Chassis, occupies one tier of a CAB-4 Series enclosure. The left side accommodates one DVC-EM and a DVC-KD (optional); and the right side houses a CMIC-1 microphone and its well (optional). *See DN-7045.*

CA-2: Chassis assembly, occupies two tiers of a CAB-4 Series enclosure. The left side accommodates one DVC-EM mounted on a half-chassis and one NCA-2 mounted on a half-chassis. The right side houses a microphone/handset well. The CA-2 assembly includes CMIC-1 microphone. ADDR Series doors with two-tier visibility are available for use with the CA-2 configuration: ADDR-B4, ADDR-C4, ADDR-D4 (below).

CFFT-1: Chassis to mount firefighter's telephone and one ACS annunciator in a CAB-4 row. Includes TELH-1 firefighter's handset for the DVC-EM, chassis, phone well and mounting hardware. Order DP-CFFT dress panel separately.

DP-CFFT: CFFT-1 dress panel. Requires BMP-1 if no ACS annunciator is installed.

ADDR-B4*: Two-tier-sized door designed for use with the CA-2 chassis configuration. ADDR Series doors are similar to CAB-4 Series "DR" doors, but a clear window space exposes the top two tiers of the CAB-4 enclosure. Use an SBB-B4 backbox with the ADDR-B4. *See DN-7045, DN-6857.*

ADDR-C4*: Three-tier-sized door, designed for use with the CA-2 chassis configuration. ADDR Series doors are similar to CAB-4 Series "DR" doors, but a clear window space exposes the top two tiers of the CAB-4 enclosure. Use an SBB-C4 backbox with the ADDR-C4. *See DN-7045, DN-6857.*

ADDR-D4*: Four-tier-sized door designed for use with the CA-2 chassis configuration. ADDR Series doors are similar to CAB-4 Series "DR" doors, but a clear window space exposes the top two tiers of the CAB-4 enclosure. Use an SBB-D4 backbox with the ADDR-D4. *See DN-7045, DN-6857.*

*Use ADDR-B4/C4/D4 when CA-2 chassis is installed in top two rows with NCA-2 or BP-CA2. Use standard door when CA-2 is not installed in top two rows. For additional configuration information, see the DVC application guide on <http://esd.notifier.com>.

DPA-1: Dress panel, used with the CA-1 chassis when configured with a DVC-EM, DVC-KD, and CMIC-1. *See DN-7045.*

DPA-2B: Dress panel used with CA-2 chassis assembly.

VP-2B: Dress panel, required when CA-2 chassis is installed in the top two cabinet rows.

DPA-1A4: Dress panel, used with the CA-1 chassis when the CMIC-1 is not used. Provides mounting options on right two bays for two ACS annunciators, or for blank plates. See *DN-7045*.

BP-CA2: Blank plate for CA-2 chassis.

SEISKIT-CAB: Seismic mounting kit. Required for seismic-certified applications with NFS2-640 and other equipment mounted in CAB-4 Series Enclosures. Includes battery bracket for two 26 AH batteries.

SEISKIT-LBB: Seismic kit for the NFS-LBB. Includes battery bracket for two 55 AH batteries.

BACKBOXES

NOTE: "C" suffix indicates ULC-Listed model.

ABF-1B(C) Annunciator Flush Box.

ABF-1DB(C) Annunciator Flush Box with Door.

ABF-2B Annunciator Flush Box

ABF-2DB/C Annunciator Flush Box with Door

ABF-4B Annunciator Flush Box

ABS-1TB(C) Annunciator Surface Box

ABS-1B(C) Annunciator Surface Box

ABS-2B Annunciator Surface Box

ABS-2D(C) Annunciator Surface Box

ABS-4D(C) Annunciator Surface Box

BB-UZC: Backbox for housing the UZC-256 in applications where the UZC-256 will not fit in panel enclosure. Black; for red, order BB-UZC-R.

OTHER OPTIONS

411: Slave digital alarm communicator. See DN-6619.

411UDAC: Digital alarm communicator. See DN-6746.

IPDACT-2/2UD, IPDACT Internet Monitoring Module: Connects to primary and secondary DACT telephone output ports for internet communications over customer-provided Ethernet connection. Requires compatible Teldat VisorALARM Central Station Receiver. Can use DHCP or static IP. See *DN-60408*.

IPCHSKIT: IP Communicator Chassis Mounting Kit. For mounting an IPDACT-2/2UD onto the panel chassis or CHS-4 series chassis. Use IPENC for external mounting applications.

IPSPLT: Y-adaptor option allow connection of both panel dialer outputs to one IPDACT-2/2UD cable input.

IPENC: External enclosure for IPDACT, includes IPBRKT mounting bracket; Red. For Black order IPENC-B.

IPGSM-4G: Internet and Digital Cellular Fire Alarm Communicator. Provides selectable configurable paths: cellular only, IP only, or IP primary with cellular backup. Connects to the primary and secondary ports of a DACT. For Canadian applications order IPGSM-4GC. See *DH-60769*.

NOTE: For other options including compatibility with retrofit equipment, refer to the panel's installation manual, the SLC manual, and the Device Compatibility Document.

System Specifications

SYSTEM CAPACITY

- Intelligent Signaling Line Circuits1 expandable to 2
- Intelligent detectors 159 per loop
- Addressable monitor/control modules 159 per loop
- Programmable software zones 99
- Special programming zones 14
- LCD annunciators per CPU2-640/-640E and NCA-2 (observe power) 32
- ACS annunciators per CPU2-640/-640E 32 addresses x 64 points
- ACS annunciators per NCA-2 32 addresses x 64 or 96 points

NOTE: The NCA-2 supports up to 96 annunciator address points per ACM-24AT/-48A.

ELECTRICAL SPECIFICATIONS

- Primary input power:
 - CPU2-640 board: 120 VAC, 50/60 Hz, 5.0 A.
 - CPU2-640E board: 220/240 VAC, 50/60 Hz, 2.5 A.
- Current draw (standby/alarm):
 - CPU2-640(E) board: 0.250 A. Add 0.035 A for each NAC in use.
 - KDM-R2: 0.100 A.
 - LEM-320: 0.100 A.
- Total output 24 V power: 6.0 A in alarm.

NOTE: The power supply has a total of 6.0 A. of available power. This is shared by all internal circuits. See Installation Manual for a complete current draw calculation sheet.

- Standard notification circuits (4): 1.5 A each.
- Resettable regulated 24V power: 1.25 A.
- Two non-resettable regulated 24V power outputs:
 - 1.25 A.
 - 0.50 A.
- Non-resettable 5V power: 0.15 A.
- Battery charger range: 18 AH – 200 AH. Use separate cabinet for batteries over 26 AH.
- Float rate: 27.6 V.

CABINET SPECIFICATIONS

- Systems can be installed in CAB-4 Series cabinets (four sizes with various door options, see DN-6857). Requires BP2-4 Battery Plate.

SHIPPING WEIGHT

- CPU2-640/-640: 14.3 lb (6.49 kg).
- CPU2-640/-640E: 14.55 lb (6.60 kg).

TEMPERATURE AND HUMIDITY RANGES

This system meets NFPA requirements for operation at 0 – 49°C/32 – 120°F and at a relative humidity 93% ± 2% RH (noncondensing) at 32°C ± 2°C (90°F ± 3°F). However, the useful life of the system's standby batteries and the electronic components may be adversely affected by extreme temperature ranges and humidity. Therefore, it is recommended that this system and its peripherals be installed in an environment with a normal room temperature of 15 – 27°C/60 – 80°F.

AGENCY LISTINGS AND APPROVALS

The listings and approvals below apply to the basic NFS2-640 control panel. In some cases, certain modules may not be listed by

certain approval agencies, or listing may be in process. Consult factory for latest listing status.

- **UL/ULC Listed:** S635.
- **ULC Listed:** S527-11
- **FM Approved.**
- **MEA:** 128-07-E.
- **Fire Dept. of New York:** #6212.
- **CSFM:** 7165-0028:0243.
- **City of Chicago.**
- **City and County of Denver.**
- **CCCF listed.**

Marine Applications: Marine approved systems must be configured using components itemized in this document. (See Main System Components, in "Product Line Information.") Specific connections and requirements for those components are described in the installation document, PN 54756. When these requirements are followed, systems are approved by the following agencies:

- **US Coast Guard** 161.002/50/0, 161.002/55/0 (Standard 46 CFR and 161.002).
- **Lloyd's Register** 11/600013 (ENV 3 category).
- **American Bureau of Shipping (ABS)** Type Approval.

NOTE: For information on marine applications, see DN-60688.

STANDARDS

The NFS2-640 complies with the following UL Standards and NFPA 72, International Building Code (IBC), and California Building Code (CBC) Fire Alarm Systems requirements:

- **UL 864, 9th Edition** (Fire).
- **UL 1076** (Burglary).
- **UL 2572** (Mass Notification Systems). (NFS2-640 version 20 or higher.)
- **ULC-S527-11** Standard for the Installation of Fire Alarm Systems.
- **LOCAL** (Automatic, Manual, Waterflow and Sprinkler Supervisory).
- **AUXILIARY** (Automatic, Manual and Waterflow) (requires TM-4).
- **REMOTE STATION** (Automatic, Manual, Waterflow and Sprinkler Supervisory) (requires TM-4).
- **PROPRIETARY** (Automatic, Manual and Waterflow). Not applicable for FM.
- **EMERGENCY VOICE/ALARM.**
- **OT, PSDN** (Other Technologies, Packet-switched Data Network).
- **IBC 2012, IBC 2009, IBC 2006, IBC 2003, IBC 2000** (Seismic).
- **CBC 2007** (Seismic).

IntelliQuad™, NOTI-FIRE-NET™, ONYXWorks™, and SWIFT™ are trademarks; and Acclimate® Plus™, FirstCommand®, FlashScan®, Intelligent FFAST®, NOTIFIER®, ONYX®, VeriFire® Tools, and VIEW® are registered trademarks of Honeywell International Inc. Microsoft® and Windows® are registered trademarks of Microsoft Corporation. IBM® is a registered trademark of IBM Corporation. ©2017 by Honeywell International Inc. All rights reserved. Unauthorized use of this document is strictly prohibited.



This document is not intended to be used for installation purposes.
We try to keep our product information up-to-date and accurate.
We cannot cover all specific applications or anticipate all requirements.
All specifications are subject to change without notice.



Country of Origin: USA

For more information, contact Notifier. Phone: (203) 484-7161, FAX: (203) 484-7118.
www.notifier.com

NFC-50/100(E)

Notifier First Command



Voice Evacuation & Emergency Communications System

General

Notifier's First Command NFC-50/100 and NFC-50/100E are multipurpose emergency voice evacuation panels for fire applications, mass notification applications, or both. The First Command delivers 50 or 100 watts of audio power for distribution to up to eight speaker circuits (i.e. zones). The NFC-50/100(E) comes standard with a single speaker circuit and a built-in 50 watt, 25V amplifier. A secondary 50 watt amplifier (NFC-BDA-25/70V) can be added for single speaker circuit backup or to increase system capacity to two speaker circuits and an additional 50 watts of audio power. An optional NFC-CE6 module added to the NFC-50/100(E) will upgrade the system to a maximum of eight speaker circuit outputs. All speaker output circuits can be wired in either Style Y (Class B) or Style Z (Class A) configuration. The NFC-50/100(E) has fourteen field programmable messages (up to 60 seconds each), built-in field configurable pre- and post-announce tone generators and a fully supervised Notification Appliance Circuit (NAC) with 2.0 amps of synchronized NAC power. The NFC-50/100(E) includes three built-in Form-C relay contacts, (AC power, trouble and MNS active) a NAC follower and 500mA special application power. A built-in power supply delivers operational power and an onboard battery charger supports charging up to 26AH batteries (NFC cabinet holds up to 18AH batteries).

For fire protection applications, the NFC-50/100(E) is an adjunct (slave) to any UL listed FACP, providing reverse polarity or contact closure; can be used as a stand-alone unit for non-fire applications. For seamless integration between fire and mass notification, the NFC-50/100(E) can be directly activated via serial communication between the NFW2-100, NFS-320, or NFS2-640. Activation of the NFC-50/100(E) via other FACP's uses the eight on board Command Input Circuits (CMDs). Two of the eight CMD circuits (CMD 1 & CMD 2) can be individually field programmed for activation by an FACP Notification Appliance Circuit reverse polarity and all eight can be activated by a contact closure. In addition, the NFC-50/100(E) can be activated from a building's Private Branch Exchange (PBX) with the integral night ring feature.

All NFC-50/100(E) programming is done by using a simple, built-in programming utility accessed from any laptop. For added flexibility, the NFC-50/100(E) supports both 25V and 70V speaker output operation. By adding a 70V transformer conversion module (NFC-XRM-70V) or an additional 70 volt secondary amplifier (NFC-BDA-25/70V) the system supports 70 volt speaker devices.

The NFC-50/100(E) can expand in order to accommodate larger or more complex installations. To add more control and increase system capacity, any combination of up to eight external remote consoles (including the NFC-LOC, NFC-RPU, and NFC-RM) and up to eight distributed audio amplifiers (including the NFC-50DA(E), NFC-100DA(E) and NFC-125-DA(E)) can be connected on the external data bus and audio riser data bus to create a fully integrated command center. A fully loaded system supports up to 1100 watts of total audio power and up to 24 speaker circuit outputs.

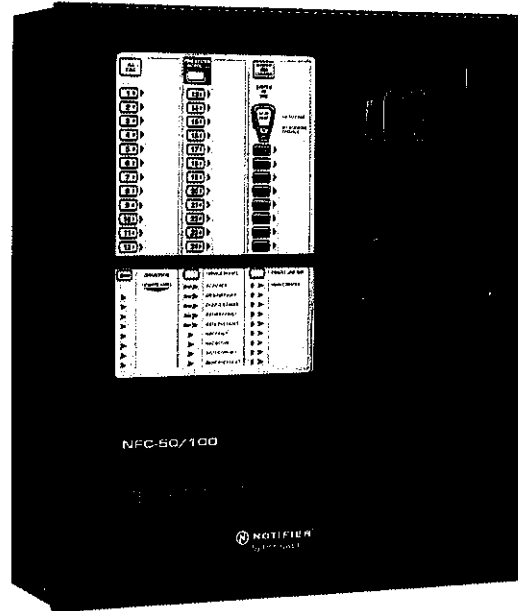

TYPICAL APPLICATIONS

- Schools
- Nursing Homes
- Factories
- Theaters
- Military facilities
- Restaurants
- Auditoriums
- Places of Worship
- Office Buildings

Features

- UL Listed to UL 2572 Communication (Control Units Mass Notification Systems) and UL 864 (emergency voice evacuation for fire)
- Modular design for system flexibility and easy expansion
- Removable terminal blocks
- 50 watts of 25V audio power (expandable to 100 watts) RMS
- 2 amp Notification Appliance Circuit (NAC) output, sync generator, or follower for System Sensor, Wheelock or Gen-tex protocols
- Optional 70V transformer available for the primary amplifier. (Note that speaker wiring continues to be supervised in standby, alarm and when background music is playing with this optional transformer installed)
- Eight Command Input Circuits to activate messages 1 to 8:
 - CMD1 and CMD2 are field selectable to be activated from 12 or 24 VDC Notification Appliance Circuits (reverse polarity) or contact closures
 - CMD3-CMD8 are activated by contact closures
- Speaker Circuits
 - Single Style Y (Class B) or Style Z (Class A) speaker Circuit

- Two Style Y (Class B) or Style Z (Class A) speaker circuits (with optional NFC-BDA-25/70V Audio Amplifier installed)
- Eight Style Y (Class B) or Style Z (Class A) speaker circuits (with optional NFC-BDA-25/70V and NFC-CE6 installed)
- 520Hz square wave tones available, which can be uploaded to the NFC-50/100 to meet NFPA Low Frequency requirements (*Refer to the Device Compatibility Document 15378 for listed compatible speakers.*)
- NFC-50/100(E) can be controlled by an FACP via the ANN/ACS (EIA-485) link of the NFW2-100, and via the ACS (EIA-485) link of the NFS-320 or NFS2-640. The NFS-320 or NFS2-640 must be firmware version 20.0 or higher.
- Certified for seismic applications when used with the appropriate seismic mounting kit
- Integral supervised microphone
- Microphone time-out feature which reverts back to pre-recorded message if emergency page exceeds the programmed time
- 14 recorded messages
- Field-selectable message and custom message recording capability using the local microphone, a USB port, or an external audio input
- External Audio Input can be used for background music
- Up to 60 second message duration for all messages
- Integral tone generators field selectable for multiple tone types
- Powered by integral AC power supply or batteries during AC fail
- Programmable delay of immediate, 2 hours or 6 hours reporting of AC Loss
- Piezo sounder for local trouble
- 100 event history log
- Three Form-C relays:
 - AC Power Loss Relay - TB1
 - System Trouble Relay - TB2
 - MNS Active - TB3
- 500mA (0.5A) Special Application (auxiliary power) output for addressable modules when interfaced with compatible addressable FACP's and End-of-Line power supervision relays
- System Status LEDs (*Refer to "Controls and Indicators" in product manual LS10001-001NF-E.*)
- Integral Dress Panel
- Optional TR-CE-B semi-flush trim ring
- Any combination of up to eight (8) external remote consoles:
 - Optional NFC-RM Remote Microphone (includes cabinet) See DN-60778.
 - Optional NFC-RPU Remote Page Unit (includes cabinet) See DN-60775.
 - Optional NFC-LOC Local operator console (includes cabinet) See DN-60777.
- Any combination of up to eight (8) distributed audio amplifiers:
 - Optional NFC-50DA(E) distributed amplifier, 50 watts. See DN-60776.
 - Optional NFC-125DA(E) distributed amplifier, 125 watts. See DN-60776.
 - Optional NFC-50/100 distributed amplifier with backup capability, 50/100 watts. See DN-60776.

Optional Internal Expansion Modules

NFC-CE6: Circuit Expander Module provides connections for up to six Style Z (Class A) or Style Y (Class B) speaker circuits. Circuits are configured through the web-based programming utility.

NFC-BDA-25V: 25V, 50 watt audio amplifier module. Adding a second speaker circuit increases the total NFC-50/100 power output to 100 watts or can also be used as a backup amplifier.

NFC-BDA-70V: 70V, 50 watt audio amplifier module. Adding a second speaker circuit increases the total NFC-50/100 power output to 100 watts or can also be used as a backup amplifier.

NFC-XRM-70V: 70V Transformer Conversion Module. Converts the NFC-50/100(E) primary amplifier to a 70V output. This transformer mounts directly to the NFC-50/100(E) main control board by two metal brackets.

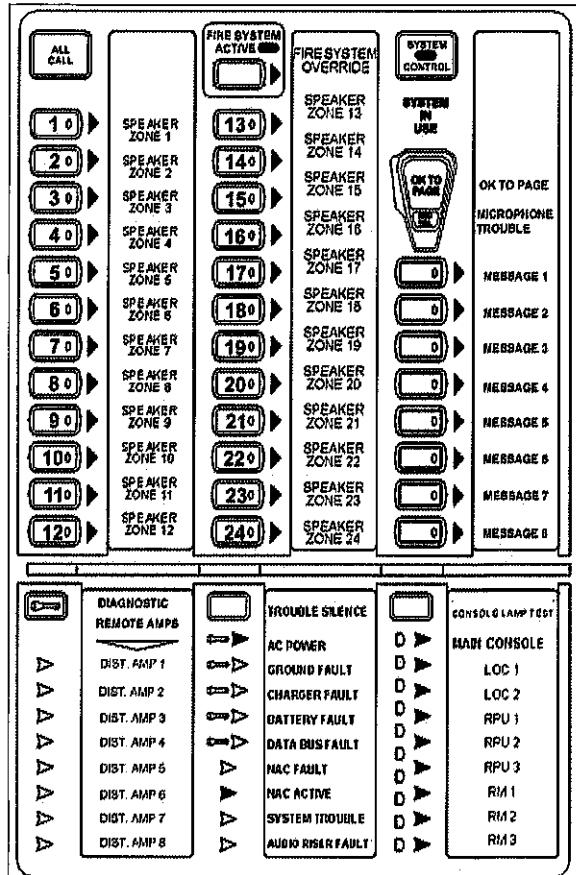

Control and Indicators

PUSH BUTTON CONTROLS

- All Call
- MNS Control
- System Control
- Speaker Select 1-24
- Message Select 1-14
- Diagnostic Select
- Trouble Silence
- Console Lamp Test

LED Status Indicators (visible with door closed)

| | |
|-------------------------------------|-------------------------------|
| Fire System Active (green) | LOC/RPU/RM 1-8 Active (green) |
| MNS Control (green) | Main Console Fault (yellow) |
| System Control (green) | AC Power (green) |
| System in Use (green) | Ground Fault (yellow) |
| Speaker Zone 1-24 Active (green) | Charger Fault (yellow) |
| Speaker Zone 1-24 Fault (yellow) | Battery Fault (yellow) |
| OK to Page (green) | Data Bus Fault (yellow) |
| Microphone Trouble (yellow) | NAC Fault (yellow) |
| Message 1-8 Active (red) | NAC Active (green) |
| Message 1-8 Fault (yellow) | System Trouble (yellow) |
| Remote Amplifier 1-8 Fault (yellow) | Audio Riser Fault (yellow) |
| LOC/RPU/RM 1-8 Fault (yellow) | |

LED Indicators (visible with door and dress panel open)

- Speaker Volume Control Fault (yellow).
- Option Card Fault (yellow).
- Amplifier Over Current Fault (yellow).

Product Line Information

NFC-50/100: (Primary Operating Console) 50 Watt, 25V single speaker zone emergency voice evacuation system, integral microphone, built in tone generator and 14 recordable messages.

NFC-50/100E: Export version (Primary Operating Console) 50 Watt, 25V single speaker zone emergency voice evacuation system, integral microphone, built in tone generator and 14 recordable messages. (240 VAC, 50Hz).

NFC-CE6: Speaker Circuit/Zone Expander Module.

NFC-BDA-25V: 25V, 50 watt audio amplifier module. Adding a second speaker circuit increases the total NFC-50/100 power output to 100 watts or can also be used as a backup amplifier.

NFC-BDA-70V: 70V, 50 watt audio amplifier module. Adding a second speaker circuit increases the total NFC-50/100 power output to 100 watts or can also be used as a backup amplifier.

NFC-XRM-70V: 70V Transformer Conversion Module. Converts the NFC-50/100(E) primary amplifier to a 70V output. This transformer mounts directly to the NFC-50/100(E) main control board by two metal brackets.

NFC-LOC: Local Operator Console (Complete user interface). *Please refer to the data sheet DN-60777 for more information.*

NFC-RPU: Remote Page Unit Hand held microphone, 14 message buttons. *Please refer to the data sheet DN-60775 for more information.*

NFC-RM: Remote Microphone only. *Please refer to the data sheet DN-60778 for more information.*

NFC-50DA: Distributed (Remote) Audio Amplifier, 50 watts. *Please refer to the data sheet DN-60776 for more information.*

NFC-50DAE: Export version. Distributed (Remote) Audio Amplifier, 50 watts. (240 VAC, 50Hz). *Please refer to the data sheet DN-60776 for more information.*

NFC-125DA: Distributed (Remote) Audio Amplifier, 125 watts. *Please refer to the data sheet DN-60776 for more information.*

NFC-125DAE: Export version. Distributed (Remote) Audio Amplifier, 125 watts. (240 VAC, 50Hz). *Please refer to the data sheet DN-60776 for more information.*

NFC-50/100DA: Distributed (Remote) Audio Amplifier with back up, 50 watts/100 watts at 25Vrms or 70Vrms. *Please refer to the data sheet DN-60776 for more information.*

NFC-50/100DAE: Export version. Distributed (Remote) Audio Amplifier with back up, 50 watts/100 watts (240 VAC, 50Hz). *Please refer to the data sheet DN-60776 for more information.*

NFC-BDA-BU: Expander card for ECC-50BDA remote amplifier for 100 watt primary / 50 watt back up operation. *Please refer to the data sheet DN-60776 for more information.*

NFC-CE4: Distributed Audio Speaker Circuit/Zone expander module.

NFC-FFT: Fire Fighter Telephone System. *Please refer to the data sheet DN-60779 for more information.*

NFC-RTZM: Remote Telephone Zone Module. Allows for secure access to the NFC via cell phone or remote telephone means; not UL listed. *Please refer to the data sheet DN-60818 for more information.*

SEISKIT-COMMENC: Seismic kit for the NFC-50/100. Includes battery bracket for two 12 AH or 18 AH batteries.

N-FPJ: Remote Phone Jack.

FHS-F: Fire Fighters Remote Handset.

FHSC-R: Fire Fighters Handset Cabinet Recessed.

FHSC-S: Fire Fighters Handset Cabinet Surface Mount

TR-CE-B: Optional Trim Ring.

THUMBLTCH: Optional Thumb Latch. (Non UL-Listed).

CHG-75: 25 to 75 ampere-hours (AH) External Battery Charger.

CHG-120: 25-120 ampere-hours (AH) External Battery Charger.

ECC-MICROPHONE: Replacement Microphone only.

BAT-1270: Battery, 12 volt, 7.0 AH (Two required).

BAT-12120: Battery, 12 volt, 12.0 AH (Two required).

BAT-12180: Battery, 12 volt, 18.0 AH (Two required).

BAT-12260: Battery, 12 volt, 26.0 AH (Two required).

BB-26: Battery cabinet mounts up to two 26 AH batteries.

Wiring Requirements

See product manual, part number LS10001-001NF-E for detailed wiring requirements.

Total System Capacity: (NFC-50/100(E) only)

- Total Built-in Audio Power: 50 Watts.
- Total Expandable Audio Power: 100 Watts.
- Total Built-in Speaker Circuits: 2.
- Total Expandable Speaker Circuits: 8.
- Audio Message Max Time Duration: 60 seconds.
- External Audio Input: 1.

Total System Capacity: (Fully Loaded System)

- Total Distributed Audio Power: 1100 Watts.
- Total Speaker Circuits Per System: 24.
- Total Remote Consoles Supported: 8.
- Total Distributed Audio Amplifiers Supported: 8.

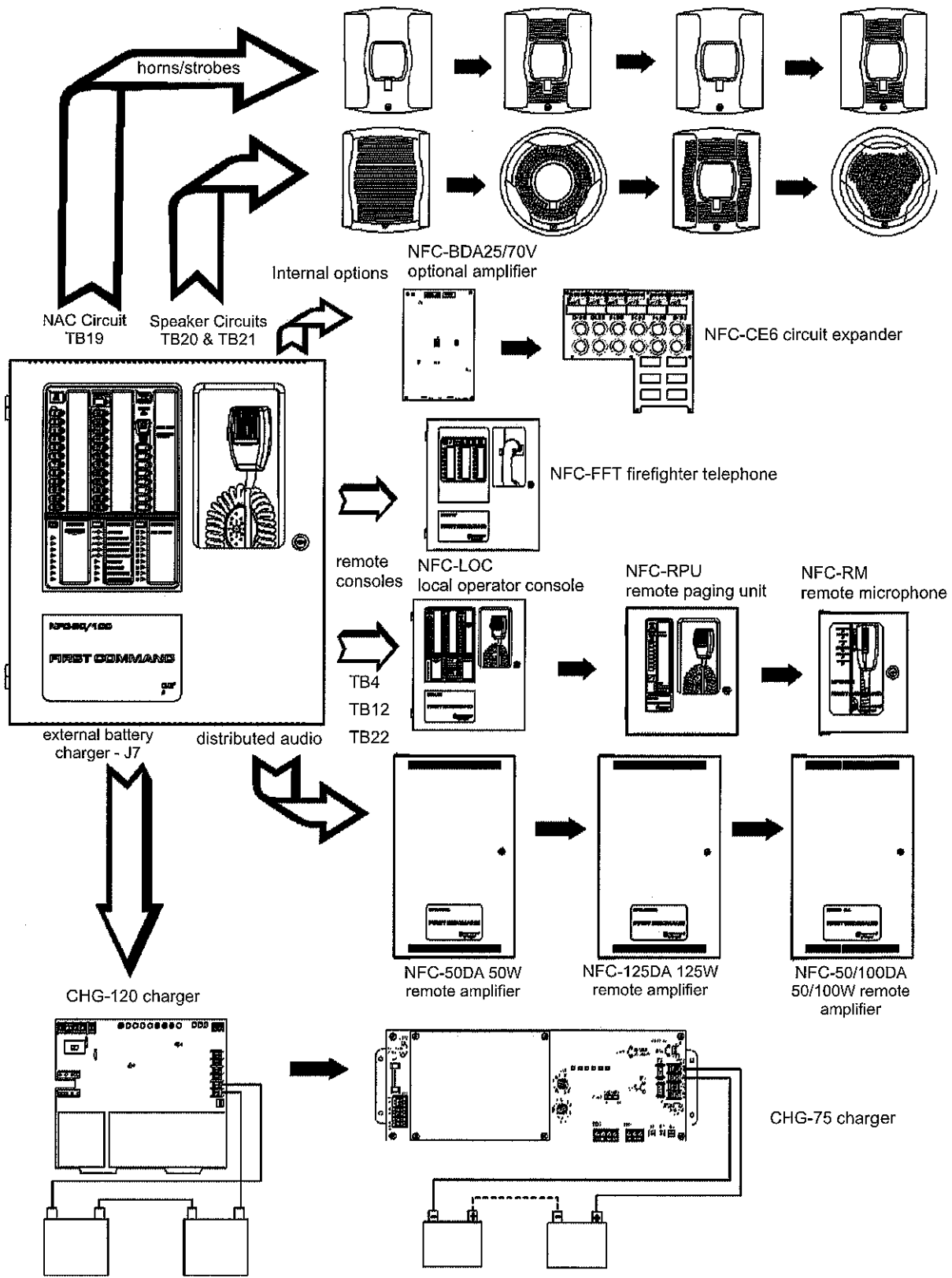

NFC-50/100(E) FirstCommand (Possible Configurations)

Electrical Specifications

PRIMARY (AC) POWER (TB15)

NFC-50/100: 120 VAC, 60 Hz, 3.5 amps.

NFC-50/100E: 240 VAC, 50 Hz, 2.0 amps.

Wire size: minimum #14 AWG (2.00mm²) with 600 V insulation.

SECONDARY POWER (BATTERY) CHARGING CIRCUIT (J7)

- Supports lead-acid batteries only.
- Float charge voltage at 27.3V
- Maximum charge current: 1.0 Amp
- Maximum battery charge capability: 2.8 Amps, 26AH (NFC cabinet holds max. 18AH battery).
- Minimum Battery size: 12 Amp Hour.

AC LOSS RELAY CONTACT RATING (TB3)

- 2.0 amps @ 30 VDC (resistive), 0.5 amps @ 30 VAC (resistive).

FORM C - TROUBLE RELAY CONTACT RATING (TB2)

- 2.0 amps @ 30 VDC (resistive), 0.5 amp @ 30 VAC (resistive).

MNS ACTIVE RELAY CONTACT RATING (TB1)

- 2.0 amps @ 30 VDC (resistive), 0.5 amps @ 30 VAC (resistive).

NOTIFICATION APPLIANCE CIRCUIT (NAC) OUTPUT RATING (TB19)

- One (1) Style Y (Class B) or Style Z (Class A) circuit.
- Power-limited circuitry, (Class 2) supervised.
- Nominal operating voltage: 24 VDC.
- Maximum signaling current for special application power: 2.0A.
- Maximum signaling current for regulated power: 200mA.
- Maximum wiring impedance: 1Ω.
- Current limit: fuse-less, electronic, power-limited.
- End-Of-Line Resistor: 4.7 KΩ, ½ watt, (P/N 71252) required for Style Y (Class B) operation.

Refer to the Device Compatibility Document 15378 for listed compatible devices.

NAC FOLLOWER OUTPUT REMOTE SYNC (TB18)

- Connections for FACP NAC synchronization trigger signal.
- Output terminals: pass-through to other system components.
- Trigger input voltage: 9 to 32 VDC, 24 VDC rated.
- Input current draw in Alarm condition: 10 mA at rated voltage.

SPECIAL APPLICATION POWER (AUX. POWER) (TB17)

- 500 mA @ 24 VDC.
- Used for powering addressable modules and associated End-of-Line power supervision relays.

Power-limited circuitry. Refer to the Device Compatibility Document 15378 for a list of compatible devices.

SPEAKER VOLUME CONTROL OVERRIDE (TB23)

- Style Y (Class B) or Style Z (Class A) circuit.
- Special application power.
- Power-limited circuitry, supervised.
- Nominal operating voltage: 24 VDC.
- Maximum signaling current: 0.25 amps.
- Current limit: fuse-less, electronic, power-limited.

- End-Of-Line Resistor: 4.7 KΩ, ½ watt, (P/N 71252) required for Style Y (Class B) operation.

Speaker Circuits

- Primary Speaker Circuit (TB20)
- Secondary Speaker Circuit (TB21) (with optional amplifier only).
 - Circuit can be wired Style Y (Class B) or Style Z (Class A).
 - Power-limited circuitry.
 - Normal Operating Voltage: 25 VRMS @ 2 amps max and maximum Load Impedance of 12.5Ω (70V @ 700 mA max. with maximum load Impedance of 100Ω operation possible by plugging optional NFC-XRM-70V conversion transformer into J12 of the main control board).
 - Output Power: 50 watts (10 watts when background music is employed).
 - Frequency Range: 400Hz - 4,000Hz.
 - Maximum total capacitance for each speaker circuit: 250 μF.
 - End-of-Line Resistor required for Style Y circuit: 15 KΩ, 1 watt (P/N: ELR-15K).

Command Input Circuits (alarm polarities shown)

CMD1 - TB4 Terminals 3(+) & 4(-) are input terminals and Terminals 1(-) and 2(+) are output terminals which provide feed through of the NAC circuits to NAC devices down stream.

CMD2 - TB5 Terminals 3(+) & 4(-) are input terminals and Terminals 1(-) and 2(+) are output terminals which provide feed through of the NAC circuits to NAC devices downstream.

CMD3 - TB6 Terminals 1(+) & 2(-) are input terminals for contact closure only.

CMD4 - TB6 Terminals 3(+) & 4(-) are input terminals for contact closure only.

CMD5 - TB7 Terminals 1(+) & 2(-) are input terminals for contact closure only.

CMD6 - TB7 Terminals 3(+) & 4(-) are input terminals for contact closure only.

CMD7 - TB8 Terminals 1(+) & 2(-) are input terminals for contact closure only.

CMD8 - TB8 Terminals 3(+) & 4(-) are input terminals for contact closure only.

- Power-limited and supervised circuitry.
- Normal Operating Voltage Range: 10.5 VDC - 29 VDC; (Maximum Voltage: 29 VDC).
- NAC Reverse Polarity Current (requires End-of-Line Resistor from NAC): 1.6 mA maximum.
- Contact Closure Operation Current (requires 4.7KΩ, ½ watt End-of-Line Resistor P/N 27072): 6.6 mA maximum.
- Maximum Wiring Impedance CMD1 - CMD8 (Contact Closure Operation): 200Ω.

NOTE: When the system is programmed for Mass Notification, CMD1 and CMD2 will be programmed for Reverse Polarity only. See manual P/N LS10001-001NF-E for more details.

MAXIMUM INPUT IMPEDANCE:

- CMD1 & CMD2 (Reverse Polarity Operation): 20KΩ.
- CMD1 - CMD8 (Contact Closure Operation): 4.75KΩ.

NIGHT RING INPUT - TB16, TERMINALS 1 (+) & 2 (-)

- Contact closure input.
- Isolated, non-supervised.
- Operation current: 3.8 mA, maximum.

- Maximum wiring impedance: 30K Ω .
- Minimum isolation withstand voltage: 1500 VRMS.

EXTERNAL OPERATOR INTERFACE POWER OUTPUT (TB24)

- Non-resettable power for external operator interface components.
- Power-limited circuitry, non-supervised.
- Nominal operating voltage: 24 VDC.
- Maximum output current: 0.80 amps.
- Current limit: fuse-less, electronic, power-limited circuit.

EXTERNAL DATA BUS (EIA-485) (TB12)

- Data connections for external operator interface components.
- Redundant transceiver circuitry for Class A operability.
- Power-limited circuitry, supervised.
- Maximum wiring impedance: 13.2 Ω

FACP DATA BUS (EIA-485) (TB13)

- Dedicated connection to FACP serial bus.
- Output terminals: pass-through to other system components.
- Isolated, supervised.
- Minimum isolation withstand voltage: 1500 VRMS.
- Maximum wiring impedance: 40 Ω (ANN-BUS), 26 Ω (ACS-BUS).
- External Audio Riser (TB22).
- Style Y (Class B) or Style Z (Class A) audio connections to external operator interface components.
- Power-limited circuitry, supervised.
- Audio signal level: 3.85 V, maximum.
- Frequency range: 400 Hz - 4 KHz RMS.
- Frequency range (NFC-50/125DA): 800Hz - 2KHz RMS.

EXTERNAL AUDIO INPUT (TB5)

- Input Impedance: 8.5K Ω nominal @1KHz
- Input Voltage: 700 mV rms maximum
- Input Current: 0.1 mA maximum @ 700 mV

NOTE: Some laptops/personal computers only provide an audio output for headphones. It may be necessary to adjust the headphone output level for proper recording of voice messages.

NFC-CE6 Circuit Expander Module Specifications

- Power-limited circuitry.
- Up to six (6) circuits on the NFC-CE6 can be wired as Style Y (Class B) or Style Z (Class A).
- Normal Operating Voltage for Speaker Circuits: 25 V@ 2.0 amps max. (Maximum Load Impedance of 12.5 Ω).
- 70.0 V @ 700 mA max. with maximum Load Impedance of 100 Ω operation possible for the primary circuit by plugging in an optional NFC-XRM-70V conversion transformer into J12 of the main control board. The same operation is possible for the optional 50W amplifier by selecting the NFC-BDA-70V model.
- Speaker circuit wiring is supervised during standby, background music, and alarm.

- Output Power: 50 watts total; Frequency Range: 400Hz - 4,000Hz.
- Maximum total capacitance: 250 μ F. (Note that the total capacitance for the speaker outputs must not exceed the maximum of 250 μ F).
- End-of-Line Resistor required for Style Y (Class B) speaker circuit: 15 K Ω , 1 watt (P/N: ELR-15K) TB13 on the main control board: ACS/ANN (EIA-485) electrically isolated link to FACP provides programmed speaker control.

Cabinet Specifications

- Backbox: 19.0"(48.26 cm) high x 16.65"(42.29 cm) wide x 5.20"(13.23 cm) deep.
- Door: 19.26" (48.92 cm) high x 16.82"(42.73 cm) wide x 0.12"(0.30 cm) deep.
- Trim Ring (TR-CE-B): 22.00" (55.88 cm) high x 19.65" (49.91 cm) wide.

Shipping Specifications

Base Unit Weight: 27.85 lbs (12.63 kg).

Temperature and Humidity ranges

This system meets NFPA requirements for operation at 0-49 $^{\circ}$ C/32-120 $^{\circ}$ F and at a relative humidity 93% \pm 2% RH (non-condensing) at 32 $^{\circ}$ C \pm 2 $^{\circ}$ C (90 $^{\circ}$ F \pm 3 $^{\circ}$ F). However, the useful life of the system's standby batteries and the electronic components may be adversely affected by extreme temperature ranges and humidity. Therefore, it is recommended that this system and its peripherals be installed in an environment with a normal room temperature of 15-27 $^{\circ}$ C/60-80 $^{\circ}$ F.

Agency Listings and Approvals

The listings and approvals below apply to the basic NFC-50/100(E) control panel. In some cases, certain modules may not be listed by certain approval agencies or listing may be in process. Consult factory for latest listing status.

- UL/ULC Listed S635.
- Compliant with UFC 4-021-01.
- CSFM: 6911-0028:0265.
- NYC Fire Dept. Certificate of Approval: #6163

Standards and Codes

The NFC-50/100(E) complies with the following UL Standards, NFPA 72, International Building Codes, and California Building Codes.

- UL 864.
- UL 2572.
- IBC 2012, IBC 2009, IBC 2006, IBC 2003, IBC 2000 (Seismic).
- CBC 2007 (Seismic)

First Command[®] and Notifier[®] are registered trademarks of Honeywell International Inc.
 ©2015 by Honeywell International Inc. All rights reserved. Unauthorized use of this document is strictly prohibited.



This document is not intended to be used for installation purposes.
 We try to keep our product information up-to-date and accurate.
 We cannot cover all specific applications or anticipate all requirements.
 All specifications are subject to change without notice.



Made in the U.S.A.

For more information, contact Notifier. Phone: (203) 484-7161, FAX: (203) 484-7118.
www.notifier.com